

I, JACKIE W. BRIM, CERTIFY THAT THIS PLAT WAS PREPARED UNDER MY SUPERVISION AND THAT THE PLAT WAS PREPARED FOR THE PURPOSE OF ACQUISITION AND EASEMENTS ONLY, AND IS NOT INTENDED TO BE A BOUNDARY SURVEY OF PROPERTY SHOWN.

*Jackie W. Brim 6-17-2019*  
 JACKIE W. BRIM, NC P.L.S. L-4348 DATE

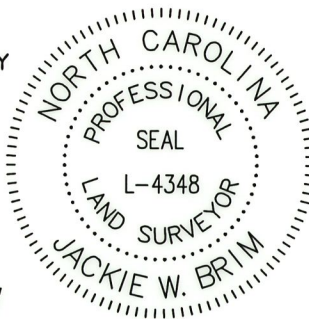

STATE OF NORTH CAROLINA  
 COUNTY OF MECKLENBURG

I, \_\_\_\_\_, REVIEW OFFICER OF MECKLENBURG COUNTY, CERTIFY THAT THE MAP OR PLAT TO WHICH THIS CERTIFICATION IS AFFIXED MEETS ALL STATUTORY REQUIREMENTS FOR RECORDING.

REVIEW OFFICER \_\_\_\_\_ DATE \_\_\_\_\_

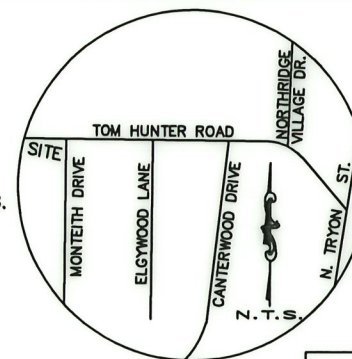

**TOM HUNTER ROAD  
 RIGHT-OF-WAY VARIES**

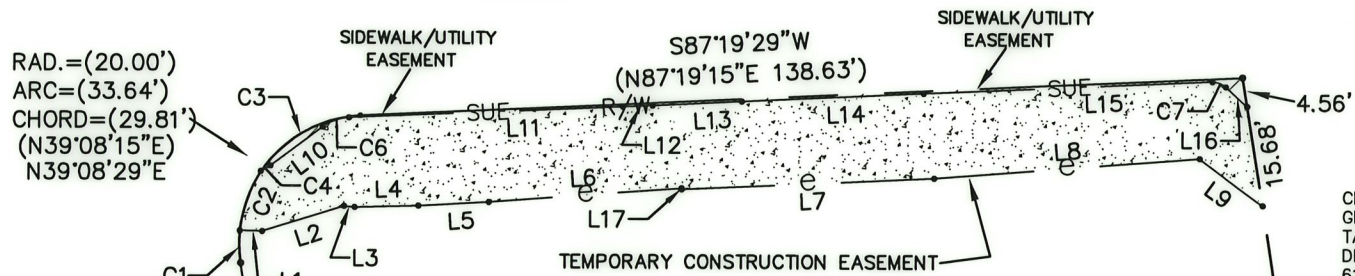

RAD.=(20.00')  
 ARC=(33.64')  
 CHORD=(29.81')  
 (N39°08'15"E)  
 N39°08'29"E

(23)

CHARLES A. EMINA  
 GLENDA F. EMINA  
 TAX PARCEL: 089-181-07  
 DB 29073 PG 298  
 617 TOM HUNTER ROAD

Curve Table				
Curve #	Length	Radius	CHORD BEARING	CHORD
C1	5.08	20.00	S1°45'52"E	5.07
C2	9.97	20.00	S19°47'34"W	9.87
C3	18.59	20.00	S60°41'54"W	17.93
C4	1.74	7.50	N60°02'45"E	1.73
C6	4.46	7.50	N70°27'26"E	4.40
C7	2.36	3.00	S70°04'29"E	2.30

Line Table		
Line #	Length	Direction
L1	3.59	S88°32'18"E
L2	13.48	N72°47'28"E
L3	1.67	S84°29'49"E
L4	9.99	N88°30'52"E
L5	11.02	N86°44'40"E
L6	30.48	N85°43'15"E
L7	39.66	N87°19'35"E
L8	41.76	N85°31'13"E
L9	12.26	S53°30'43"E
L10	10.24	N53°24'15"E
L11	42.99	N87°30'37"E
L12	4.71	N87°58'53"E
L13	14.10	N87°05'25"E
L14	28.47	N87°18'46"E
L15	45.35	N87°25'08"E
L16	4.51	S47°34'06"E
L17	0.18	S05°11'03"E

(22)

NOW OR FORMERLY  
 EVINGERLEAN J. BLAKNEY  
 TAX PARCEL: 089-181-08  
 DB 4012 PG 494  
 6722 MONTEITH DRIVE

#4rebar  
 COMBINED GRID  
 FACTOR=0.99983997  
 N.561,015.43  
 E.1,470,076.12

NOTES:

- BEARINGS AND DISTANCES SHOWN IN PARENTHESES ARE BASED ON MAP BOOK 14 PAGE 291
- COMPUTED PROJECT DISTANCE \_\_\_\_\_\*
- TOTAL AREA 15,261 SQ.FT.
- TEMPORARY CONSTRUCTION EASEMENT 2,080 SQ.FT.
- SIDEWALK/UTILITY EASEMENT 74 SQ.FT.
- AREA REMAINING 15,261 SQ.FT.

NC GRID NAD 83(2011)  
**MONTEITH DRIVE  
 60' RIGHT-OF-WAY**

PREPARED BY:  
 CITY OF CHARLOTTE  
 ENGINEERING & PROPERTY  
 MANAGEMENT DEPT.  
 600 EAST FOURTH STREET  
 CHARLOTTE, NC 28202  
 704-336-2291

\*tie line\*  
 S9°02'31"E  
 160.00'



ETHEL M. MCMURRAY  
 TAX PARCEL: 089-181-09  
 DB 7936 PG 652  
 6714 MONTEITH DRIVE

LEGEND

- IRON PIN FOUND
- CALCULATED POINT
- EXISTING R/W LINE
- LINES SURVEYED
- LINES NOT SURVEYED
- TEMP. CONSTRUCTION EASEMENT (e)
- SIDEWALK/UTILITY EASEMENT (SUE)

**CHARLOTTE**  
 ENGINEERING & PROPERTY MANAGEMENT DEPT.

REVISIONS	TOM HUNTER ROAD STREETSCAPE	JOB NO. 512-15-022
		215022
PROPERTY OF EVINGERLEAN J. BLAKNEY TAX CODE: 089-181-08		SHEET 1
DRAWN BY G.F. CHARLOTTE, MECKLENBURG CO., NC		OF 1
DATE	CHECKED BY JWB	SURVEY SUPVR.

K: \AutoCad\En\_su-LD4\215022\PLAT MAPS 01-17-19\ Plat Map-22

DB 33959-197