

LEGEND

- IRON PIN FOUND
- IRON PIN SET
- TEMPORARY CONSTRUCTION EASEMENT
- LINE SURVEYED
- LINE NOT SURVEYED
- UTILITY EASEMENT
- AREA ACQUIRED

L1	2.00'	N50° 43'22"E
L2	3.24'	S39° 18'18"E
L3	2.03'	S60° 59'04"W
L4	2.88'	N39° 18'42"W
L5	2.00'	N28° 16'53"E
L6	10.20'	S61° 42'22"E
L7	2.38'	S60° 59'04"W
L8	8.91'	N61° 42'25"W
L9	6.06'	N03° 48'21"W
L10	10.52'	S23° 05'16"E
L11	2.00'	S66° 55'18"W
L12	4.80'	N23° 05'09"W
L13	6.68'	S12° 33'50"W
L14	6.42'	S12° 33'50"W
L15	14.80'	S12° 33'55"W
L16	52.60'	S40° 31'43"W
L17	9.43'	S40° 31'34"W
L18	15.99'	N22° 54'45"E
L19	38.84'	N03° 48'11"W
L20	43.71'	N70° 47'50"E
L21	23.44'	S60° 59'04"W
L22	23.61'	S43° 49'10"W
L23	26.02'	S01° 13'27"W

RECORDED IN DEED BOOK

**17657-150**  
**08-24-2004**

**ANDERSON ST. (50' RIGHT OF WAY)**

449.79'

(476.45') (S16° 05'00"E)

SEE INSET A

State of North Carolina  
County of Mecklenburg  
I, County Clerk, certify that the map or plat to which this certification is affixed meets all statutory requirements for recording.  
Review Officer \_\_\_\_\_ Date \_\_\_\_\_

**(21)**

TP\* 091-098-01  
CHARLOTTE MECKLENBURG BOARD  
OF EDUCATION  
DB 2152 PG 303  
3501 THE PLAZA

OAKWOOD AVE.

(352.94') (N76° 16'00"E)

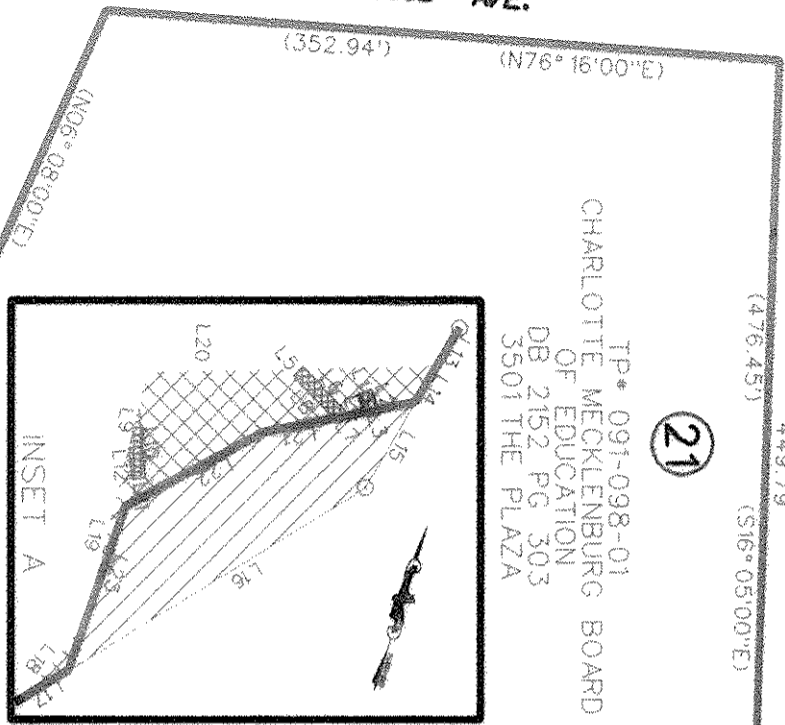

ACADEMY ST.

(372.35')

ACADEMY ST. (60' RIGHT OF WAY)

(N44° 08'30"W) 383.71'

(429.45') (N16° 48'21"W) 27.62'

(60' RIGHT OF WAY)

(S40° 29'50"W) 45.03'

(N45° 11'05"W) 12.29'

NOTES:

- 1) BEARINGS AND DISTANCES SHOWN IN PARENTHESES ARE BASED ON RECORDED DEED AND MAP INFORMATION.
- 2) TOTAL AREA 233,001 SQ FT (5.345 ACRES)
- 3) TEMPORARY CONSTRUCTION EASEMENT (T.C.E.) 510.91 SQ FT (0.011 ACRE)
- 4) UTILITY EASEMENT 41 SQ FT (0.001 ACRE)
- 5) AREA ACQUIRED 735.63 SQ FT (0.0168 ACRE)
- 6) AREA REMAINING 232,266 SQ FT (5.33 ACRES)

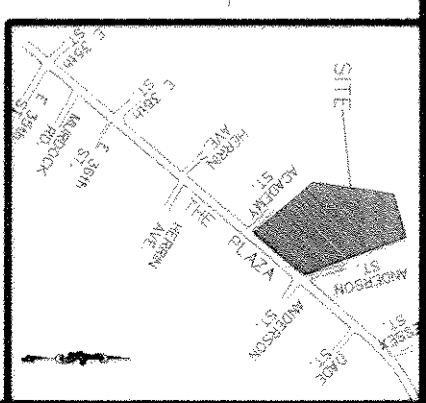

PREPARED BY:  
NOVA ENGINEERING & SURVEYING, INC.  
ENGINEERING DEPARTMENT  
600 TOWNE CENTRE BLVD, SUITE 405  
CHARLOTTE, NC 28134  
704-889-5816

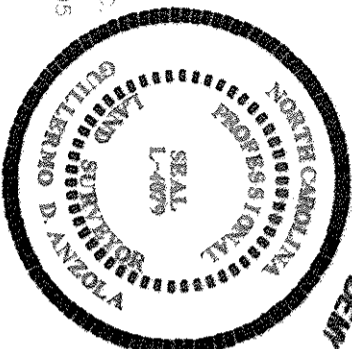

I, GUILLERMO D. ANZOLA, CERTIFY THAT THIS PLAT WAS PREPARED UNDER MY SUPERVISION AND THAT THE PLAT WAS PREPARED FOR THE PURPOSE OF ACQUISITION AND EASEMENTS ONLY, AND IS NOT INTENDED TO BE A BOUNDARY SURVEY OF PROPERTY SHOWN.

SIGNED \_\_\_\_\_ DATE **Feb. 4, 2004**  
GUILLERMO D. ANZOLA PLS L-4079

		CHARLOTTE ENGINEERING AND PROPERTY MANAGEMENT	
PROPERTY OF CHARLOTTE MECKLENBURG BOARD OF EDUCATION LOT 21 3501 THE PLAZA	JOB NO. 2405	DATE 01-29-2004	PROJECT THE PLAZA IMPROVEMENT PROJECT PROJ NUM. 512-00-078
SCALE 1" = 100' DRAWN BY: GDA	DATE	DATE	SURVEY SIGNATURE