

State of North Carolina
County of Mecklenburg

I, _____, Review Officer of Mecklenburg County, certify that the map or plot to which this certification is affixed meets all statutory requirements for recording.

Review Officer _____ Date _____

- 1) BEARINGS AND DISTANCES SHOWN IN PARENTHESES ARE BASED ON RECORDED MAP INFORMATION.
- 2) TOTAL AREA 11,829 SQ.FT.
- 3) TEMPORARY CONSTRUCTION EASEMENT 788 SQ.FT.
- 4) SIDEWALK / UTILITY EASEMENT 82 SQ.FT.
- 5) UTILITY EASEMENT 24 SQ.FT.
- 6) AREA REMAINING 11,829 SQ.FT.

I, DAVID H. SNIDER, CERTIFY THAT THIS PLAT WAS PREPARED UNDER MY SUPERVISION AND THAT THE PLAT WAS PREPARED FOR THE PURPOSE OF ACQUISITION AND EASEMENTS ONLY, AND IS NOT INTENDED TO BE A BOUNDARY SURVEY OF PROPERTY SHOWN.

David H. Snider 11/3/09
DAVID H. SNIDER, NC P.L.S. L-2942 DATE

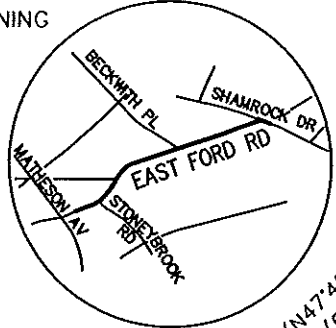
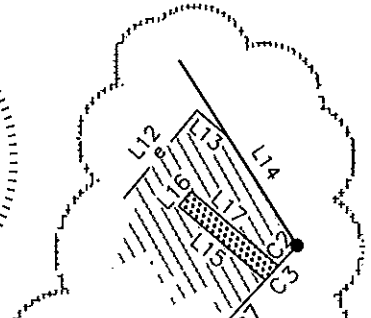

LINE	LENGTH	BEARING
L1	39.11'	S28°51'10"W
L2	14.61'	S28°51'10"W
L3	2.53'	N42°28'45"W
L4	6.97'	N42°28'45"W
L5	12.36'	N35°00'33"E
L6	15.59'	N60°41'49"W
L7	15.94'	N29°18'11"E
L8	17.19'	S60°41'49"E
L9	23.52'	N35°00'33"E
L10	41.07'	N37°46'55"E
L11	15.03'	N50°11'32"W
L12	12.00'	N39°48'28"E
L13	4.14'	S50°11'32"E
L14	13.69'	S33°08'01"E
L15	12.02'	N50°11'32"W
L16	2.00'	N39°48'28"E
L17	12.16'	S50°11'32"E
L18	30.38'	N29°18'11"E

VICINITY MAP not to scale

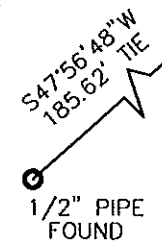

093-105-04
**BRIAN L. PATTERSON AND WIFE,
JENNIFER D. PATTERSON**
DB 21032-164
3111 E. FORD RD.

093-105-03
KEVIN C. BINKLEY
DB 22817-109 3019
E. FORD RD.

NAD 83 (1986)
GRID COORDINATE
N 544984.74 FT
E 1464214.73 FT
CF: 0.999837214
ℓ -L- 104+46.88
23.28' LEFT

093-105-05
EVELYN G. COULTER
DB 7887-919 3121
E. FORD RD.

CURVE	LENGTH	RADIUS	CHORD DIRECTION	CHORD
C1	49.52'	182.46'	S36°33'09"W	49.37'
(C1)	49.52'	182.46'	S37°55'09"W	49.37'
C2	1.03'	182.46'	S44°09'57"W	1.03'
C3	2.00'	182.46'	S43°41'21"W	2.00'
C4	46.49'	182.46'	S36°04'33"W	46.36'
C5	8.30'	16.00'	S44°08'22"W	8.19'

LEGEND

- IRON PIN FOUND
- CALCULATED POINT
- TEMPORARY CONSTRUCTION EASEMENT
- SIDEWALK / UTILITY EASEMENT (SUE)
- UTILITY EASEMENT

- LINES SURVEYED
- LINES NOT SURVEYED

PREPARED BY:
CITY OF CHARLOTTE
ENGINEERING DEPARTMENT
600 EAST FOURTH STREET
CHARLOTTE, NC 28202
704-336-2291

CHARLOTTE ENGINEERING & PROPERTY MANAGEMENT		
REVISIONS	E. FORD ROAD SIDEWALK PROJECT	JOB NO. 512-08-084
		FILE NO. 093-105-04
SCALE 1"=40'	OWNERS: BRIAN L. PATTERSON AND WIFE, JENNIFER D. PATTERSON TAX CODE: 093-105-04	SHEET 1
DRAWN BY CEM / JPG		CHARLOTTE, MECKLENBURG CO., NC
DATE	CHECKED BY GI SURVEY SUPVR. <i>SNL</i>	

ACQUISITION BY DB 26406 PG 811