

EASTWAY DRIVE

SEE SHEET 3 OF 12

THE PLAZA

IRON FOUND
IRON FOUND

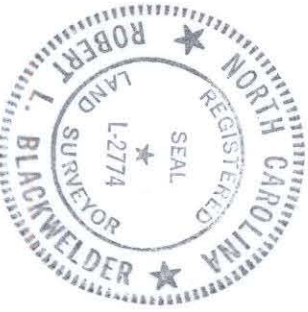

THIS PLAT WAS PREPARED UNDER MY SUPERVISION

Robert L. Blackwelder

N.C. REG. SURVEYOR NO. #L-2774

EASTWOOD GOLF COURSE

NCNB, TRUSTEE MARY A. HEAFNER

D.B. 2323-305

099-024-24

TOTAL AREA = 4,801,009 S.F. = 110.216 AC. (BY DEED)
 AREA ACQUIRED = 2,799 S.F. = 0.064 AC.
 PERM. DRAIN. ESM'T. = 784 S.F. = 0.018 AC.
 PERM. UTIL. ESM'T. = 42 S.F. = 0.001 AC.
 AREA REMAINING = 4,798,210 S.F. = 110.152 AC.
 TEMP. CONST. ESM'T. = 13,948 S.F. = 0.320 AC.

(3)

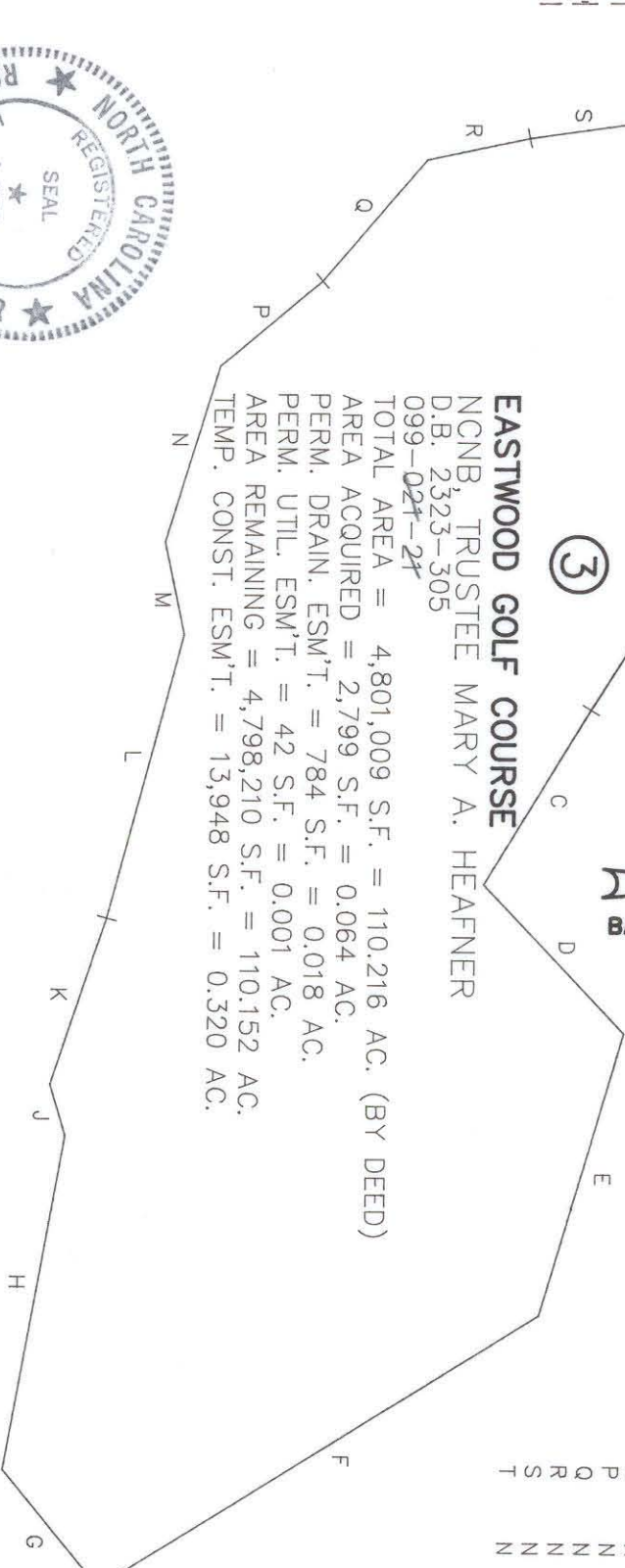

LINE	BEARING	DISTANCE	DEED BEARING	DEED DISTANCE
A	S 24°40'09" E	142.37	(S 29°08'00" E)	(365)
B	S 58°07'18" E	1100.86	(S 45°02'10" E)	(1100.86)
C	S 59°10'18" E	550.80	(S 46°05'10" E)	(550.80)
D	N 46°16'52" E	549.22	(N 59°22'00" E)	(549.22)
E	S 74°03'28" E	791.37	(S 60°58'20" E)	(791.37)
F	S 32°33'08" E	1387.25	(S 19°28'00" E)	(1387.25)
G	S 50°18'52" W	408.34	(S 63°24'00" W)	(408.34)
H	N 80°13'08" W	914.85	(N 67°08'00" W)	(914.85)
J	S 73°01'22" W	143.98	(S 86°06'30" W)	(143.98)
K	N 71°54'48" W	472.03	(N 58°49'40" W)	(472.03)
L	N 75°27'08" W	791.22	(N 62°22'00" W)	(791.22)
M	S 77°48'22" W	254.59	(N 89°06'30" W)	(254.59)
N	N 73°19'08" W	495.77	(N 60°14'00" W)	(495.77)
P	N 40°21'28" W	354.80	(N 27°16'20" W)	(354.8)
Q	N 50°03'08" W	431.20	(N 36°58'00" W)	(431.20)
R	N 12°20'08" W	279.70	(N 0°45'00" E)	(279.7)
S	N 8°41'08" W	278.10	(N 4°24'00" E)	(278.10)
T	S 52°4'58" W	446.15	(N 7°40'10" E)	(446.15)

NOTE:

PROPERTY CORNERS SHOWN AS OPEN CIRCLES WERE LOCATED BY ACTUAL SURVEY. BEARINGS AND DISTANCES SHOWN IN PARENTHESES ARE BASED ON DEED INFORMATION. BEARINGS ARE BASED ON XXX

THIS MAP WAS PREPARED FOR THE PURPOSE OF PROPERTY ACQUISITION ONLY, AND IS NOT INTENDED TO BE A BOUNDARY SURVEY OF THE TOTAL PROPERTY SHOWN.

<p>CHARLOTTE ENGINEERING DEPARTMENT</p>		<p>REVISIONS</p>	<p>JOB NO. 286-124</p>
		<p>EASTWAY DRIVE AT THE PLAZA INTERSECTION IMPROVEMENTS</p>	<p>FILE NO.</p>
<p>DRAWN BY E.P.S.</p>	<p>PROPERTY OF NCNB, MARY A. HEAFNER</p>	<p>SHEET 3A</p>	<p>OF 12</p>
<p>CHECKED BY RLB</p>	<p>DATE 2/5/90</p>	<p>SCALE 1" = 500'</p>	
<p>SURVEY SUPPL.</p>			

99-02. 21