

I, DAVID H. SNIDER, CERTIFY THAT THIS PLAT WAS PREPARED UNDER MY SUPERVISION AND THAT THE PLAT WAS PREPARED FOR THE PURPOSE OF ACQUISITION AND EASEMENTS ONLY, AND IS NOT INTENDED TO BE A BOUNDARY SURVEY OF PROPERTY SHOWN.

*David H. Snider* 8/10/11  
 DAVID H. SNIDER, NC P.L.S. L-2942 DATE  
 STATE OF NORTH CAROLINA  
 COUNTY OF MECKLENBURG

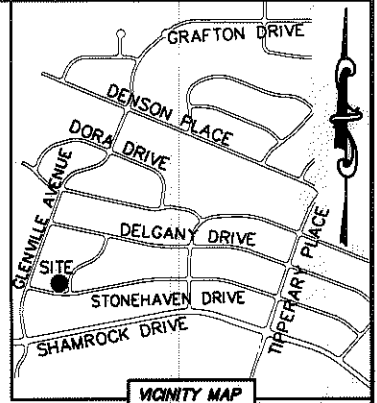
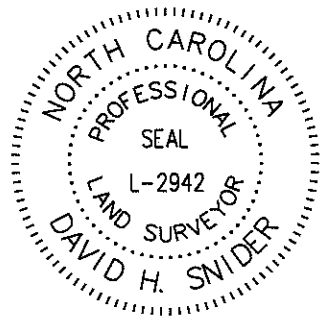

REVIEW OFFICER OF MECKLENBURG COUNTY, CERTIFY THAT THE MAP OR PLAT TO WHICH THIS CERTIFICATION IS AFFIXED MEETS ALL STATUTORY REQUIREMENTS FOR RECORDING.

REVIEW OFFICER \_\_\_\_\_ DATE \_\_\_\_\_

09912210  
 SIMCO DEVELOPMENT, LLC.  
 DB 23292/PG 493  
 3713 MCKELVEY STREET

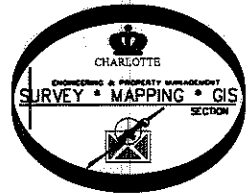

73  
 09912208  
 JORGE A. ROSALES  
 DB 18147/PG 604  
 3413 STONEHAVEN DRIVE

LINE TABLE		
LINE	LENGTH	BEARING
L1	8.54'	N 73°12'33" E
L2	12.89'	S 87°28'58" E
L3	6.01'	S 51°57'36" E

NOTE:

- 1) BEARINGS AND DISTANCE SHOWN IN PARENTHESIS ARE BASED ON RECORDED INFORMATION.
- 2) COMPUTED PROJECT DISTANCE - \*
- 3) TOTAL AREA 15,079 SQ.FT.
- 4) TEMPORARY CONSTRUCTION EASEMENT 1,060 SQ.FT.
- 5) SIDEWALK/UTILITY EASEMENT 190 SQ.FT.
- 6) TOTAL AREA REMAINING 15,079 SQ.FT.

74

09912209  
 RICHARD J. HOOVER AND  
 WIFE TERESA A. HOOVER  
 DB 25703/PG 49  
 3423 STONEHAVEN DRIVE

(N 08°33'30" E 133.24')  
 (N 08°24'42" E 133.73)\* (TOTAL)  
 124.16'

(R=223.12 L=57.38')  
 (R=223.12 L=57.38')  
 (S 03°45'10" W 57.22')

(R=223.12 L=57.38')  
 (S 03°37'08" E 36.69')  
 (S 03°28'20" W)

MCKELVEY STREET (50' PUBLIC R/W)

NC GRID NAD 83/2001 MRS

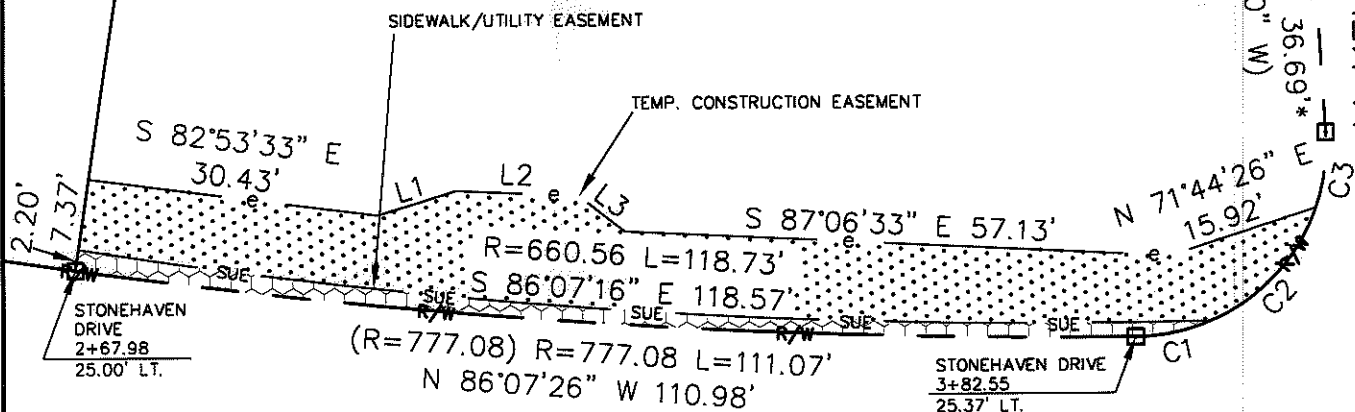

STONEHAVEN DRIVE  
 (50' PUBLIC R/W)

CURVE TABLE		
CURVE	RADIUS & ARC	CHORD
C1	R=20.00 L=8.13'	S 78°08'29" W 8.07'
C2	R=20.00 L=16.61'	S 42°42'19" W 16.14'
C3	R=20.00 L=7.86'	S 07°38'39" W 7.81'

LEGEND

- REBAR OR IRON PIN FOUND
- COMPUTED POINT
- PROPERTY LINES
- EXISTING RIGHT-OF-WAY
- SIDEWALK/UTILITY EASEMENT
- TEMP. CONSTRUCTION EASEMENT
- TEMP. CONSTRUCTION EASEMENT
- SIDEWALK/UTILITY EASEMENT

PREPARED BY:  
 CITY OF CHARLOTTE  
 ENGINEERING & PROPERTY MANAGEMENT  
 600 EAST FOURTH STREET  
 CHARLOTTE, NC 28202  
 704-336-2291

CHARLOTTE  
 ENGINEERING & PROPERTY MANAGEMENT

REVISIONS	FINCHLEY-PURSER/ SHAMROCK HILLS NIP	JOB NO. 512-08-051
		FILE NO. 099-122-09
SCALE 1"=20'	PROPERTY ACQUISITION OWNERS: RICHARD J. HOOVER AND WIFE TERESA A. HOOVER CHARLOTTE, MECKLENBURG CO., NC	SHEET 1
DRAWN BY LG		OF 1
DATE	CHECKED BY DHS	SURVEY SUPVR. <i>DHS</i>

K:\AUTOCAD\EN\_SU-LD4\208051\DWG\FINCHLEYPURSERSHAMROCKHILLSNIP PLATS.DWG