

SHARON AMITY ROAD

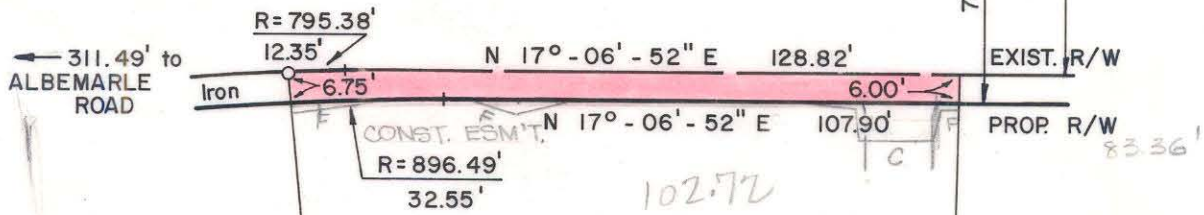

47

48

49

103-011-28
DEED 1228-186

Total Area 49,344 Sq. Ft.
Area Taken 852 Sq. Ft.
Area Remaining 48,492 Sq. Ft.

NOTE: Property corners shown circled were located by actual survey. Bearings are based on NORTH CAROLINA COORDINATE SYSTEM

This plat was prepared under my supervision *[Signature]*
N.C. Reg. Engineer No. 4343

ALBEMARLE ROAD
N 68° - 16' - 09" E 99.46'
N 25° - 43' - 05" W 134.84'

SEE MAP DATED 2-28-85

CITY OF CHARLOTTE NORTH CAROLINA DEPARTMENT OF PUBLIC WORKS ENGINEERING DIVISION		
REVISIONS METES & BOUNDS 12-21-74 SBC	PROPOSED R/W SHARON AMITY ROAD PROJECT NO. 513-72-212	JOB NO. FILE NO. RW-70
DRAWN BY SBC CHECKED BY JSS CITY ENGINEER	PARCEL NO. 48 DATE MAY 27, 1974 SCALE 1" = 40'	SHEET 48 OF 164

103-011-28/35