

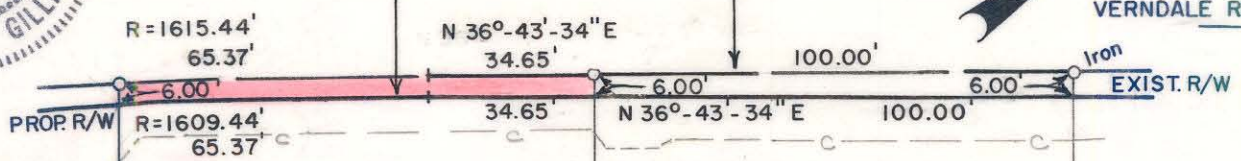

SHARON AMITY ROAD

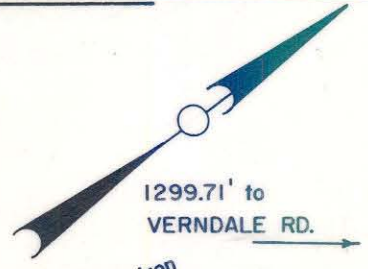

110

111

112

113

N 53°-16'-26" W 362.68'

103-071-13

DEED 1317-380
 Total Area 36,971 Sq. Ft.
 Area Taken 600 Sq. Ft.
 Area Remaining 36,371 Sq. Ft.

N 53°-16'-26" W 364.00'

103-071-12

DEED 1405-180
 Total Area 37,000 Sq. Ft.
 Area Taken 600 Sq. Ft.
 Area Remaining 36,400 Sq. Ft.

N 53°-16'-26" W 364.00'

R/W ACQUISITION BY CITY
 RECORDED IN DEED BOOK
3751-0678
 DATE 11-20-75

NOTE: Property corners shown circled were located by actual survey. Bearings are based on NORTH CAROLINA COORDINATE SYSTEM

This plat was prepared under my supervision K.G. Gillis
 N.C. Reg. Engineer No 4343

CITY OF CHARLOTTE NORTH CAROLINA DEPARTMENT OF PUBLIC WORKS ENGINEERING DIVISION		
REVISIONS	PROPOSED R/W SHARON AMITY ROAD PROJECT NO. 513-72-212	JOB NO.
	PARCEL NO. 111	FILE NO. RW-70
DRAWN BY CSC		SHEET 111
CHECKED BY JSS		OF 164
CITY ENGINEER	DATE JUNE 21, 1974	SCALE 1" = 40'

103-71-13