

**LEGEND**

- E— TEMP. CONSTRUCTION EASEMENT
- PDE— STORM DRAINAGE EASEMENT
- PUE— UTILITY EASEMENT
- SIDEWALK & UTILITY EASEMENT
- EXIST. PROPERTY LINE
- PROP. R/W
- EXIST. R/W
- [Dotted Box] TEMP. CONSTRUCTION EASEMENT
- [Cross-hatched Box] STORM DRAINAGE EASEMENT
- [Grid-hatched Box] SIDEWALK & UTILITY EASEMENT
- [Diagonal-hatched Box] PERMANENT UTILITY EASEMENT

STATE OF NORTH CAROLINA  
COUNTY OF MECKLENBURG

I, REVIEW OFFICER OF MECKLENBURG COUNTY, CERTIFY THAT THE MAP OR PLAT TO WHICH THIS CERTIFICATION IS AFFIXED MEETS ALL STATUTORY REQUIREMENTS FOR RECORDING.

I, J. David Lee II NCPLS L-4175, certify that this plat was drawn under my supervision from an actual survey made under my supervision, and was prepared for the purpose of Right-of-Way and/or Easement Acquisition only. And is not intended to be a boundary survey of property shown.

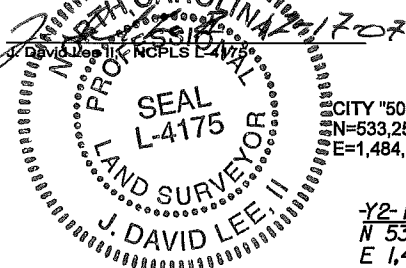

CITY "505"  
N=533,257.610(FT)  
E=1,484,380.080(FT)

-Y2- POT 12+00.00  
N 533,388.8082  
E 1,484,432.2302

**LINE TABLE**

	BEARING	DISTANCE		BEARING	DISTANCE
L1	S74°31'31"E	111.30'	L11	N06°14'54"E	221.20'
L2	S07°45'23"E	83.96'	L12	N83°46'21"W	187.50'
L3	S43°03'32"E	27.73'	L13	N83°46'21"W	187.50'
L4	S25°11'28"W	7.11'	L14	S83°45'06"E	10.00'
L5	S25°11'28"W	23.21'	L15	N06°14'54"E	200.00'
L6	S25°11'28"W	173.60'	L16	N83°45'06"W	60.00'
L7	S25°11'28"W	224.24'	L17	S74°31'31"E	31.81'
L8	S25°11'28"W	109.04'	L18	S88°50'38"W	31.24'
L9	N26°02'16"E	246.78'	L19	N01°25'20"W	27.02'
L10	N26°02'11"E	92.57'	L20	N88°52'39"E	16.00'

DORIS WALLACE PRICE & PATSY WALLACE ELMS  
PARCEL ID # 10325105  
DB 848 PG 234

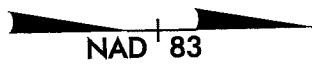
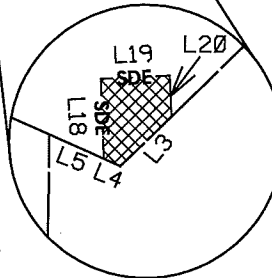
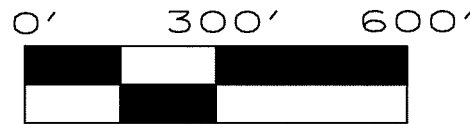

PRIMAX PROPERTIES LLC  
PARCEL ID # 10326103  
DB 17932 PG 775

JOHN HENRY THEILING  
PARCEL ID # 10326101  
DB 3342 PG 131

CHARLES F THEILING  
AND MACIE H THEILING  
PARCEL ID # 10326102  
DB 3342 PG 127

STORAGE TRUST PROPERTIES, LP  
PARCEL ID # 10325112  
DB 7990 PG 583

BETTY T. ALEXANDER  
PARCEL ID # 10325103  
DB 5373 PG 566

PATSY W. ELMS  
PARCEL ID # 10325104  
DB 19742 PG 162

DORIS W. PRICE  
PARCEL ID # 10325106  
DB 14619 PG 233

55 SPRING ST LLC AND REGENCY CEDARS LLC  
PARCEL ID # 10326109  
DB 20622 PG 439

NJM HOLDING CORP AND  
BUESTRIN ALLEN & ASSOC V AND  
LLC ENGLISH HILLS MANAGEMENT CO  
PARCEL ID # 10326104  
DB 16908 PG 735

ASSOCIATION, INC.  
WALLACE CREEK HOMEOWNERS  
PARCEL ID # 10326222  
DB 13173 PG 516

DORIS WALLACE PRICE  
PARCEL ID # 10325107  
DB 18802 PG 802

CHRIS DROSAS  
PARCEL ID # 10325111  
DB 1804 PG 609

**VICINITY MAP**

NTS

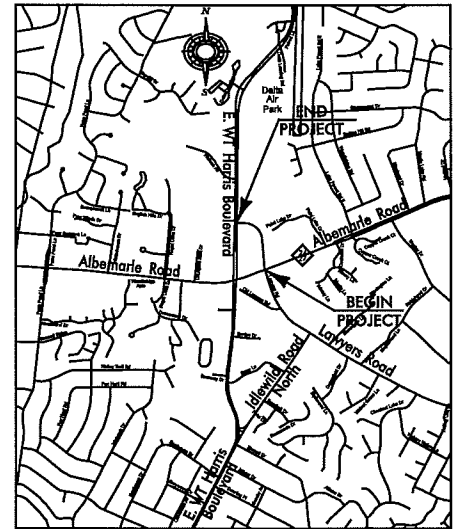

**NOTES:**

1. BEARINGS AND DISTANCES SHOWN IN PARENTHESES ARE BASED ON RECORDED MAP INFORMATION.
2. TOTAL AREA = 1,362,244.10 SQ. FT.
3. STORM DRAIN EASEMENT = 729.65 SQ.FT.
4. AREA REMAINING = 1,362,244.10 SQ. FT.

**MULKEY**  
ENGINEERS & CONSULTANTS  
7516 E. INDEPENDENCE BOULEVARD  
SUITE 100  
CHARLOTTE, NC 28227  
(704) 537-7300  
(704) 537-2811 (FAX)  
WWW.MULKEYINC.COM

REVISIONS		LAWYERS ROAD EXTENSION	JOB NO. 512-99-008
12/17/07	07/09/07		
SCALE 1" = 50'		PROPERTY ACQUISITION OWNER: 55 SPRING ST LLC AND REGENCY CEDARS LLC	SHEET 1
DRAWN BY: CKD			OF 1
DATE: 06/22/07		CHECKED BY: JDL II	SURVEY SUPVR.: JDL II