

I, DAVID H. SNIDER, CERTIFY THAT THIS PLAT WAS PREPARED UNDER MY SUPERVISION AND THAT THE PLAT WAS PREPARED FOR THE PURPOSE OF ACQUISITION AND EASEMENTS ONLY, AND IS NOT INTENDED TO BE A BOUNDARY SURVEY OF PROPERTY SHOWN.

David H. Snider 7/19/11
 DAVID H. SNIDER, NC P.L.S. L-2942 DATE

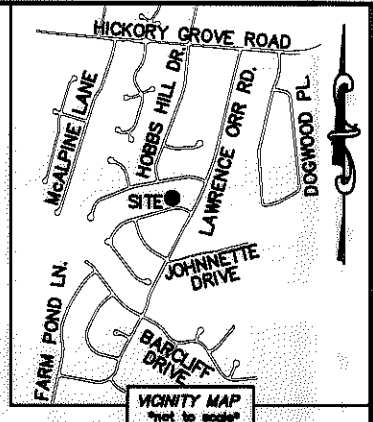
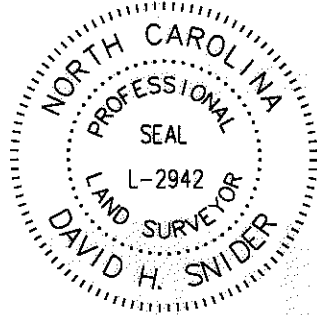

NOTE:

- 1) BEARINGS AND DISTANCE SHOWN IN PARENTHESIS ARE BASED ON RECORDED INFORMATION.
- 2) COMPUTED PROJECT DISTANCE -- *
- 3) TOTAL AREA 13,162 SQ.FT.
- 4) TEMP. CONSTRUCTION EASEMENT 471 SQ.FT.
- 5) PUBLIC STORM DRAINAGE EASEMENT 1,960 SQ.FT.
- 6) STORM DRAINAGE EASEMENT 79 SQ.FT.
- 7) TCE & WQB OVERLAP AREA 471 SQ.FT.
- 8) SDE & WQB OVERLAP AREA 79 SQ.FT.
- 9) SSE & PSDE OVERLAP AREA 319 SQ.FT.
- 10) SSE & SDE OVERLAP AREA 4 SQ.FT.
- 11) TOTAL AREA REMAINING 13,162 SQ.FT.
- 12) WATER QUALITY BUFFER DATA TAKEN FROM MECKLENBURG COUNTY GIS.

STATE OF NORTH CAROLINA
 COUNTY OF MECKLENBURG

_____, REVIEW OFFICER OF MECKLENBURG COUNTY, CERTIFY THAT THE MAP OR PLAT TO WHICH THIS CERTIFICATION IS AFFIXED MEETS ALL STATUTORY REQUIREMENTS FOR RECORDING.

REVIEW OFFICER _____ DATE _____

REBAR FOUND IN THE NORTHWEST CORNER OF TAX PARCEL 103-321-48. (TIE)

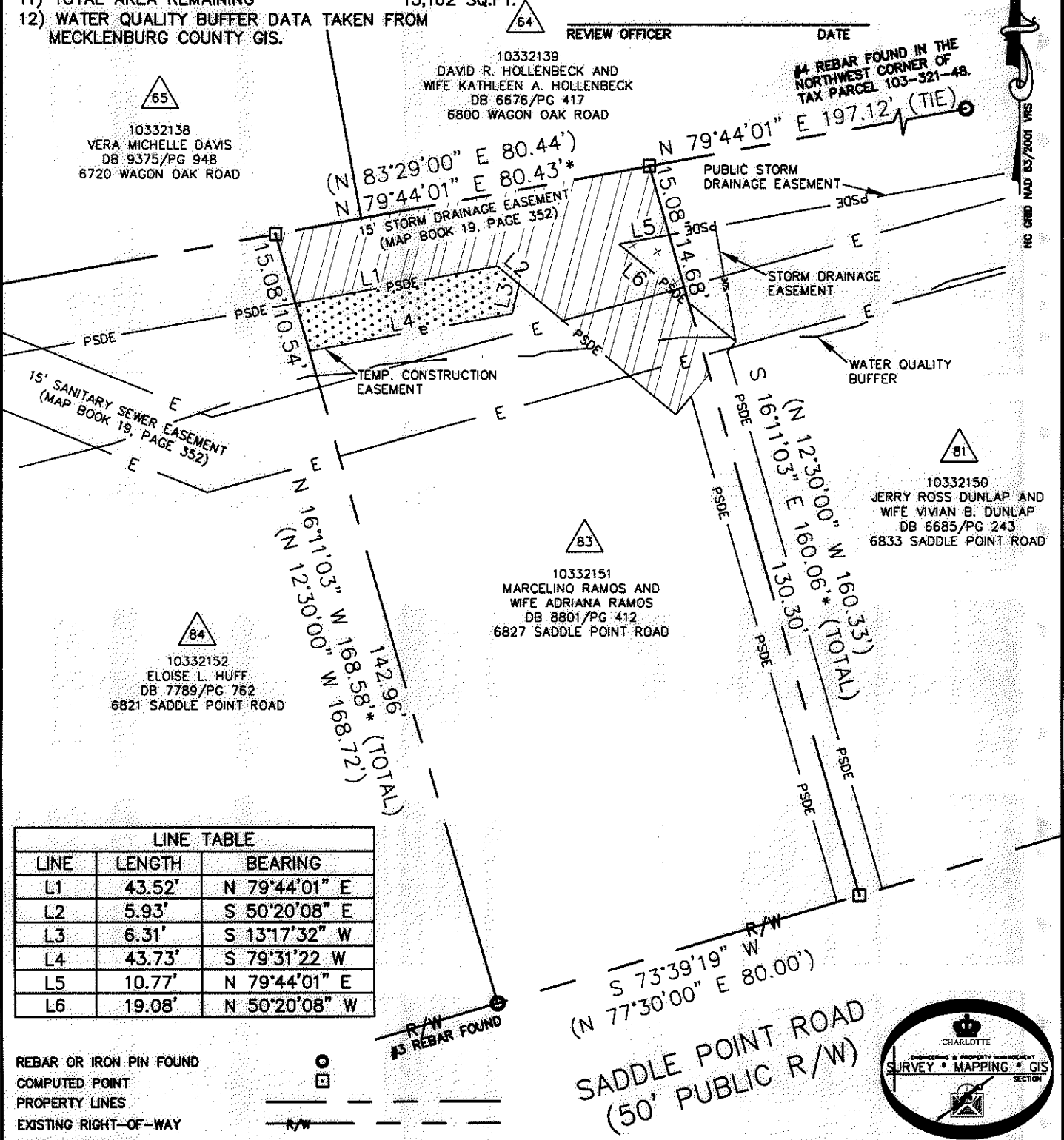

LINE TABLE		
LINE	LENGTH	BEARING
L1	43.52'	N 79°44'01" E
L2	5.93'	S 50°20'08" E
L3	6.31'	S 13°17'32" W
L4	43.73'	S 79°31'22" W
L5	10.77'	N 79°44'01" E
L6	19.08'	N 50°20'08" W

- REBAR OR IRON PIN FOUND
- COMPUTED POINT
- PROPERTY LINES _____
- EXISTING RIGHT-OF-WAY
- EXIST EASEMENTS _____ E _____
- TEMP. CONSTRUCTION EASEMENT _____ e _____
- STORM DRAINAGE EASEMENT _____ SDE _____
- PUBLIC STORM DRAINAGE EASEMENT _____ PSDE _____
- WATER QUALITY BUFFER (WQB) _____
- TEMP. CONSTRUCTION EASEMENT
- PUBLIC STORM DRAINAGE EASEMENT
- STORM DRAINAGE EASEMENT

PREPARED BY:
 CITY OF CHARLOTTE
 ENGINEERING & PROPERTY MANAGEMENT
 600 EAST FOURTH STREET
 CHARLOTTE, NC 28202
 704-336-2291

CHARLOTTE
 ENGINEERING & PROPERTY MANAGEMENT

REVISIONS	FARM POND NEIGHBORHOOD IMPROVEMENT PROJECT	JOB NO. 512-07-029
		FILE NO. 103-321-51
SCALE 1"=30'	PROPERTY ACQUISITION OWNERS: MARCELINO RAMOS AND WIFE ADRIANA RAMOS CHARLOTTE, MECKLENBURG CO., NC	SHEET 1
DRAWN BY LG	CHECKED BY DHS SURVEY SUPVR. <i>ANK</i>	OF 1
K:\AUTOCAD\EN_SU-LD4\207029\DWG\FARM POND NIP PLATS.DWG		

ACQUISITION BY DB 26962 PG 312-317