

I, DAVID H. SNIDER, CERTIFY THAT THIS PLAT WAS PREPARED UNDER MY SUPERVISION AND THAT THE PLAT WAS PREPARED FOR THE PURPOSE OF EASEMENTS ONLY, AND IS NOT INTENDED TO BE A BOUNDARY SURVEY OF PROPERTY SHOWN.

*David H. Snider* 6/22/09  
 DAVID H. SNIDER, NC P.L.S. L-2942 DATE

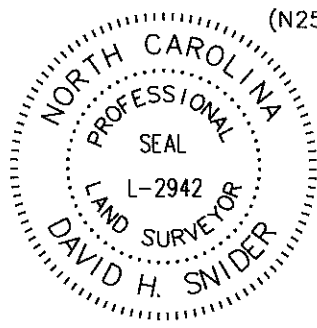

**NOTE:**

- 1) BEARINGS AND DISTANCES SHOWN IN PARENTHESES ARE BASED ON RECORDED MAP & DEED INFORMATION.
- 2) TOTAL AREA 926,625 SQ.FT.
- 3) TEMPORARY CONSTRUCTION EASEMENT 747 SQ.FT.
- 4) SIDEWALK / UTILITY EASEMENT 66 SQ.FT.
- 5) AREA REMAINING 926,625 SQ.FT.

③  
 THE TRUSTEES OF CENTRAL  
 PIEDMONT COMMUNITY COLLEGE  
 TAX CODE: 105-091-28  
 DB 5558 PAGE 863  
 8001 GRIER ROAD

THE TRUSTEES OF CENTRAL  
 PIEDMONT COMMUNITY COLLEGE  
 TAX CODE: 105-091-20  
 DB 6476 PAGE 288

PREPARED BY:  
 CITY OF CHARLOTTE  
 ENGINEERING DEPARTMENT  
 600 EAST FOURTH STREET  
 CHARLOTTE, NC 28202  
 704-336-2291

④  
 THE CHARLOTTE-MECKLENBURG  
 BOARD OF EDUCATION  
 TAX CODE: 105-091-26  
 DB 9876 PAGE 176  
 8330 GRIER ROAD

WSOC  
 TAX CODE: 105-091-24  
 DB 5415 PAGE 963

(N25°27'33"E 160.19' total)  
 N25°00'08"E

SEE DETAIL "A"

5

MECKLENBURG COUNTY  
 TAX CODE: 105-071-07  
 DB 10888 PAGE 642  
 GRIER ROAD

N 557372.47  
 E 1485028.21  
 @ sta 46+77.87 Grier Rd.  
 9.64' RT.

(N42°22'40"E 291.34')  
 N42°00'49"E

(N44°09'08"W 911.57')  
 N44°30'59"W

(N72°33'32"E 108.44')  
 N72°11'41"E

(N73°42'04"E 300.34')  
 N73°20'13"E

(N191°17'56"W 547.34')  
 N119°39'47"W

LINE TABLE		
LINE	LENGTH	BEARING
L1	27.88	N25°00'08"E
L2	16.71	S44°30'59"E
L3	9.99	S44°30'59"E
L4	22.17	S44°30'59"E
L5	8.69	S24°07'15"W
L6	8.68	S60°58'59"E
L7	5.83	N30°37'01"E
L8	13.90	S69°37'03"W
L9	36.04	N66°24'36"W

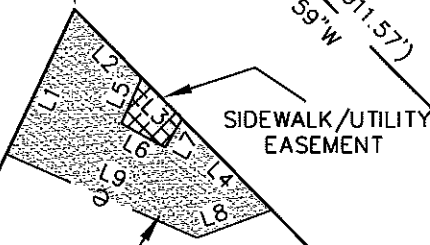

TEMPORARY  
 CONSTRUCTION  
 EASEMENT

DETAIL "A"  
 NTS

(S61°07'00"W 600.00')  
 S60°45'09"W

MECKLENBURG COUNTY  
 TAX CODE: 105-071-06  
 DB 9276 PAGE 437

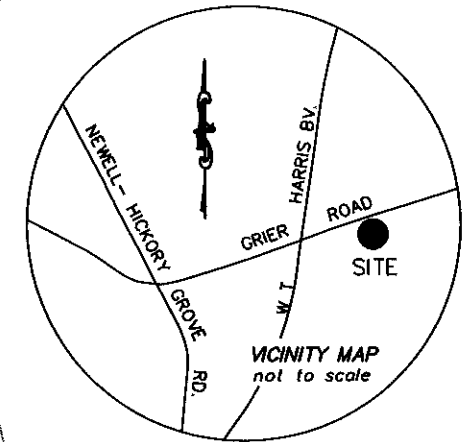

State of North Carolina  
 County of Mecklenburg

I, \_\_\_\_\_, Review Officer of Mecklenburg County, certify that the map or plat to which this certification is affixed meets all statutory requirements for recording.

Review Officer \_\_\_\_\_ Date \_\_\_\_\_

MECKLENBURG COUNTY  
 TAX CODE: 105-071-01  
 DB 9276 PAGE 437

**LEGEND**

- TEMP. CONSTRUCTION EASEMENT
- SIDEWALK / UTILITY EASEMENT
- LINES SURVEYED
- LINES NOT SURVEYED

CURVE TABLE				
CURVE	LENGTH	RADIUS	CHORD	CHORD BEARING
C1	(280.70)	(532.93)	(277.47)	(N57°28'02"E)
				N57°06'11"E
C2	(189.87)	(643.00)	(189.18)	(N33°55'06"E)
				N33°33'15"E

**CHARLOTTE ENGINEERING DEPARTMENT**

<b>REVISIONS</b>	<b>GRIER ROAD SIDEWALK</b>	<b>JOB NO.</b> 512-07-068
		<b>FILE NO.</b> LAN# 207068
 <b>SCALE 1"=200'</b>	<b>OWNER:</b> THE CHARLOTTE-MECKLENBURG BOARD OF EDUCATION TAX CODE: 105-091-26 CHARLOTTE, MECKLENBURG CO., NC	<b>SHEET</b> 1  <b>OF</b> 1
<b>DRAWN BY</b> G.F.	<b>CHECKED BY</b> <i>[Signature]</i>	<b>SURVEY SUPVR.</b> <i>[Signature]</i>
<b>DATE</b>		

ACCOMPLISHED BY 25401 939