

PARCEL AREA DATA		
DESC.	SQ. FT.	AC.
TOTAL PARCEL	84190	1.9
TOTAL AREA ACQ'D	1208	0.03
TOTAL PERM.		
DRAINAGE EASE.	250	n/a
AREA REMAINING	82732	1.9
TOTAL TEMP.	1899	0.04
CONST. EASE.		

AREA ACQUIRED		
LINE	BEARING	DIST.
L1	N 35°07'22" E	9.25'
L2	S 81°12'19" E	143.90'
L3	S 35°05'00" W	9.48'
L4	N 81°07'14" W	143.80'

NCGS MON. "RANDY"
N 546702.660
E 1481061.021

N.C. GRID - N.A.D. 83
COMBINED SCALE FACTOR = .9998362

N/F THE SALVATION ARMY
D.B. 3772, PG. 141

PERM. DRAIN. EASEMENT		
LINE	BEARING	DIST.
L10	N 8°47'41" E	12.50'
L11	S 81°12'19" E	20.00'
L12	S 8°47'41" W	12.50'
L13	N 81°12'19" W	20.00'

118

N/F C.A. AUSTIN
D.B. 5523, PG. 509

N 545830.691
E 1480276.882

TEMP. CONST. EASEMENT		
LINE	BEARING	DIST.
L5	N 35°07'22" E	23.99'
L6	S 81°12'19" E	21.94'
L7	S 8°47'41" W	10.00'
L8	S 81°12'19" E	117.00'
L9	S 35°05'00" W	12.83'
L2	N 81°12'19" W	143.90'

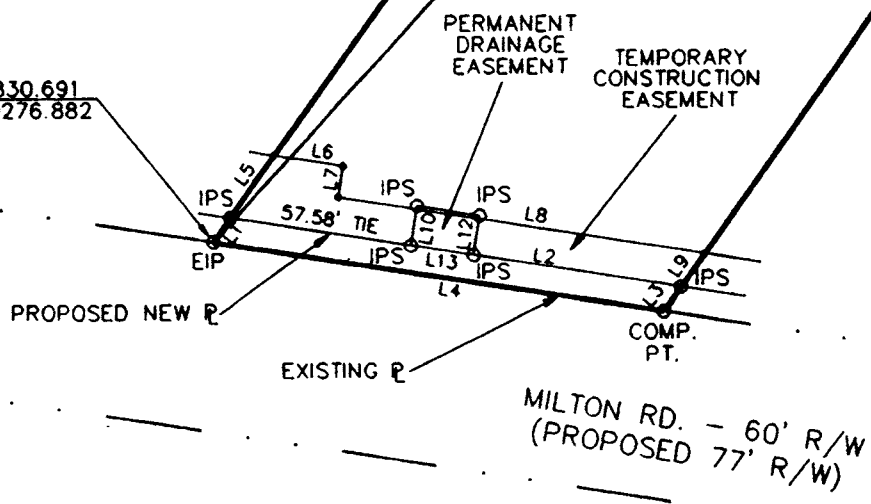

I, R. A. Hathaway, certify that this plat was drawn under my supervision. This plat is a compilation of field and deed data and is NOT intended to be a boundary survey of the property shown.

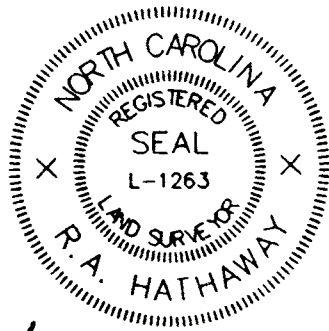

- REFERENCES:
- 1) NCGS MONUMENTS "RANDY" AND "TAYLOR".
 - 2) CHARLOTTE ENG. DEPT. R/W PLANS FOR PROPOSED MILTON RD. IMPROVEMENTS PREP. BY PBS&J, CHARLOTTE, DATED 10/25/93. (PARCEL #118)
 - 3) D.B. 5523, PG. 507.
 - 4) D.B. 4407, PG. 7.
 - 5) MAP BOOK 1195, PG. 2.

- NOTES:
- 1) EIP DENOTES EXISTING IRON PIPE.
 - 2) IPS DENOTES IRON PIPE SET.
 - 3) ALL DISTANCES ARE HORIZONTAL GROUND.
 - 4) AREAS BY COORDINATE COMPUTATION.
 - 5) (C) DENOTES COMPUTED.
 - 6) (F) DENOTES FIELD MEASUREMENT

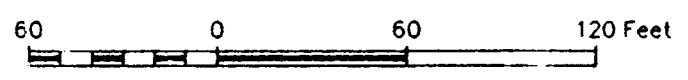

R. A. Hathaway
R. A. Hathaway, NCRLS # L-1263

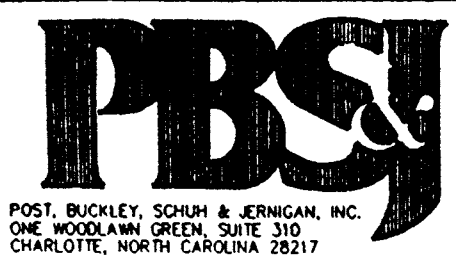

CHARLOTTE ENGINEERING DEPARTMENT		
MILTON ROAD IMPROVEMENTS PROJECT NO. 512-89-062		JOB NO. 20-049.15
PROPERTY OF C.A. AUSTIN TAX MAP CODE 107-031-PARCEL 3 CITY OF CHARLOTTE, WECOLENBURG COUNTY, N.C.		DWG NO. ML1118.DWG
REVISIONS	DATE 3/9/94	SHEET 1 OF 2
1. 4/14/95		
DRAWN BY B.L.H.	CHECKED BY D.S.L.	SCALE 1" = 60'
SURVEY SUP'R		

107-031-03