

I, DAVID H. SNIDER, CERTIFY THAT THIS PLAT WAS PREPARED UNDER MY SUPERVISION AND THAT THE PLAT WAS PREPARED FOR THE PURPOSE OF ACQUISITION AND EASEMENTS ONLY, AND IS NOT INTENDED TO BE A BOUNDARY SURVEY OF PROPERTY SHOWN.

David H. Snider 5/17/02
 DAVID H. SNIDER, NC P.L.S. L-2942 DATE

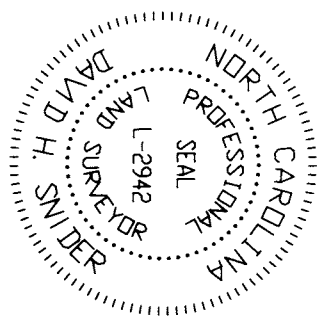

State of North Carolina
 County of Mecklenburg

Review Officer of Mecklenburg County, certify that the map or plat to which this certification is affixed meets all statutory requirements for recording.

Review Officer _____ Date _____

**ACQUISITION BY CITY
 RECORDED IN DEED BOOK
 15529-326
 DATE 06-18-03**

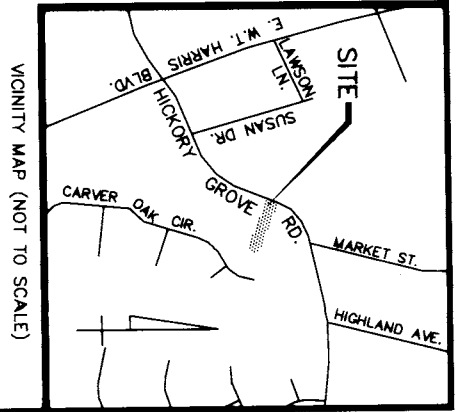

- NOTE:
- 1) BEARINGS AND DISTANCES SHOWN IN PARENTHESES ARE BASED ON RECORDED MAP INFORMATION.
 - 2) TOTAL AREA 16,572 SQ.FT.
 - 3) CONSTRUCTION 743 SQ.FT.
 - 4) AREA ACQUIRED 50 SQ.FT.
 - 5) AREA REMAINING 16,522 SQ.FT.

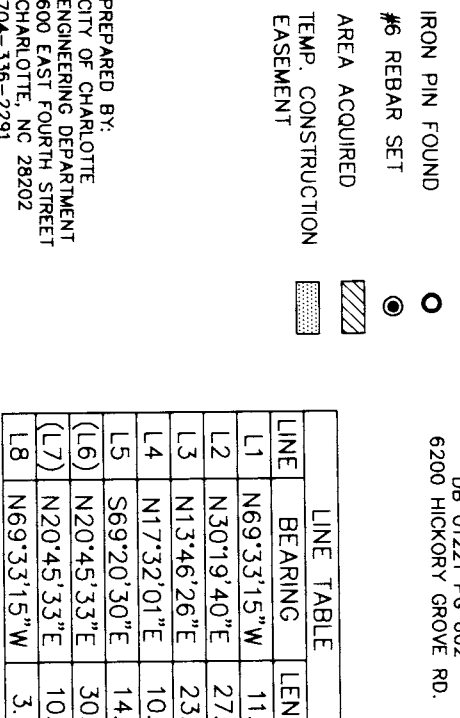
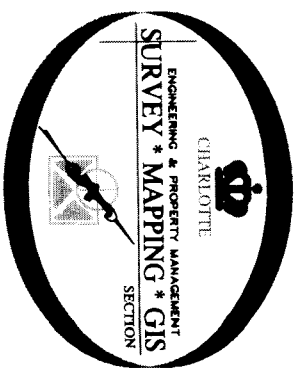

LEGEND

- IRON PIN FOUND
- #6 REBAR SET
- ▨ AREA ACQUIRED
- ▧ TEMP. CONSTRUCTION EASEMENT

LINE	BEARING	LENGTH
L1	N69°33'15"W	11.61
L2	N30°19'40"E	27.38
L3	N13°46'26"E	23.09
L4	N17°32'01"E	10.35
L5	S69°20'30"E	14.56
L6	N20°45'33"E	30.68
L7	N20°45'33"E	10.69
L8	N69°33'15"W	3.42

CURVE	RADIUS	LENGTH	CHORD	BEARING
C1	360.50	29.79	29.78	S28°40'54"W
C2	256.48	18.80	18.80	S22°51'34"W

CHARLOTTE ENGINEERING DEPARTMENT

HICKORY GROVE ROAD WIDENING

PROPERTY ACQUISITION

OWNER: CHRISTOPHER D. MARCINKO CHARLOTTE, MECKLENBURG CO., NC

CHECKED BY: [Signature] SURVEY SUPERV.

JOB NO.	109-011-06
FILE NO.	512-97-087
SHEET	1
OF	1

PREPARED BY:
 CITY OF CHARLOTTE
 ENGINEERING DEPARTMENT
 600 EAST FOURTH STREET
 CHARLOTTE, NC 28202
 704-336-2291