

I, R. DENNIS SMITH, CERTIFY THAT THIS PLAT WAS PREPARED UNDER MY SUPERVISION AND THAT THE PLAT WAS PREPARED FOR THE PURPOSE OF ACQUISITION AND EASEMENTS ONLY, AND IS NOT INTENDED TO BE A BOUNDARY SURVEY OF PROPERTY SHOWN.

R. Dennis Smith 4/8/98  
 R. DENNIS SMITH, NC R.L.S. L-1482 DATE

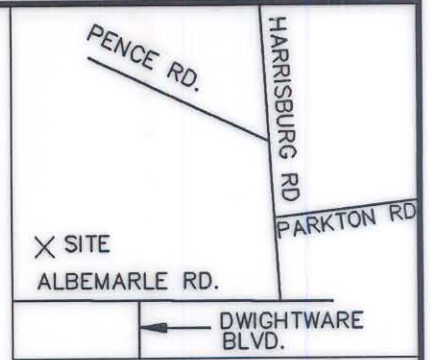
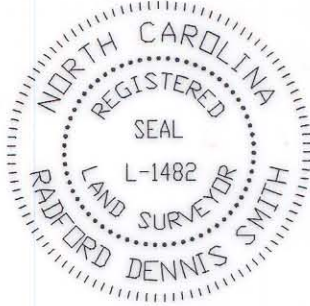

VICINITY MAP  
NOT TO SCALE

NOTE:

- 1) BEARINGS AND DISTANCES SHOWN IN PARENTHESES ARE BASED ON RECORDED MAP INFORMATION.
- 2) TOTAL AREA 50,697 SQ.FT.
- 3) AREA ACQUIRED 103 SQ.FT.
- 4) AREA REMAINING 50,594 SQ.FT.
- 5) PERMANENT STORM DRAINAGE EASEMENT 301 SQ.FT.
- 6) TEMPORARY CONSTRUCTION EASEMENT 600 SQ.FT.

GRAPHIC SCALE

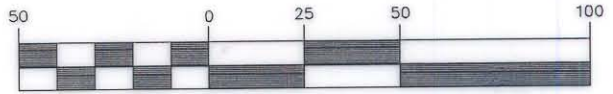

( IN FEET )  
1 inch = 50 ft.

EAST CIRCUMFERENTIAL RD.  
PROPOSED  
130' RIGHT OF WAY  
(C9 TOTAL)

109-092-09  
CHARTER PROPERTIES  
DEED: 6615-0301  
9009 ALBEMARLE RD.

N 86°40'05" E 243.85'  
(N 86°44'16" E) 244.14'

4

109-092-22  
FIRST UNION NATIONAL BANK OF N.C.  
DEED: 6687-0607  
9005 ALBEMARLE RD.

EXISTING STORM DRAINAGE EASEMENT

N 03°22'26" W 123.83'  
(N 03°15'44" W) (123.83')  
S 03°22'26" E 78.47'  
(S 03°15'44" E) (78.48')

PER STATE PROJECT 8.1671901

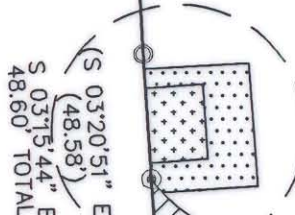

C1  
C7 TOTAL  
(C8 TOTAL)

SEE DETAIL PAGE 2

LEGEND

- IRON PIN FOUND
- IRON PIN SET
- MONUMENT
- PK NAIL FOUND
- RIGHT OF WAY
- PROPERTY LINE
- LINES SURVEYED
- LINES NOT SURVEYED
- AREA ACQUIRED
- TEMPORARY CONSTRUCTION EASEMENT
- PERMANENT DRAINAGE EASEMENT

ALBEMARLE ROAD  
R/W VARIES

ACQUISITION BY CITY  
RECORDED IN DEED BOOK  
9960-570  
DATE 10/6/1998

PREPARED BY:  
CITY OF CHARLOTTE  
ENGINEERING DEPARTMENT  
600 EAST FOURTH STREET  
CHARLOTTE, NC 28208  
704-336-2291

		CHARLOTTE ENGINEERING DEPARTMENT
REVISIONS	EAST CIRCUMFERENTIAL ALBEMARLE RD.	JOB NO. 51297102
DRAWN BY GAI	PROPERTY ACQUISITION	FILE NO.
CHECKED BY	FIRST UNION NATIONAL BANK OF N.C.	PLAT2
SURVEY SUPR.	CHARLOTTE, MECKLENBURG CO., NC	SHEET 1
DATE 04/07/98	SCALE 1" = 50'	OF 2