

I, JACKIE W. BRIM, CERTIFY THAT THIS PLAT WAS PREPARED UNDER MY SUPERVISION AND THAT THE PLAT WAS PREPARED FOR THE PURPOSE OF ACQUISITION AND EASEMENTS ONLY, AND IS NOT INTENDED TO BE A BOUNDARY SURVEY OF PROPERTY SHOWN.

*Jackie W. Brim* 10-6-15  
 JACKIE W. BRIM, NC P.L.S. L-4348 DATE



CURVE TABLE		
CURVE	RADIUS & ARC	CHORD
C1	R=45.00 L=7.54'	S 01°51'30" E 7.53'
C2	R=45.00 L=36.15'	S 29°39'50" E 35.18'

LINE TABLE		
LINE	LENGTH	BEARING
L1	9.55'	N 81°04'41" E
L2	10.00'	N 03°02'49" E

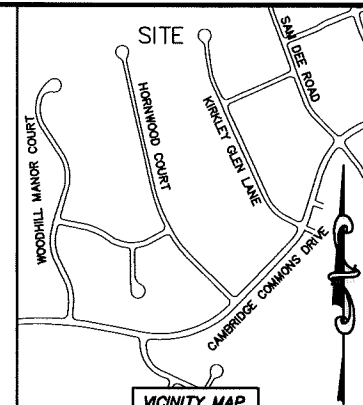

11138253  
 DEAN A. BECK AND  
 WIFE CORRINE BECK  
 DB 6522/PG 659  
 8723 KIRKLEY GLEN LANE

MAG. NAIL  
 NC GRID NAD 83 (2011)  
 N: 552,060.99 FEET  
 E: 1,502,773.01 FEET  
 CGF: 0.999847561

VICINITY MAP  
 \*not to scale\*

#5 REBAR FOUND  
 S 47°52'08" E  
 167.23' (TIE)

11138299  
 MECKLENBURG COUNTY  
 DB 23964/PG 343  
 HORNWOOD COURT

11138216  
 JOHN G. VANDER GAST, JR. AND  
 PATRICIA M. VANDER GAST  
 DB 15673/PG 184  
 8726 HORNWOOD COURT

STATE OF NORTH CAROLINA  
 COUNTY OF MECKLENBURG

REVIEW OFFICER OF  
 MECKLENBURG COUNTY, CERTIFY THAT THE MAP OR  
 PLAT TO WHICH THIS CERTIFICATION IS AFFIXED  
 MEETS ALL STATUTORY REQUIREMENTS FOR  
 RECORDING.

REVIEW OFFICER \_\_\_\_\_ DATE \_\_\_\_\_

11138217  
 JOE M. PRICE, JAMIE L. PRICE,  
 AND DILLON W. QUINTANA  
 DB 26263/PG 806  
 8722 HORNWOOD COURT

PREPARED BY:  
 CITY OF CHARLOTTE  
 ENGINEERING & PROPERTY MANAGEMENT DEPARTMENT  
 600 EAST FOURTH STREET  
 CHARLOTTE, NC 28202  
 704-336-2291

(S 01°00'00" W 87.20')  
 N 00°04'41" E 87.50' (TOTAL)  
 69.68'  
 10.01' 7.51'  
 APPROXIMATE LOCATION 20' PUBLIC  
 STORM DRAIN EASEMENT  
 (PER MB 23/PG 792)

(S 19°00'00" E 12.77')  
 N 19°55'19" E 12.77'

STORM DRAINAGE EASEMENT

NOTE:

- 1) BEARINGS AND DISTANCE SHOWN IN PARENTHESIS ARE BASED ON RECORDED INFORMATION.
- 2) COMPUTED PROJECT DISTANCE - \*
- 3) TOTAL AREA 16,164 SQ.FT.
- 4) TEMP. CONSTRUCTION EASEMENT 974 SQ.FT.
- 5) STORM DRAINAGE EASEMENT 1,463 SQ.FT.
- 6) EXISTING DRAINAGE AREA TO BE ACCEPTED BY THE CITY OF CHARLOTTE AS SDE 1,463 SQ.FT.
- 7) EXISTING PUBLIC DRAINAGE EASEMENT AND SDE OVERLAP AREA 1,463 SQ.FT.
- 8) TOTAL AREA REMAINING 16,164 SQ.FT.

LEGEND

- REBAR OR IRON PIN FOUND
- COMPUTED POINT
- PROPERTY LINES
- EXISTING RIGHT-OF-WAY
- EXISTING EASEMENTS
- STORM DRAINAGE EASEMENT
- TEMP. CONSTRUCTION EASEMENT

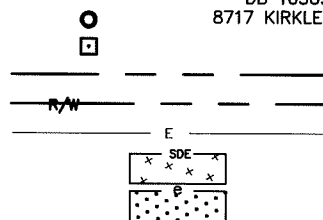

11138251  
 RICHARD D. HENSON AND  
 WIFE RENEE A. HENSON  
 DB 10509/PG 709  
 8717 KIRKLEY GLEN LANE

11138252  
 RONALD S. WITKOWSKI AND  
 WIFE JENNIFER M. WITKOWSKI  
 DB 8520/PG 724  
 8721 KIRKLEY GLEN LANE

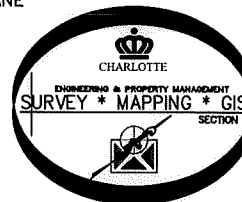

CHARLOTTE ENGINEERING & PROPERTY MANAGEMENT DEPARTMENT		
REVISIONS	8723 KIRKLEY GLEN LANE STORM WATER MAINTENANCE IMPROVEMENT PROJECT	JOB NO. SWDES00406
SCALE 1"=30'	PROPERTY OF OWNERS: RONALD S. WITKOWSKI AND WIFE JENNIFER M. WITKOWSKI CHARLOTTE, MECKLENBURG CO., NC	FILE NO. 111-382-52
DRAWN BY LG	CHECKED BY JWB SURVEY SUPVR.	SHEET 1 OF 1
DATE _____		
K:\AutoCad\En_su-LD4\SWDES00406-KirkleyGlenDrive\dwg		

ACQUISITION BY DB 30328 PG 217