

CITY OF CHARLOTTE  
AIRPORT

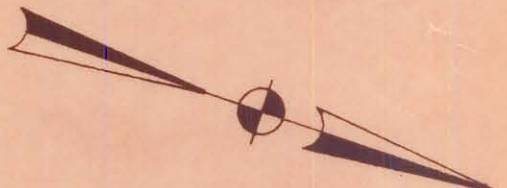

AREA TAKEN = 5,460 SQ. FT.

NEW

DIXIE

ROAD

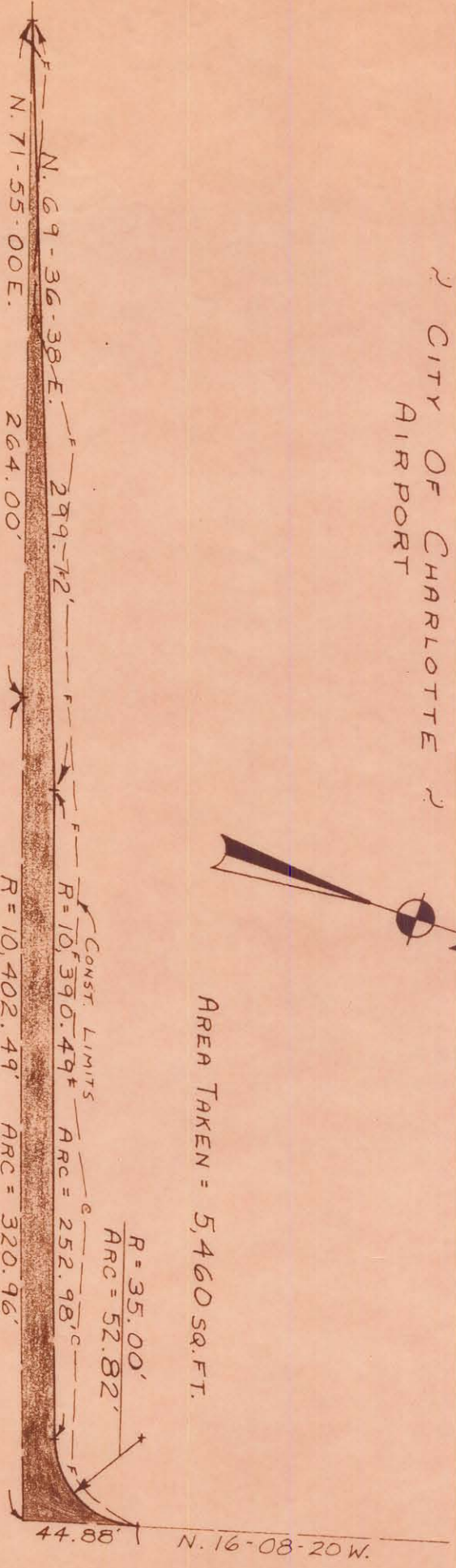

NEW DIXIE RD. WIDENING PLANS  
By TALBERT & ASSOC. 11-14-63

THIS PLAN HAS DRAWING NUMBER BY  
REGISTERED PROFESSIONAL ENGINEER  
R. S. BULLOCK  
No. 4343

|   |  |                   |
|---|--|-------------------|
| CITY OF CHARLOTTE<br>NORTH CAROLINA<br>ENGINEERING DEPARTMENT |  | JOB NO.<br>572-71 |
| REVISIONS   | NEW DIXIE RD.<br>INTERSECTIONS<br>IMPROVEMENTS | FILE NO.<br>103   |
| DRAWN BY J.B.G.   | PROPERTY OF<br>CITY OF CHARLOTTE               | SHEET<br>2        |
| CHECKED BY J.T.Z.   | AIRPORT  | OF<br>4           |
| CITY ENGINEER   | DATE June, 1971                                | SCALE 1" = 60'    |