

GRAPHIC SCALE

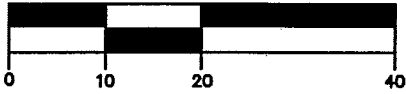

(IN FEET)
1 inch = 20ft.

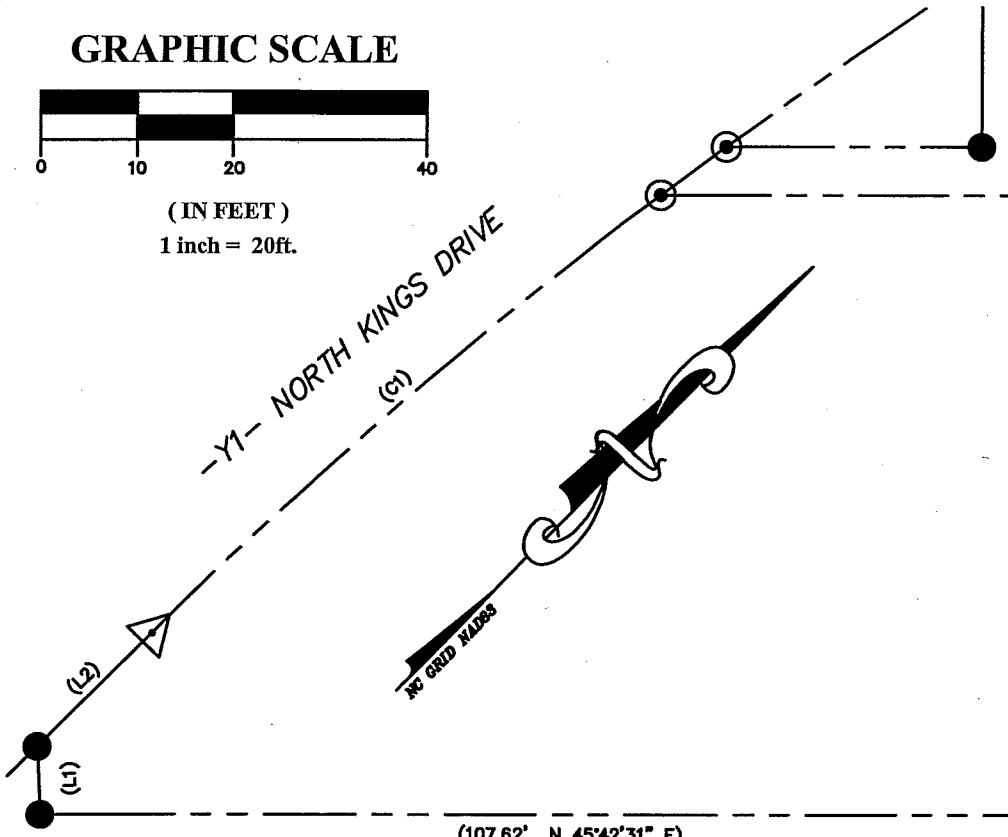

(158.65' N 45°42'31" E)

(107.62' N 45°42'31" E)

(115.25' N 45°42'31" E)

CENTRAL PIEDMONT COMMUNITY COLLEGE
& FINANCIAL SERVICE MGR.
TAX PARCEL #125-101-11
DB 11627 PG 800
6005 SQ.FT./0.137 ACRES
ZONED: MUDD-0

(27)

CENTRAL PIEDMONT COMMUNITY COLLEGE
& FINANCIAL SERVICE MGR.
TAX PARCEL #125-101-10
DB 11708 PG 862
12620 SQ.FT./0.289 AC.
ZONED: MUDD-0

(28)

CENTRAL PIEDMONT COMMUNITY COLLEGE
& FINANCIAL SERVICE MGR.
TAX PARCEL #125-101-09
DB 11708 PG 964
6909 SQ.FT./0.158 AC.
ZONED: MUDD-0

(29)

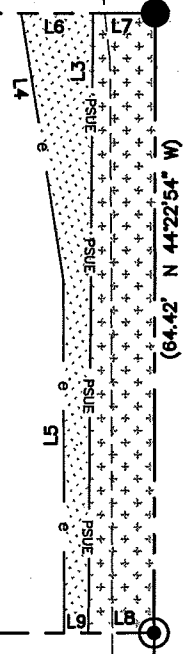

-L- ELIZABETH AVENUE

LEGEND

- Temporary Construction Easement e
- Existing Edge of Pavement
- Existing Property Line
- Permanent Sidewalk Easement PSE
- Permanent Sidewalk and Utility Easement ... PSUE
- Existing Structure
- Permanent Sidewalk and Utility Easement
- Temporary Construction Easement

LINE TABLE		
LINE	LENGTH	BEARING
(L1)	7.07	N 47°00'29" W
(L2)	16.70	S 01°05'48" W
L3	64.42	S 44°05'46" E
L4	28.18	S 53°23'00" E
L5	36.60	S 44°38'04" E
L6	7.45	S 45°42'31" W
L7	6.43	S 45°42'31" W
L8	6.75	N 45°42'31" E
L9	2.56	N 45°42'31" E

CURVE TABLE				
CURVE	RADIUS	LENGTH	CHORD	BEARING
(C1)	489.37	69.68	69.62	S 04°44'44" W

SPECIAL NOTE:
ALL TREES AND SHRUBS IN THE EASEMENT ARE SUBJECT TO REMOVAL EXCEPT AS NOTED.

NOTE:

- 1) BEARINGS AND DISTANCE SHOWN IN PARENTHESES ARE BASED ON RECORDED MAP INFORMATION.
- 2) TOTAL AREA 12621 SQ.FT.
- 3) TEMP. CONSTRUCTION EASEMENT 244 SQ.FT.
- 4) PERMANENT SIDEWALK EASEMENT 0 SQ.FT.
- 5) PERMANENT SIDEWALK / UTILITY EASEMENT 424 SQ.FT.
- 6) PERMANENT LANDSCAPE EASEMENT 0 SQ.FT.

This map is not a certified survey and has not been reviewed by a local government agency for compliance with any applicable land development regulations.

PREPARED BY:

HDR HDR Engineering, Inc.
of the Carolinas
Suite 1400
128 S. Tryon Street
Charlotte, NC 28202-5001
PHONE: (704) 338-6700
FAX: (704) 338-6700

CHARLOTTE
ENGINEERING & PROPERTY
MANAGEMENT

512-01-022
JOB NO.

1"=20'
SCALE

D.J.G.
PREPARED BY

7/27/2006
DATE

Elizabeth Avenue
Business Corridor

CPCC
1140 Elizabeth Ave.
Parcel 28

512-01-022
PROJECT NO.

P:\10433-5987-018-ELIZ\EXHIBITS_HDR\PARCEL 28.DWG
PATH

DB 22177 PG 398