

E. MOREHEAD ST.

NOTE
 INFORMATION SHOWN TAKEN FROM
 PLANS OF McDOWELL ST. WIDENING
 PREPARED BY WILBUR SMITH & ASSOC.
 DATED MAR. 1970

N. 53-26-59 E. 300.00'

ADDISON REALTY CO.
 DEED: 614-596



TOTAL AREA = 119,764.5 SF
 AREA TAKEN = 46.5 SF
 AREA REMAINING = 119,718.0 SF

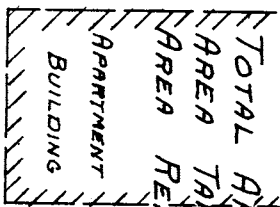

OPEN SHED
 BRICK GARAGE

219.73' CONST. LIMITS
 N. 53-26-59 E

298.86'
 N. 36-00-21 W.

CITY OF CHARLOTTE
 CITY REDEV. COMM.

DETAIL "A"
 NO SCALE

PROP. R/W
 R = 2824.79' ARC = 80.32'
 N. 53-26-59 E. 80.30'
 EXIST. R/W
 21.14'

N. 36-00-21 W.

S. McDOWELL ST.

40' PROP.
 40'
 80' R/W

DETAIL "A"
 AT RIGHT

Approved by

R/W Agent

NOTE: Property corners shown circled were located by actual survey. Bearings are based on

CONST. PLANS S. McDowell

ST. BY WILBUR SMITH & ASSOC.

MAR. 1970

This plat was prepared under my supervision
 N.C. Reg. Engineer No. 3659
C. J. Madbury

CITY OF CHARLOTTE NORTH CAROLINA ENGINEERING DEPARTMENT		PROPOSED R/W	JOB NO.
REVISIONS		S. McDowell St.	
DRAWN BY J.B.G.		PROPERTY OF	FILE NO.
CHECKED BY J.T.T.		ADDISON REALTY CO.	
CITY ENGINEER	DATE DEC. 1970	SCALE 1" = 50'	SHEET 1 OF 4