

I, DAVID H. SNIDER, CERTIFY THAT THIS PLAT WAS PREPARED UNDER MY SUPERVISION AND THAT THE PLAT WAS PREPARED FOR THE PURPOSE OF EASEMENTS ONLY, AND IS NOT INTENDED TO BE A BOUNDARY SURVEY OF PROPERTY SHOWN.

*David H. Snider* 7/28/11  
 DAVID H. SNIDER, NC P.L.S. L-2942 DATE

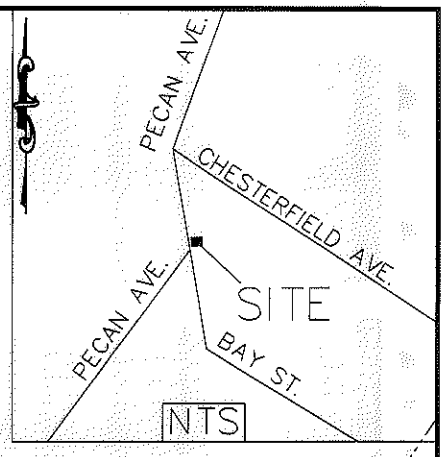
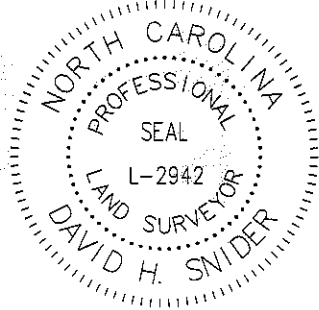

STATE OF NORTH CAROLINA  
 COUNTY OF MECKLENBURG

I, \_\_\_\_\_, REVIEW OFFICER OF MECKLENBURG COUNTY, CERTIFY THAT THE MAP OR PLAT TO WHICH THIS CERTIFICATION IS AFFIXED MEETS ALL STATUTORY REQUIREMENTS FOR RECORDING.

REVIEW OFFICER \_\_\_\_\_ DATE \_\_\_\_\_

④  
 127-023-30  
 JAMES EARL BRANNON, SR.  
 DB 4257-572  
 2012 CHEASTERFIELD AV

⑤  
 127-023-29  
 DAVID L. BARKER AND  
 DAVID M. BARKER & WVS  
 DB 6167-542  
 2016 CHESTERFIELD AV

⑤  
 127-023-33  
 QUEEN CITY CHAPTER #10,  
 DISABLED AMERICAN VETERANS, INC.  
 DB 3908-705  
 2013 BAY ST

⑥  
 127-023-34  
 QUEEN CITY CHAPTER #10,  
 DISABLED AMERICAN VETERANS, INC.  
 DB 3908-705  
 2017 BAY ST

50' RIGHT OF WAY  
 PECAN AVENUE

ALLEY

2+92.18  
 RT 18.00'

36.69'

39.50'

N86°15'10"E  
 14.93'

N39°15'23"E  
 16.92'

N56°21'24"W 93.40'  
 (S56°18'00"E) TOTAL

53.90'

S11°26'12"E 131.90' TOTAL

95.22'

N33°38'36"E 93.74'  
 (S33°42'00"W)

(TIE)  
 N57°01'40"W  
 49.96'

COMBINED GRID  
 FACTOR=0.9998  
 N 538322.56  
 E 1458014.13

LEGEND

- IRON PIN FOUND ○
- CALCULATED POINT ●
- LINES SURVEYED ———
- LINES NOT SURVEYED - - - - -
- TEMP. CONSTRUCTION EASEMENT [shaded box]



- 1) BEARINGS AND DISTANCES SHOWN IN PARENTHESES ARE BASED ON RECORDED MAP INFORMATION.
- 2) TOTAL AREA 4,350 SQ. FT.
- 3) TEMP CONSTRUCTION EASEMENT 604 SQ. FT.
- 4) AREA REMAINING 4,350 SQ. FT.

PREPARED BY:  
 CITY OF CHARLOTTE  
 ENGINEERING DEPARTMENT  
 600 EAST FOURTH STREET  
 CHARLOTTE, NC 28202  
 704-336-2291

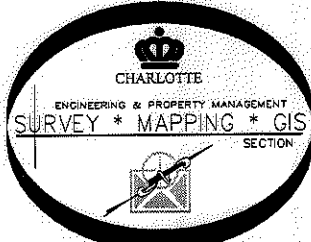

|  |  |  |  |
|--|--|--|--|
|  |  | CHARLOTTE<br>ENGINEERING DEPARTMENT  |  |
| REVISIONS  |  | BAY-PECAN<br>INTERSECTION IMP.   |  |
| 7/28/11 PROJECT #  |  | JOB NO:<br>512-10-051  |  |
| SCALE<br>1"=20'  |  | 210051   |  |
| DRAWN BY P.S.  |  | PROPERTY OF<br>QUEEN CITY CHAPTER #10,<br>DISABLED AMERICAN VETERANS, INC.<br>CHARLOTTE, MECKLENBURG CO., NC |  |
| DATE   |  | SHEET<br>1   |  |
| CHECKED BY DS  |  | OF<br>1  |  |
| SURVEY SUPVR. <i>DNA</i>   |  |  |  |
| K:\AutoCad\En_su-LD4\210051 Bay-Pecan Intersection\PLATS\#5 127-023-33 |  |  |  |

ACQUISITION BY DB 26761 PG 316-320