

TOTAL AREA 86,375.69 Sq.Ft.-1.9829 AC.  
AREA TAKEN 752.92 Sq.Ft.-0.0173 AC.  
REMAINING AREA 85,622.77 Sq.Ft.-1.9656 AC.



SCALE 1"=10'

SEE DETAIL UTILITY ESM'T. 12 S.F.

CENTRAL AVE. 60' R/W

NANDINA ST.

80' R/W

THE PLAZA

N. 00-33-24 W. 202.96

N. 89-26-32 E. 91.94

ENERGY OIL CO. INC. 3189-429

LOT 2 TPT, INC. 3544-587 MAP BOOK 4-145

LOT 1 1478 SF

LOT 11

MAUDE L. FLYNN 1148-364

(7)

LOT 8

LOT 3

(8)

LOT 7

LOT 4

150.00

S. 33-38-50 W. 150.00

EIP

N. 56-21-10 W. 171.60

171.60

N. 00-33-24 W. 202.96

N. 89-26-32 E. 91.94

91.94

N. 04-15-06 E. 85.53

85.53

N. 04-15-06 E. 85.53

85.53

N. 04-15-06 E. 85.53

85.53

N. 04-15-06 E. 85.53

85.53

N. 04-15-06 E. 85.53

85.53

N. 04-15-06 E. 85.53

85.53

N. 04-15-06 E. 85.53

85.53

N. 04-15-06 E. 85.53

85.53

N. 04-15-06 E. 85.53

85.53

N. 04-15-06 E. 85.53

85.53

N. 04-15-06 E. 85.53

85.53

N. 04-15-06 E. 85.53

85.53

N. 04-15-06 E. 85.53

85.53

N. 04-15-06 E. 85.53

85.53

N. 04-15-06 E. 85.53

85.53

N. 04-15-06 E. 85.53

85.53

N. 04-15-06 E. 85.53

85.53

N. 04-15-06 E. 85.53

85.53

N. 04-15-06 E. 85.53

85.53

N. 04-15-06 E. 85.53

85.53

N. 04-15-06 E. 85.53

85.53

N. 04-15-06 E. 85.53

85.53

N. 04-15-06 E. 85.53

85.53

N. 04-15-06 E. 85.53

85.53

N. 04-15-06 E. 85.53

85.53

N. 04-15-06 E. 85.53

85.53

N. 04-15-06 E. 85.53

85.53

N. 04-15-06 E. 85.53

85.53

N. 04-15-06 E. 85.53

85.53

N. 04-15-06 E. 85.53

85.53

N. 04-15-06 E. 85.53

85.53

N. 04-15-06 E. 85.53

85.53

N. 04-15-06 E. 85.53

85.53

N. 04-15-06 E. 85.53

85.53

N. 04-15-06 E. 85.53

85.53

N. 04-15-06 E. 85.53

85.53

N. 04-15-06 E. 85.53

85.53

N. 04-15-06 E. 85.53

85.53

N. 04-15-06 E. 85.53

85.53

N. 04-15-06 E. 85.53

85.53

N. 04-15-06 E. 85.53

85.53

N. 04-15-06 E. 85.53

85.53

N. 04-15-06 E. 85.53

85.53

N. 04-15-06 E. 85.53

85.53

N. 04-15-06 E. 85.53

85.53

N. 04-15-06 E. 85.53

85.53

N. 04-15-06 E. 85.53

85.53

N. 04-15-06 E. 85.53

85.53

N. 04-15-06 E. 85.53

85.53

N. 04-15-06 E. 85.53

85.53

N. 04-15-06 E. 85.53

85.53

N. 04-15-06 E. 85.53

Prop. R/W 32

S 85-37-02 E

S 4-15-06 W

12.0

12.0

12.0

12.0

12.0

12.0

12.0

12.0

12.0

12.0

12.0

12.0

12.0

12.0

12.0

12.0

12.0

12.0

12.0

12.0

12.0

12.0

12.0

12.0

12.0

12.0

12.0

12.0

12.0

12.0

12.0

12.0

12.0

12.0

12.0

12.0

12.0

12.0

12.0

12.0

12.0

12.0

12.0

12.0

12.0

12.0

12.0

12.0

12.0

12.0

12.0

12.0

12.0

12.0

NOTE: PROPERTY CORNERS NOTED WERE LOCATED BY ACTUAL SURVEY BEARINGS ARE BASED ON DEED BOOK 2747 PAGE 477.

THIS MAP WAS PREPARED FOR THE PURPOSE OF RIGHT OF WAY OR EASEMENT ACQUISITION ONLY, AND IS NOT INTENDED TO BE A BOUNDARY SURVEY OF THE PROPERTY SHOWN

THIS PLAT WAS PREPARED UNDER MY

SUPERVISION *Jack R. Christian*

NCRLS L#2624

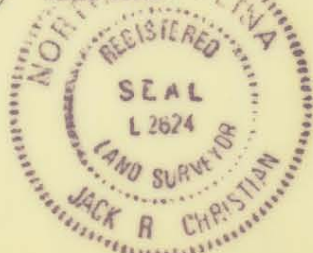

CHARLOTTE ENGINEERING DEPARTMENT

REVISIONS

PROPOSED R/W

JOB NO.

2-5-88 RR ESM'T  
12/10/86 Remote Pile Esm't.  
AS PER CIV L-10-2

CENTRAL AVE. WIDENING

512-84-098  
FILE NO.

PROPERTY OF

SHEET

DRAWN BY *JK*

TPT, INC.

8

CHECKED BY

*R. Dennis Smith*  
SURVEY SUPVR.

DATE NOV. 8, 1985 SCALE 1"=60'

OF

14