

I, R. DENNIS SMITH, CERTIFY THAT THIS PLAT WAS PREPARED UNDER MY SUPERVISION AND THAT THE PLAT WAS PREPARED FOR THE PURPOSE OF ACQUISITION AND EASEMENTS ONLY, AND IS NOT INTENDED TO BE A BOUNDARY SURVEY OF PROPERTY SHOWN.

R. Dennis Smith 3/3/98

R. DENNIS SMITH, NC R.L.S. L-1482 DATE

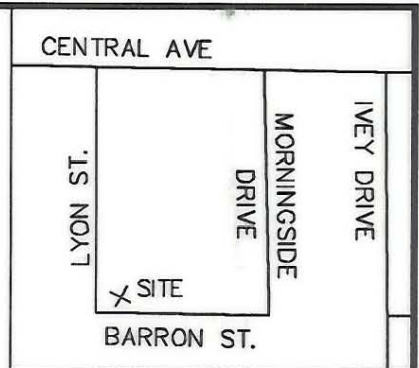
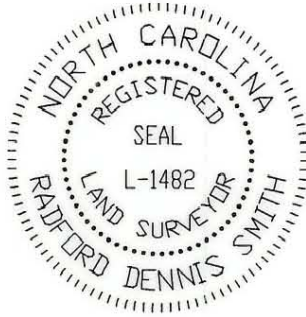

VICINITY MAP
NOT TO SCALE

GRAPHIC SCALE

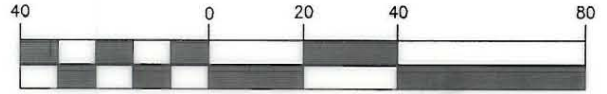

(IN FEET)
1 inch = 40 ft.

NCGS NAD 83 M056
COMBINED GRID
FACTOR .9999047955
N 539232.68
E 1461226.80

NC GRID COORDINATES
N 538905.42
E 1462184.90

S 71°08'29" E
GROUND 1012.45'
GRID 1012.35'

R/W
LYON CT.
RIGHT OF WAY VARIES

OLD R/W S 07°38'46" W
65.00'

129-023-12
PHYLLIS S. BAKER
DEED 2042 0193
1408 LYON CT.

N 82°29'05" W 180.14' TOTAL
166.03'
(180.00')

SEE DETAIL 1
PAGE 2
129-023-13
VERONICA M. NOETLING
DEED 1149 0044
MAP BOOK 4 PAGE 403
BLOCK 5 LOT 15
1404 LYON CT.

N 82°29'05" W (180.00')
164.13'
180.13' TOTAL

129-023-14
SCOTT G. JOHNSON
DEED 8951 0151
1400 LYON CT.

129-023-17
KEVIN MULDOWNEY
DEED 8761-0111
1409 MORNINGSIDE DR.

129-023-16
EARL AMAN
DEED 1426-0117
1405 MORNINGSIDE DR.

129-023-15
FRANCES J. FERGUSON
DEED 7793 0882
1401 MORNINGSIDE DR.

N 82°20'45" W
93.46'

N 82°20'45" W
179.91'

N 07°49'02" E
59.71'

LYON CT.
RIGHT OF WAY VARIES
FORMERLY BARRON ST.

NOTE:

1) BEARINGS AND DISTANCES SHOWN
IN PARENTHESES ARE BASED ON
RECORDED MAP INFORMATION.

2) TOTAL AREA	11,700 SQ.FT.
3) APPARENT RIGHT OF WAY	184 SQ.FT.
4) AREA ACQUIRED	188 SQ.FT.
5) AREA REMAINING	11,328SQ.FT.
6) PERMANENT STORM DRAINAGE EASEMENT	188 SQ.FT.
7) TEMPORARY CONSTRUCTION EASEMENT	372 SQ.FT.

LEGEND

- IRON PIN FOUND
- IRON PIN SET
- MONUMENT
- TEMPORARY CONSTRUCTION EASEMENT
- AREA ACQUIRED
- APPARENT RIGHT OF WAY
- PERMANENT STORM DRAINAGE EASEMENT
- R/W
- RIGHT OF WAY
- LINES SURVEYED
- LINES NOT SURVEYED

PREPARED BY:
CITY OF CHARLOTTE
ENGINEERING DEPARTMENT
600 EAST FOURTH STREET
CHARLOTTE, NC 28208
704-336-2291



CHARLOTTE

ENGINEERING DEPARTMENT

REVISIONS	SIDEWALK PACKAGE #7 LYON CT.	JOB NO.	51296120
		FILE NO.	PLAT1
DRAWN BY GAI	PROPERTY ACQUISITION VERONICA M. NOETLING CHARLOTTE, MECKLENBURG CO., NC	SHEET	1
CHECKED BY		OF	2
SURVEY SUPVR. <i>RDS</i>		DATE 03/03/98	SCALE 1" = 40'