



I, DAVID H. SNIDER, CERTIFY THAT THIS PLAT WAS PREPARED UNDER MY SUPERVISION AND THAT THE PLAT WAS PREPARED FOR THE PURPOSE OF EASEMENTS ONLY, AND IS NOT INTENDED TO BE A BOUNDARY SURVEY OF PROPERTY SHOWN.

*David H. Snider* 6/23/15  
 DAVID H. SNIDER, NC P.L.S. L-2942 DATE

**LEGEND**

- IRON PIN FOUND
- CALCULATED POINT
- LINES SURVEYED
- LINES NOT SURVEYED
- UTILITY EASEMENT

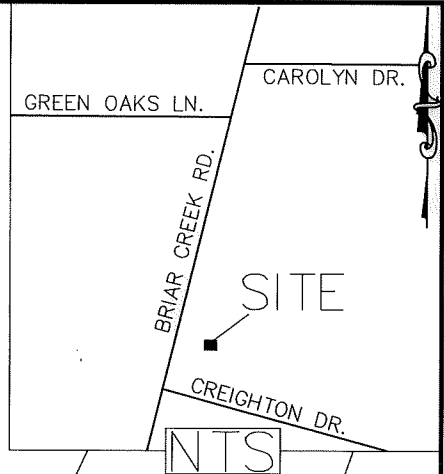

REBAR WITH CAP  
 N: 536795.12  
 E: 1464887.02  
 COMBINED GRID  
 FACTOR=0.999845517

S5°59'28"W 60.55'  
 S5°59'28"W 60.54'(GRID)

129-084-53  
 ELLA L. MCMANUS  
 DB 9647 PG 182  
 1334 BRIAR CREEK RD.

| Line Table |        |             |
|------------|--------|-------------|
| Line #     | Length | Direction   |
| L1         | 2.39   | N60°13'39"W |
| L2         | 16.23  | N45°00'49"E |
| L3         | 2.31   | S44°59'11"E |
| L4         | 15.60  | S45°00'49"W |
| L5         | 151.56 | N60°13'39"W |
| L6         | 49.92  | S25°34'28"W |

S60°13'39"E 428.65'  
 (S60°16'00"E 428.49')

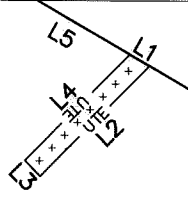

129-084-41  
 PAUL ADAMS BRANTLEY  
 DB 2390 PG 4  
 1201 PATRICIA AV.

129-084-42  
 FRANCES F COVINGTON  
 DB 18263 PG 457  
 1207 PATRICIA AV.

STATE OF NORTH CAROLINA  
 COUNTY OF MECKLENBURG

I, \_\_\_\_\_, REVIEW OFFICER OF MECKLENBURG COUNTY, CERTIFY THAT THE MAP OR PLAT TO WHICH THIS CERTIFICATION IS AFFIXED MEETS ALL STATUTORY REQUIREMENTS FOR RECORDING.

REVIEW OFFICER \_\_\_\_\_ DATE \_\_\_\_\_



CHARLOTTE  
 ENGINEERING & PROPERTY MANAGEMENT DEPARTMENT

|                        |  |                       |
|------------------------|--|-----------------------|
| REVISIONS              | 1338 BRIAR CREEK RD.<br>STORM WATER MAINTENANCE<br>IMPROVEMENT PROJECT   | JOB NO.<br>SWDES00337 |
| SCALE<br>0 1' = 60" 1' | PROPERTY OF<br>THE HAVENS INCORPORATED<br>CHARLOTTE, MECKLENBURG CO., NC | SWDES00337            |
| DRAWN BY P.S.          | CHECKED BY DS  | SHEET<br>1<br>OF<br>1 |
| DATE                   | SURVEY SUPVR. <i>DHS</i>   |                       |

K:\AutoCad\En-su-LD4\SWDES00337 1338 Briar Creek Rd\#2 129-084-09.dwg

129-084-99  
 THE HAVENS INCORPORATED  
 DB 8268 PG 102  
 BRIAR CREEK RD.

129-084-09  
 THE HAVENS INCORPORATED  
 DB 8268 PG 102  
 1200 BRIAR CREEK RD.

129-084-39  
 JOHNNY SCOTT GRIFFIN  
 DB 19998 PG 666  
 1259 PINECREST AV

PREPARED BY:  
 CITY OF CHARLOTTE  
 ENGINEERING & PROPERTY  
 MANAGEMENT DEPARTMENT  
 600 EAST FOURTH STREET  
 CHARLOTTE, NC 28202  
 704-336-2291

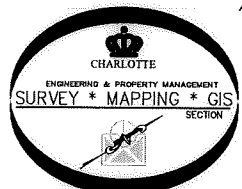

- 1) BEARINGS AND DISTANCES SHOWN IN PARENTHESES ARE BASED ON RECORDED MAP INFORMATION.
- 2) TOTAL AREA 91,449 SQ. FT.
- 3) UTILITY EASEMENT 37 SQ. FT.
- 4) AREA REMAINING 91,449 SQ. FT.

ACQUISITION BY DB 30426 PG 977