

GARLAND WALLER
 PARCEL ID# 13104227
 DB 18833 /PG 199
 LOT 70, WINTERFIELD,
 SECTION THREE
 MB 11 /PG 113
 3801 WINTERFIELD PLACE

LOT 71

LOT 69

WINTERFIELD PLACE
 50' PUBLIC R/W

LOT 88
 WINTERFIELD,
 SECTION THREE
 MB 11 /PG 113

HASSAN HASHEMLOO
 PARCEL ID# 13105114
 DB 27597 /PG 704
 LOT 89, WINTERFIELD,
 SECTION THREE
 MB 11 /PG 113
 3800 WINTERFIELD PLACE

COPPER GREENBRYRE
 HOLDINGS LLC
 PARCEL ID# 13105133
 DB 27746 /PG 844

RAFAEL ANTONIO CRUZ
 PARCEL ID# 13105115
 DB 28777 /PG 858
 LOT 101, WINTERFIELD,
 SECTION THREE
 MB 11 /PG 113
 3716 WINTERFIELD PLACE

UNAMED STREET
 50' PUBLIC R/W

PFALZGRAF COMMUNITIES 8 LLC
 PARCEL ID# 13105135
 DB 29226 /PG 953

20' R/W
 MB 11 /PG 113

10' SSRW

CURVE	RADIUS	ARC	CHORD BEARING	CHORD
C1	20.00'	31.95'	N00°45'09"W	28.66'
(C1)	(20.00')	(31.95')	(N00°45'09"W)	(28.66')

I, _____ REVIEW OFFICER OF MECKLENBURG COUNTY, CERTIFY THAT THE MAP OR PLAT TO WHICH THIS CERTIFICATION IS AFFIXED MEETS ALL STATUTORY REQUIREMENTS OF NORTH CAROLINA GENERAL STATUTES FOR RECORDING.

REVIEW OFFICER _____

DATE _____

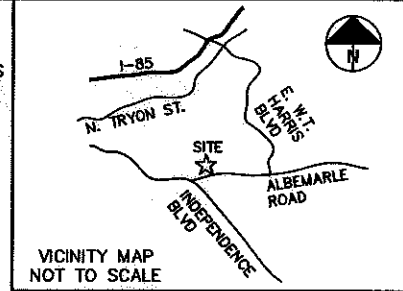

LEGEND

TCE = TEMPORARY CONSTRUCTION EASEMENT

SDE = STORM DRAINAGE EASEMENT

[Pattern] = TCE

[Pattern] = SDE

[Line] = SDE

[Line] = TCE

[Line] = EXISTING R/W

[Symbol] = IRON PIN FOUND

I, CHARLES J. DUNBAR, CERTIFY THAT THIS PLAT WAS PREPARED UNDER MY SUPERVISION AND THAT THIS PLAT WAS PREPARED FOR THE PURPOSE OF EASEMENTS ONLY, AND IS NOT INTENDED TO BE A BOUNDARY SURVEY OF PROPERTY SHOWN.

CHARLES J. DUNBAR NC PLS L-4159
 DUNBAR GEOMATICS GROUP, PLLC
 P.O. BOX 3053
 HUNTERSVILLE, NC 28070-3053
 NC LIC. NO. P-0865

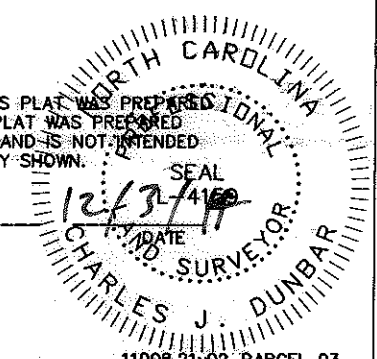

NOTE:

- 1) BEARINGS AND DISTANCES SHOWN IN PARENTHESES ARE BASED ON RECORDED MAP OR DEED INFORMATION.
- 2) TOTAL AREA: 10,858 S.F., 0.249 AC.
- 3) AREA IN TCE: 558 S.F., 0.013 AC.
- 4) AREA IN SDE: 416 S.F., 0.010 AC.
- 5) AREA OF EXIST R/W & SDE OVERLAP: 309 S.F., 0.007 AC.
- 6) FEE AREA REMAINING: 10,858 S.F., 0.249 AC.

Plans Prepared By:
ATKINS 5200 77 CENTER DRIVE, SUITE 500
 CHARLOTTE, NORTH CAROLINA 28217
 (704) 522-7275 NCCOA: F-0326

NC GRID NAD 83/2011

CHARLOTTE ENGINEERING DEPARTMENT		
REVISIONS CORRECT ADJOINER DEED BOOK 12/3/14	SWS WINTERFIELD PLACE 3721	JOB NO. 671-14-014
SCALE 1" = 40' 	PROPERTY ACQUISITION OWNER: HASSAN HASHEMLOO	FILE NO. PARCEL 03
DRAWN BY: GHL	CHARLOTTE, MECKLENBURG CO., NC	SHEET 1
DATE: 11/24/2014	CHECKED BY: CJD	SURVEY SUPVR.: RGG
		OF 1

ACQUISITION BY DEED 29731-5