

IP is 471.83' Measured North-westerly along the Northern Margin of the 60' Idlewild Rd R/W to the Easterly Margin of the Idlebrook Dr. R/W

THOMAS & MINNIE EDWARDS
TAX CODE 133-211-15
DEED 1300-420

ASSOC. REFORMED PRES. 1.61'
CHURCH GEN. SYNOD
TAX CODE 133-211-14
DEED 3214-135
3357-076

DETAIL A
SCALE 1" = 20'

THOMAS & MINNIE EDWARDS
TAX CODE 133-211-21
DEED 4947-522

TOTAL AREA (BY DEED) 36,248 SF
UTILITY EASEMENT 165 SF

AREA TO BE ACQUIRED 1,364 SF
AREA REMAINING 34,884 SF

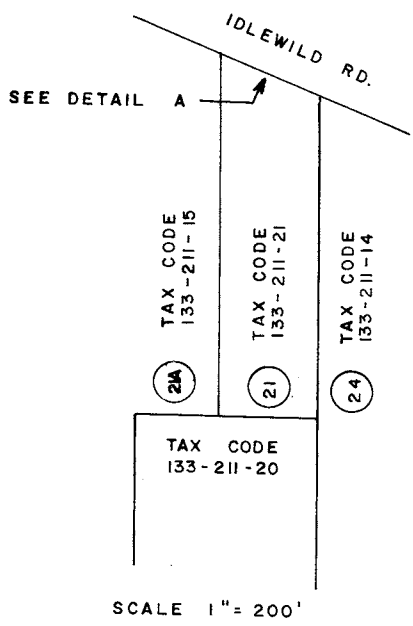

ACQUISITION BY CITY
RECORDED IN DEED BOOK
6180-0962
DATE 12/29/89

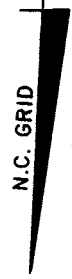

This map was prepared for the purpose of fee simple, right of way or easement acquisition only, and is not intended to be a boundary survey of the property shown.

NOTE: Bearings and distances shown in parenthesis are based on deed information.

This plat was prepared under my supervision

Henry [Signature]

NC Regl. Surveyor No. L-3015

I. CONSTR. EASEMENT

		JOB NO. 512-85
CHARLOTTE ENGINEERING DEPARTMENT		-127
REVISIONS 1. 5/16/89 2. 6/23/89 ADJ. PARCEL NO.	IDLEWILD ROAD WIDENING	FILE NO.
DRAWN BY EDW CHECKED BY JAT	PROPERTY OF THOMAS & MINNIE EDWARDS	SHEET 21
DATE FEB. 1989	SCALE AS SHOWN	OF

133-211