

NC GRID NAD '83

STATE OF NORTH CAROLINA
COUNTY OF MECKLENBURG

I, _____, REVIEW OFFICER
OF MECKLENBURG COUNTY, CERTIFY THAT
THE MAP OR PLAT TO WHICH THIS
CERTIFICATION IS AFFIXED MEETS ALL
STATUTORY REQUIREMENTS FOR RECORDING.

REVIEW OFFICER
DATE

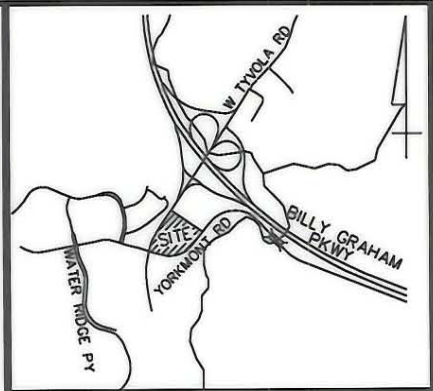

VICINITY MAP (NOT TO SCALE)

SPIRAL TABLE			
SP1	193.78	1193.24	N 32°47'34" E 193.72'
SP2	192.56	1193.24	S 32°47'51" W 192.51'

SLOPE EASEMENT DETAIL

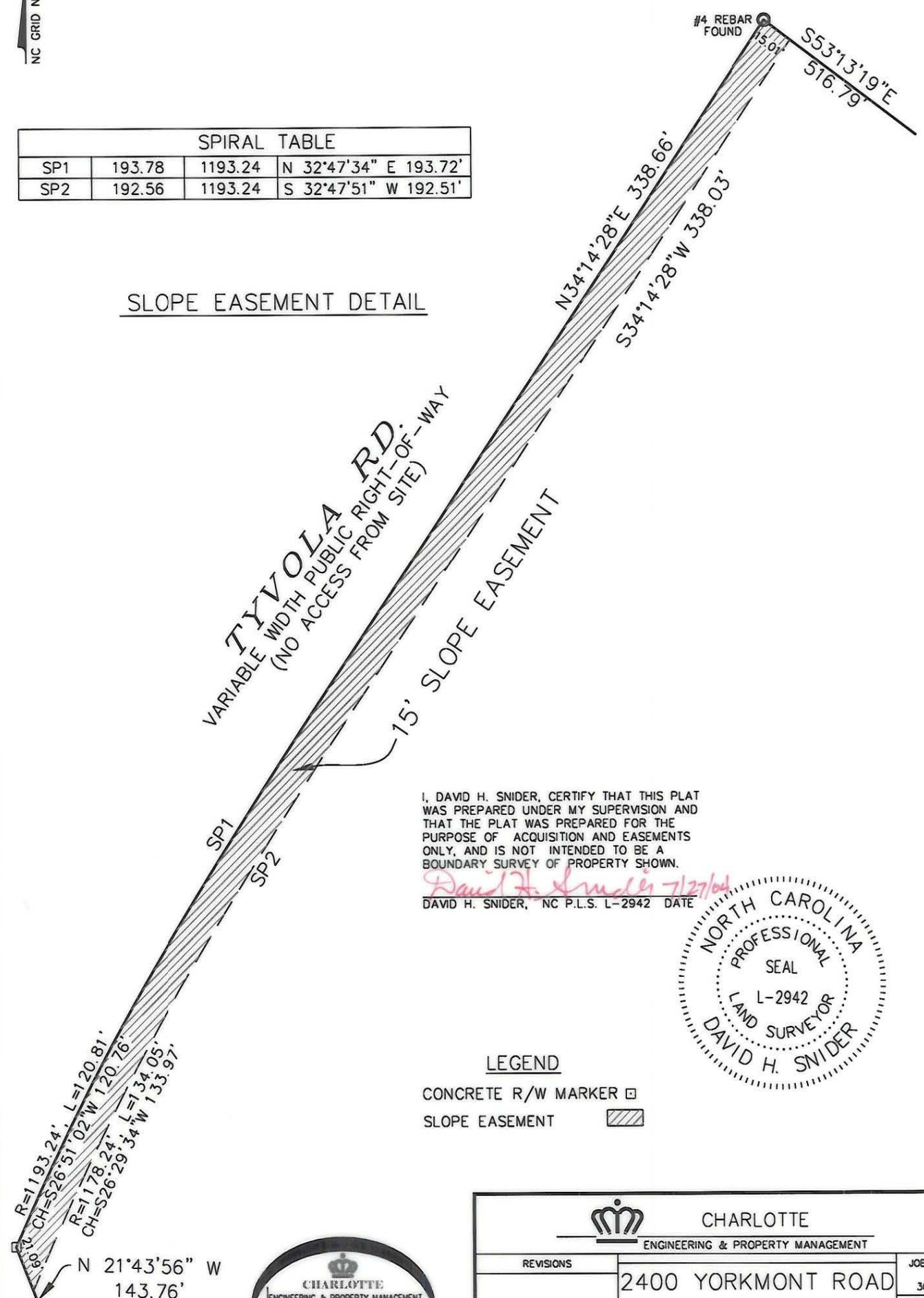

I, DAVID H. SNIDER, CERTIFY THAT THIS PLAT
WAS PREPARED UNDER MY SUPERVISION AND
THAT THE PLAT WAS PREPARED FOR THE
PURPOSE OF ACQUISITION AND EASEMENTS
ONLY, AND IS NOT INTENDED TO BE A
BOUNDARY SURVEY OF PROPERTY SHOWN.

David H. Snider 7/27/04
DAVID H. SNIDER, NC P.L.S. L-2942 DATE

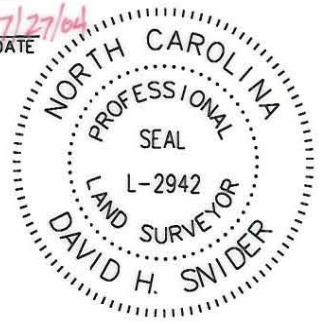

LEGEND

- CONCRETE R/W MARKER
- SLOPE EASEMENT

PREPARED BY:
CITY OF CHARLOTTE
ENGINEERING & PROPERTY
MANAGEMENT
600 EAST FOURTH STREET
CHARLOTTE, NC 28202
704-336-2291

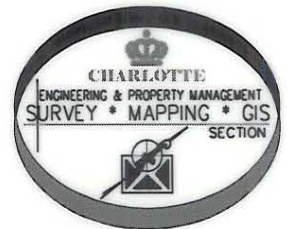

REVISIONS		JOB NO.
1-SAA-7/27/04 OWNER, NOTES		30849
SCALE 1" = 60'		FILE NO.
DRAWN BY SAA		ESMTPLATS
DATE 7/13/04		SHEET
CHECKED BY		OF
SURVEY SUPR. <i>JS</i>		3



CHARLOTTE

ENGINEERING & PROPERTY MANAGEMENT

2400 YORKMONT ROAD
TAX PARCEL# 143-273-01

EASEMENT ACQUISITION
OWNER: COLISEUM GROUND TWO, INC.

CHARLOTTE, MECKLENBURG CO., NC