

ACQUISITION BY DB 25748 PG 285-288

I, _____ REVIEW OFFICER OF MECKLENBURG COUNTY, CERTIFY THAT THE MAP OR PLAT TO WHICH THIS CERTIFICATION IS AFFIXED MEETS ALL STATUTORY REQUIREMENTS OF NORTH CAROLINA GENERAL STATUTES FOR RECORDING.

REVIEW OFFICER _____ DATE _____

LINE TABLE		
LINE	LENGTH	BEARING
L1	5.05	N89°35'34"W
L2	18.37	N00°24'26"E
L3	8.34	S32°21'57"E
L4	11.37	S02°17'22"E

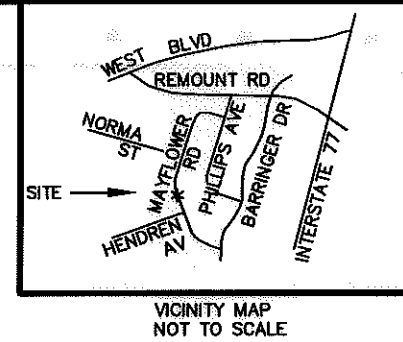
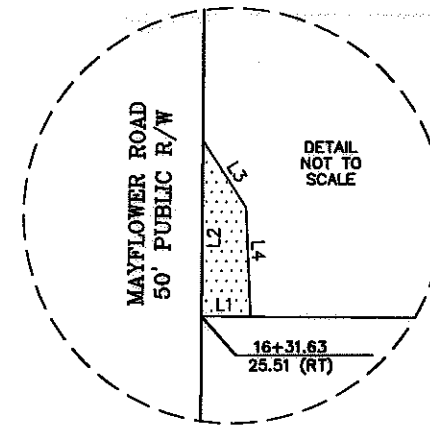

LEGEND

TCE = TEMPORARY CONSTRUCTION EASEMENT

- = TCE
- = TCE
- = EXISTING R/W
- = IRON PIN FOUND

53
TAX # 14504316
BILLY J CRAIG, LULA USHER,
DAVID L CRAIG, TECORA CRAIG
AND ALFREDA FALLS
DB 20384, PG 153
LOT 11, BLOCK 5
MB 6, PG 3
2842 MAYFLOWER ROAD

51
TAX # 14504315
TIMON KEITH MITCHELL
DB 10954, PG 883
LOT 12, BLOCK 5
MB 6, PG 3
2848 MAYFLOWER ROAD

49
TAX # 14504314
ISSAC JOHN WALLACE
DB 4789, PG 191
LOT 13, BLOCK 5
MB 6, PG 3
2854 MAYFLOWER ROAD

TAX # 14504415
REGINALD S. RORIE
DB 18915, PG 217
LOT 30, BLK 2
MB 6, PG 3
2839 MAYFLOWER ROAD

52
TAX # 14504416
R.M. EQUITIES, L.L.C.
DB 24059, PG 185
LOT 29, BLK 2
MB 6, PG 3
2845 MAYFLOWER ROAD

50
TAX # 14504417
BRANCH BANKING AND
TRUST COMPANY
DB 25141, PG 957
LOT 28, BLK 2
MB 6, PG 3
2851 MAYFLOWER ROAD

6
TAX # 14504433
MICHAEL I. MYERS AND
SOPHIA Z. MYERS
DB 22082, PG 117
LOT 12, BLK 2
MB 6, PG 3
2816 PHILLIPS AVENUE

5
TAX # 14504432
TOMMY DELANO REID
DB 3135, PG 393
LOT 13, BLK 2
MB 6, PG 3
2820 PHILLIPS AVENUE

NOTE:

- 1) BEARINGS AND DISTANCES SHOWN IN PARENTHESES ARE BASED ON RECORDED MAP OR DEED INFORMATION.
- 2) TOTAL AREA: 12,303 SF; 0.282 AC
- 3) AREA IN TCE: 70 SF; 0.002 AC
- 4) FEE AREA REMAINING: 12,303 SF; 0.282 AC

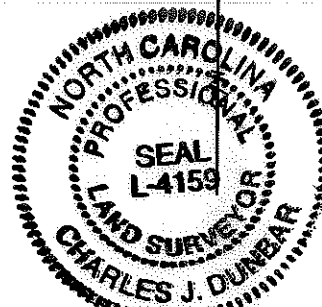

I, CHARLES J. DUNBAR, CERTIFY THAT THIS PLAT WAS PREPARED UNDER MY SUPERVISION AND THAT THIS PLAT WAS PREPARED FOR THE PURPOSE OF EASEMENTS ONLY, AND IS NOT INTENDED TO BE A BOUNDARY SURVEY OF PROPERTY SHOWN.

CHARLES J. DUNBAR NC PLS L-4159

DATE/



Plans Prepared By:
5200 77 CENTER DRIVE, SUITE 500
CHARLOTTE, NORTH CAROLINA 28217
(704) 522-7275 NCCOA: F-0326

[Signature] 3/30/10

CHARLOTTE ENGINEERING DEPARTMENT		JOB NO. 512-07-035
REVOLUTION PARK NIP		FILE NO. PARCEL 52
PROPERTY ACQUISITION OWNER: R.M. EQUITIES, L.L.C. CHARLOTTE, MECKLENBURG CO., NC		SHEET 1 OF 1
REVISIONS	DATE: 03-30-2010	CHECKED BY: CJD SURVEY SUPVR.: CJD
0" SCALE 1" = 40' 40'		
DRAWN BY: TTB		

NC GRID NAD 83/2007

100004583v01_PARCEL 52