

51  
 TAX # 14504315  
 TIMON KEITH MITCHELL  
 DB 10954, PG 883  
 LOT 12, BLOCK 5  
 MB 6, PG 3  
 2848 MAYFLOWER ROAD

49  
 TAX # 14504314  
 ISSAC JOHN WALLACE  
 DB 4789, PG 191  
 LOT 13, BLOCK 5  
 MB 6, PG 3  
 2854 MAYFLOWER ROAD

47  
 TAX # 14504313  
 REGINALD EUGENE WESTBROOK  
 AND  
 CONSTANCE BAILEY WESTBROOK  
 DB 17592, PG 393  
 LOT 14, BLOCK 5  
 MB 6, PG 3  
 2860 MAYFLOWER ROAD

52  
 TAX # 14504416  
 R.M. EQUITIES, L.L.C.  
 DB 24059, PG 185  
 LOT 29, BLK 2  
 MB 6, PG 3  
 2845 MAYFLOWER ROAD  
 (S 88°38'30" E 192.61'  
 S 89°35'34" E 192.62' TOTAL

50  
 TAX # 14504417  
 KAI TRONG DO AND  
 THANH-MAI THI MAI  
 DB 25312, PG 781  
 LOT 28, BLK 2  
 MB 6, PG 3  
 2851 MAYFLOWER ROAD  
 (S 05°27'04" E 65.34'  
 S 04°30'00" E 65.34')

48  
 TAX # 14504418  
 GEORGIA F. KENNEDY  
 DB 6192, PG 746  
 LOT 27, BLK 2  
 MB 6, PG 3  
 2857 MAYFLOWER ROAD  
 (N 89°35'34" W 199.29'  
 N 88°38'30" W 199.28')

6  
 TAX # 14504433  
 MICHAEL I. MYERS AND  
 SOPHIA Z. MYERS  
 DB 22082, PG 117  
 LOT 12, BLK 2  
 MB 6, PG 3  
 2816 PHILLIPS AVENUE

5  
 TAX # 14504432  
 TOMMY DELANO REID  
 DB 3135, PG 393  
 LOT 13, BLK 2  
 MB 6, PG 3  
 2820 PHILLIPS AVENUE

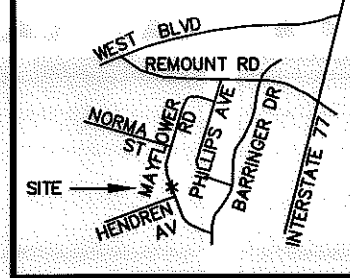

VICINITY MAP  
 NOT TO SCALE

- NOTE:
- 1) BEARINGS AND DISTANCES SHOWN IN PARENTHESES ARE BASED ON RECORDED MAP OR DEED INFORMATION.
  - 2) TOTAL AREA: 12,737 SF, 0.292 AC
  - 3) AREA IN TCE: 352 SF, 0.008 AC
  - 4) AREA IN SDE: 96 SF, 0.002 AC
  - 5) FEE AREA REMAINING: 12,737 SF, 0.292 AC

LEGEND

- TCE = TEMPORARY CONSTRUCTION EASEMENT
- SDE = PERMANENT STORM DRAINAGE EASEMENT
- [Pattern] = SDE
- [Pattern] = TCE
- [Symbol] = TCE
- [Symbol] = EXISTING R/W
- [Symbol] = SDE
- [Symbol] = IRON PIN FOUND

LINE TABLE		
LINE	LENGTH	BEARING
L1	11.34	N89°35'34"W
L2	20.87	N00°24'26"E
L3	15.00	N00°24'26"E
L4	29.13	N00°24'26"E
L5	5.05	S89°35'34"E
L6	29.18	S02°17'22"E
L7	15.00	S00°32'16"W
L8	21.44	S12°57'02"E
L9	6.39	N89°27'53"W
L10	6.42	N89°27'53"W

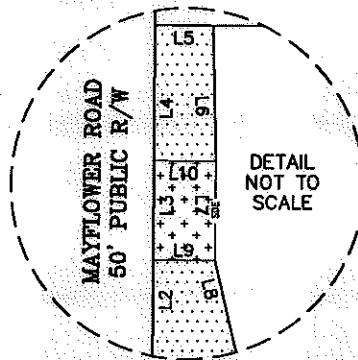

ACQUISITION BY DB 25814 PG 53

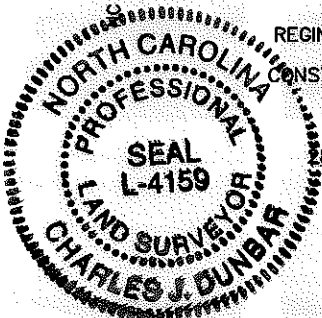

I, CHARLES J. DUNBAR, CERTIFY THAT THIS PLAT WAS PREPARED UNDER MY SUPERVISION AND THAT THIS PLAT WAS PREPARED FOR THE PURPOSE OF EASEMENTS ONLY, AND IS NOT INTENDED TO BE A BOUNDARY SURVEY OF PROPERTY SHOWN.

CHARLES J. DUNBAR NC PLS L-4159 3/30/10 DATE

REVIEW OFFICER OF MECKLENBURG COUNTY, CERTIFY THAT THE MAP OR PLAT TO WHICH THIS CERTIFICATION IS AFFIXED MEETS ALL STATUTORY REQUIREMENTS OF NORTH CAROLINA GENERAL STATUTES FOR RECORDING.

REVIEW OFFICER \_\_\_\_\_ DATE \_\_\_\_\_

100004583v01\_PARCEL 50



REVISIONS		JOB NO. 512-07-035
0" SCALE 1" = 40' 40"		FILE NO. PARCEL 50
DRAWN BY: TTB		SHEET 1
DATE: 03-30-2010		OF 1
CHECKED BY: CJD		SURVEY SUPVR.: CJD



Plans Prepared By:  
 5200 77 CENTER DRIVE, SUITE 500  
 CHARLOTTE, NORTH CAROLINA 28217  
 (704) 522-7275 NCCOA: F-0326