

I, KENNETH M. GREEN, CERTIFY THAT THIS PLAT WAS PREPARED UNDER MY SUPERVISION AND THAT THE PLAT WAS PERPARED FOR THE PURPOSE OF EASEMENT ACQUISITION ONLY, AND IS NOT INTENDED TO BE A BOUNDARY SURVEY OF THE PROPERTY SHOWN HEREON.

N/F
BOYD P. FALLS &
MAXINE G. FALLS
DB 10592/PG 588
147-097-81

I, _____ REVIEW OFFICER OF MECKLENBURG COUNTY CERTIFY THAT THE MAP OR PLAT TO WHICH THIS CERTIFICATION IS AFFIXED MEETS ALL STATUTORY REQUIREMENTS FOR RECORDING.

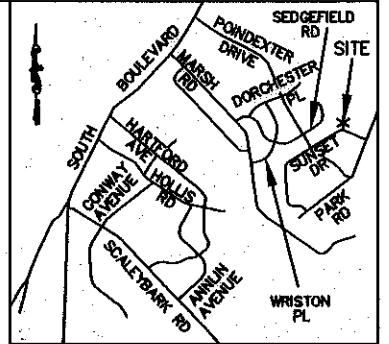

KENNETH M. GREEN, PLS
L-3512

REVIEW OFFICER _____ DATE _____

N/F
AUBREY KEEN
DB 24926/PG 430
147-095-38

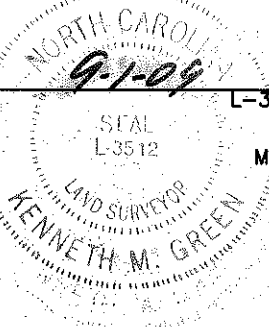

N/F
MARGARET M. WOODWARD &
DONNA HINTSON
DB 24021/PG 619
147-095-03

NCGS MONUMENT
'COVER'
NC GRID COORDS
(NAD '83)
N=525,634.068
E=1,436,565.938

N/F
PHILIP F. HOWERTON, JR. &
MARY HOWERTON
DB 8512/PG 541
147-095-24

N/F
JAMES E. HATLEY
DB 7724/PG 799
147-095-23

N/F
PHILIP F. HOWERTON, JR. &
MARY HOWERTON
DB 7682/PG 685
147-095-39

NOTES:
BEARINGS AND DISTANCES SHOWN IN PARENTHESIS ARE BASED ON RECORDED MAP INFORMATION.
THIS PROPERTY MAY BE SUBJECT TO OTHER EASEMENTS EITHER RECORDED OR IMPLIED.
BOUNDARY INFORMATION TAKEN FROM COMPILED MECKLENBURG CO. PUBLIC RECORD INFORMATION.

- LEGEND:
- - IRON PIPE FOUND (IPF)
 - △ - MONUMENT FOUND
 - - PROPERTY LINE
 - R/W- - R/W LINE
 - e- - TEMPORARY CONSTRUCTION EASEMENT (TCE)
 - [Dotted Box] - TCE HATCH
 - - - - ADJOINER

PREPARED BY:

R. Joe Harris & Associates, P.L.L.C.

Engineering & Land Surveying
1698 W. HWY 160, SUITE 130, FORT MILL, SC, 29708
Phone: (803) 802-1799

19,750 SF TOTAL AREA BY PLAT
146 SF IN TEMP CONST ESMT
19,750 SF REMAINING

25186-183
10-30-09

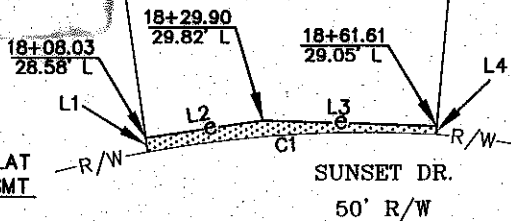

| CURVE TABLE | | | | | | |
|-------------|---------|----------|-------|-------|-------------|-----------|
| CURVE | LENGTH | RADIUS | TANG | CHORD | BEARING | DELTA |
| C1 | 59.79 | 247.84 | 30.04 | 59.64 | S86°23'30"W | 13°49'22" |
| (C1) | (59.88) | (247.84) | | | | |

| LINE TABLE | | |
|------------|--------|-------------|
| LINE | LENGTH | BEARING |
| L1 | 2.93 | N08°16'12"W |
| L2 | 24.38 | N81°18'12"E |
| L3 | 35.93 | S88°07'20"E |
| L4 | 1.68 | S05°02'04"W |

GRAPHIC SCALE



(IN FEET)
1 inch = 40 ft.

RJH PROJ. #1341.05

| | | |
|---|--|--|
| <p>CHARLOTTE ENGINEERING & PROPERTY MANAGEMENT</p> | <p>EASEMENT ACQUISITION COLONIAL VILLAGE - SEDFIELD NEIGHBORHOOD IMPROVEMENTS</p> | |
| | <p>PROPERTY OF PHILIP F. HOWERTON, JR. & MARY HOWERTON 2816 SUNSET DR. CHARLOTTE, NC 28209 PID #147-095-24</p> | |
| <p>512-07-032 JOB NO.</p> | <p>1" = 40' SCALE</p> | <p>PARCEL 63.DWG CAD FILE NAME</p> |
| <p>JSS PREPARED BY</p> | <p>08/25/09 DATE</p> | <p>SHEET 1</p> <p>OF 1</p> |