

I, JACKIE W. BRIM, CERTIFY THAT THIS PLAT WAS PREPARED UNDER MY SUPERVISION AND THAT THE PLAT WAS PREPARED FOR THE PURPOSE OF EASEMENTS ONLY, AND IS NOT INTENDED TO BE A BOUNDARY SURVEY OF PROPERTY SHOWN.

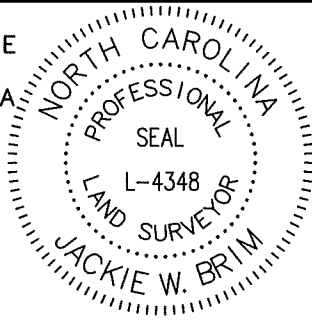

Jackie W. Brim 6-11-2018

JACKIE W. BRIM, NC P.L.S. L-4348 DATE

STATE OF NORTH CAROLINA
COUNTY OF MECKLENBURG

I, _____, REVIEW OFFICER OF MECKLENBURG COUNTY, CERTIFY THAT THE MAP OR PLAT TO WHICH THIS CERTIFICATION IS AFFIXED MEETS ALL STATUTORY REQUIREMENTS FOR RECORDING.

REVIEW OFFICER _____ DATE _____

(15)
149-203-75
NOW OR FORMERLY
DENISE G. HEARNE
MB 7 PG 753
DB 5721 PG 385
1134 Heather Ln.

(16)
149-203-74
NOW OR FORMERLY
CLAIRE HOOVER MORRISON, TRUSTEE
OF CLAIRE HOOVER MORRISON LIVING TRUST
MB 7 PG 753
DB 28969 PG 314
1200 Heather Ln.

149-203-73
CHERRIL TANOUE
MB 7 PG 753
DB 28197 PG 400
1212 Heather Ln.

Curve Table				
Curve #	Length	Radius	CHORD BEARING	CHORD
C1	25.20	1041.94	N19°00'42"W	25.20
C2	26.90	1041.94	N17°34'45"W	26.90
C3	14.03	1041.94	N16°27'14"W	14.03
C4	31.89	1041.94	N15°11'30"W	31.89

- NOTE:
- BEARINGS AND DISTANCES SHOWN IN PARENTHESES ARE BASED ON RECORDED MAP INFORMATION.
 - TOTAL AREA 18,756 SQ. FT.
 - BEARINGS AND DISTANCES ARE BASED ON US SURVEY FEET
 - TEMP CONSTRUCTION EASEMENT 404 SQ. FT.
 - PERMANENT EASEMENT FOR STORM DRAINAGE DB 10631 PG 57
 - AREA REMAINING 18,756 SQ. FT.

149-203-04
GREGORY EDWARD II SOULE
SARAH NOONAN SOULE
TRUST IN SOULE WE
MB 6 PG 849
DB 30721 PG 896
4221 Waterbury Dr.

PREPARED BY:
CITY OF CHARLOTTE
ENGINEERING & PROPERTY
MANAGEMENT DEPARTMENT
600 EAST FOURTH STREET
CHARLOTTE, NC 28202
704-336-2291

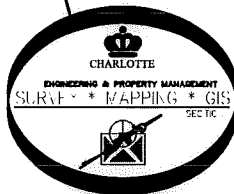

Line Table		
Line #	Length	Direction
L1	19.27	S12°20'13"E
L2	12.72	N70°18'55"E
L3	16.08	S87°25'33"E
L4	6.79	N74°12'48"E
L5	13.93	S15°29'31"E
L6	6.55	S73°21'42"W

CHARLOTTE
ENGINEERING & PROPERTY MANAGEMENT DEPARTMENT

ASHBROOK NEIGHBORHOOD SIDEWALK	JOB NO. 512-16-046
PROPERTY OF NOW OR FORMERLY CLAIRE HOOVER MORRISON, TRUSTEE OF CLAIRE HOOVER MORRISON LIVING TRUST CHARLOTTE, MECKLENBURG CO., NC	216046
DRAWN BY P.S.	SHEET 1
DATE _____	OF 1
CHECKED BY JB SURVEY SUPVR.	

K:\AutoCad\En_su-LD4\216046 Heather_Paddock Sidewalk (Ashbrook Neighborhood)#16 149-203-74

HOUGH RD.
(60' RIGHT-OF-WAY)
PER MB 7 PG 753

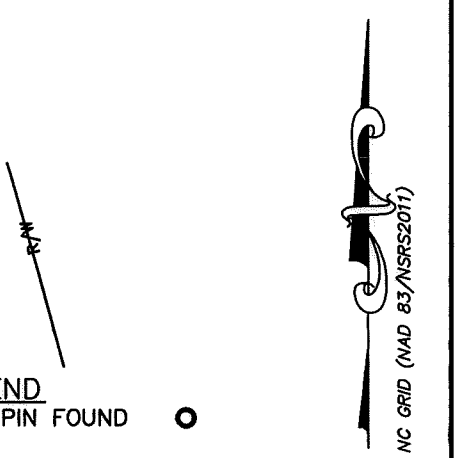
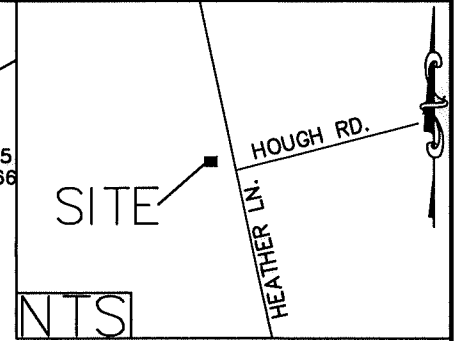

- LEGEND**
- IRON PIN FOUND ○
 - CALCULATED POINT ●
 - LINES SURVEYED _____
 - LINES NOT SURVEYED - - - - -
 - RIGHT-OF-WAY R/W
 - TEMP. CONSTRUCTION EASEMENT [Pattern]