

I, JACKIE W. BRIM, CERTIFY THAT THIS PLAT WAS PREPARED UNDER MY SUPERVISION AND THAT THE PLAT WAS PREPARED FOR THE PURPOSE OF EASEMENTS ONLY, AND IS NOT INTENDED TO BE A BOUNDARY SURVEY OF PROPERTY SHOWN.

Jackie W. Brim 11-15-2017
 JACKIE W. BRIM, NC P.L.S. L-4348 DATE

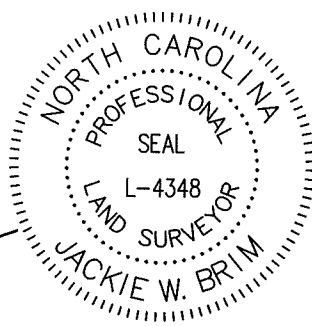

STATE OF NORTH CAROLINA
 COUNTY OF MECKLENBURG

I, _____, REVIEW OFFICER OF MECKLENBURG COUNTY, CERTIFY THAT THE MAP OR PLAT TO WHICH THIS CERTIFICATION IS AFFIXED MEETS ALL STATUTORY REQUIREMENTS FOR RECORDING.

REVIEW OFFICER _____

DATE _____

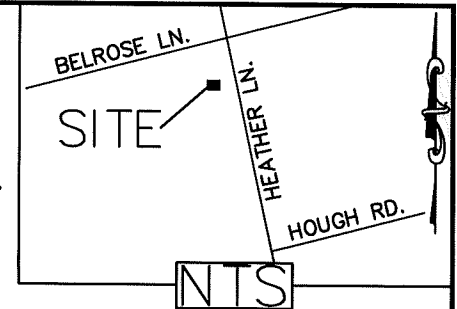

BELROSE LN.
 (60' RIGHT-OF-WAY)
 PER MB 7 PG 753

N71°09'25"E 118.96'
 (N70°07'30"E 118.55')

HEATHER LN.
 (60' RIGHT-OF-WAY)
 PER MB 9 PG 277

149-203-76
 NOW OR FORMERLY
 WILLIAM JOHN JR PICKUP
 LEIGH ANNE PICKUP
 MB 7 PG 753
 DB 17996 PG 175
 1126 Heather Ln.

149-196-10
 GUS MIHELAKIS
 ZOE MIHELAKIS
 MB 7 PG 753
 DB 3900 PG 242
 4118 Hough Rd.

LEGEND

- IRON PIN FOUND ○
- CALCULATED POINT ●
- LINES SURVEYED _____
- LINES NOT SURVEYED - - - - -
- RIGHT-OF-WAY — R/W —
- TEMP. CONSTRUCTION EASEMENT [Pattern]
- STORM DRAINAGE EASEMENT [Pattern]
- EXISTING STORM DRAIN EASEMENT TO BE ACCEPTED BY THE CITY AS STORM DRAINAGE EASEMENT [Pattern]
- UTILITY EASEMENT [Pattern]

COMBINED GRID
 FACTOR=0.999847152
 N: 524122.37
 E: 1445385.56

N: 524031.88
 E: 1445422.89

149-203-75
 NOW OR FORMERLY
 DENISE G. HEARNE
 MB 7 PG 753
 DB 5721 PG 385
 1134 Heather Ln.

HOUGH RD.
 (60' RIGHT-OF-WAY VARIES)
 PER MB 7 PG 753

NC GRID (NAD 83/NSRS2011)

149-203-01
 WESLEY M. SCOTT
 DONNA S. SCOTT
 MB 6 PG 849
 DB 27619 PG 694
 4201 Waterbury Dr.

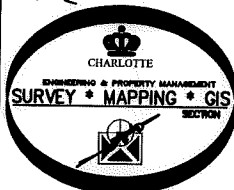

PREPARED BY:
 CITY OF CHARLOTTE
 ENGINEERING & PROPERTY
 MANAGEMENT DEPARTMENT
 600 EAST FOURTH STREET
 CHARLOTTE, NC 28202
 704-336-2291

149-203-02
 KEVIN B MCNEILL
 PUJA V GOMES
 MB 6 PG 849
 DB 30092 PG 158
 4209 Waterbury Dr.

NOTE:

- 1) BEARINGS AND DISTANCES SHOWN IN PARENTHESES ARE BASED ON RECORDED MAP INFORMATION.
- 2) TOTAL AREA 19,392 SQ. FT.
- 3) TEMP CONSTRUCTION EASEMENT 4,296 SQ. FT.
- 4) STORM DRAINAGE EASEMENT 1,376 SQ. FT.
- 5) EXISTING STORM DRAIN EASEMENT TO BE ACCEPTED BY THE CITY AS STORM DRAINAGE EASEMENT 1,004 SQ. FT.
- 6) UTILITY EASEMENT 497 SQ. FT.
- 7) AREA REMAINING 19,392 SQ. FT.

EXISTING STORM DRAINAGE EASEMENT
 1,004 SQ. FT.

CHARLOTTE ENGINEERING & PROPERTY MANAGEMENT DEPARTMENT		
REVISIONS	HOUGH ROAD STORMWATER IMPROVEMENT PROJECT	JOB NO. SWDES00597
	PROPERTY OF NOW OR FORMERLY WILLIAM JOHN JR PICKUP LEIGH ANNE PICKUP CHARLOTTE, MECKLENBURG CO., NC	SWDES00597
SCALE 1"=30'		SHEET 1
DRAWN BY P.S.		OF 2
DATE	CHECKED BY JB SURVEY SUPVR.	

K:\AutoCad\En_su-LD4\SWDES00597 SWS Hough Rd.4118\#2 149-203-76

DB 32648-436

I, JACKIE W. BRIM, CERTIFY THAT THIS PLAT WAS PREPARED UNDER MY SUPERVISION AND THAT THE PLAT WAS PREPARED FOR THE PURPOSE OF EASEMENTS ONLY, AND IS NOT INTENDED TO BE A BOUNDARY SURVEY OF PROPERTY SHOWN.

Jackie W. Brim 11-15-2017
 JACKIE W. BRIM, NC P.L.S. L-4348 DATE

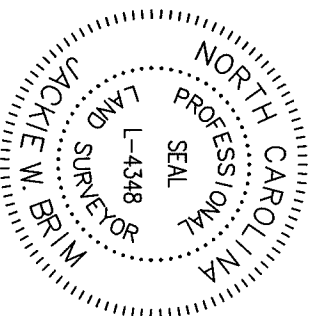

Curve Table				
Curve #	Length	Radius	CHORD BEARING	CHORD
C1	15.35	1041.94	N26°42'13"W	15.35
C2	6.99	1041.94	N25°48'53"W	6.99
C3	5.51	1041.94	N25°28'15"W	5.51
C4	47.24	1041.94	N28°25'28"W	47.24
C5	27.67	20.00	N69°12'14"W	25.52
C6	46.61	184.25	N78°24'15"E	46.49
C7	5.00	1041.94	N26°08'39"W	5.00

Line Table			
Line #	Length	Direction	
L1	5.07	N15°39'55"W	
L2	7.60	N15°39'55"W	
L3	32.02	N15°39'55"W	
L4	27.14	N15°39'55"W	
L5	113.51	N64°46'27"E	
L6	23.31	S25°30'31"E	
L7	24.98	N64°53'12"E	
L8	10.00	N25°14'22"W	
L9	44.93	N62°52'28"E	
L10	99.52	N64°57'53"E	
L11	190.64	N64°48'41"E	
L12	89.78	N64°57'53"E	
L13	5.00	N25°02'07"W	
L14	99.52	N64°57'53"E	

STATE OF NORTH CAROLINA
 COUNTY OF MECKLENBURG

REVIEW OFFICER OF MECKLENBURG COUNTY, CERTIFY THAT THE MAP OR PLAT TO WHICH THIS CERTIFICATION IS AFFIXED MEETS ALL STATUTORY REQUIREMENTS FOR RECORDING.

REVIEW OFFICER _____ DATE _____

PREPARED BY:
 CITY OF CHARLOTTE
 ENGINEERING & PROPERTY
 MANAGEMENT DEPARTMENT
 600 EAST FOURTH STREET
 CHARLOTTE, NC 28202
 704-336-2291



		CHARLOTTE	
ENGINEERING & PROPERTY MANAGEMENT DEPARTMENT			
HOUGH ROAD STORMWATER IMPROVEMENT PROJECT		PROPERTY OF NOW OR FORMERLY WILLIAM JOHN JR PICKUP LEIGH ANNE PICKUP CHARLOTTE, MECKLENBURG CO., NC	
REVISIONS		JOB NO. SWDES00597	
SCALE 1" = 30'		SHEET 2	
DRAWN BY P.S.		CHECKED BY JB	
DATE		DATE	
K:\Autocad\En_su-LD4\SWDES00597 SWS Hough Rd.4118.#2 149-203-76			

DB 32648-436