

I R. DENNIS SMITH, CERTIFY THAT THIS PLAT WAS DRAWN UNDER MY SUPERVISION FROM AN ACTUAL FIELD SURVEY UNDER MY SUPERVISION. THAT THE DEEDS AND PLATS NOTED WERE USED AS REFERENCES. THAT THE BOUNDARIES NOT SURVEYED ARE CLEARLY INDICATED AS DRAWN FROM INFORMATION AS NOTED. THAT THE RATIO OF PRECISION AS CALCULATED IS 1:10,000.

WITNESS MY ORIGINAL SIGNATURE, REGISTRATION NUMBER AND SEAL THIS 26th DAY OF AUGUST, A.D., 1993.

R. Dennis Smith
R. DENNIS SMITH
N.C.R.L.S. L-1482

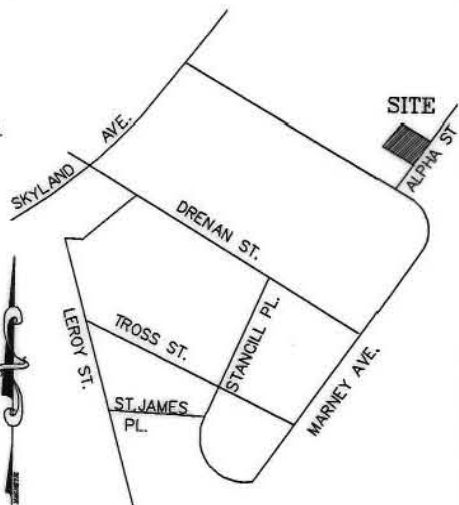
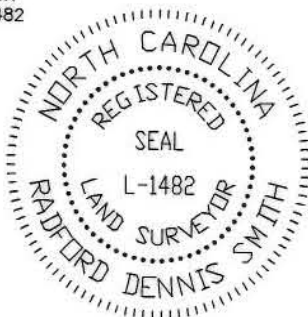

VICINITY MAP
NTS

NOTES:

- 1) BROKEN LINES INDICATE PROPERTY NOT SURVEYED.
- 2) PRESENT ZONING R5
- 3) 20' FRONT SETBACK, 35' REAR SETBACK AND 6' PROPERTY SIDE SETBACK

OSCAR & CARRIE POLK
TAX CODE 157-022-20
DB 553 PG 698

RAYMOND ALEXANDER
TAX CODE 157-022-28
DB 605 PG 394

N 532,690.0561
E 1,461,910.8090

ASSOCIATED INVESTORS
TAX CODE 157-022-30
DB 5392 PG 598

CITY OF CHARLOTTE
TAX CODE 157-022-31
DB 3923 PG 188
AREA: 5,447 SQ.FT.
.125 ACRES

CITY OF CHARLOTTE
TAX CODE 157-022-32
DB 3954 PG 945
AREA: 5,448 SQ.FT.
.125 ACRES

CITY OF CHARLOTTE
TAX CODE 157-022-32
DB 3954 PG 945
AREA: 5,448 SQ.FT.
.125 ACRES

ASSOCIATED INVESTORS
TAX CODE 157-022-33
DB 5392 PG 598

LEGEND

- IRON PIN FOUND
- IRON PIN SET
- △ CONC. MON. FOUND

GRAPHIC SCALE

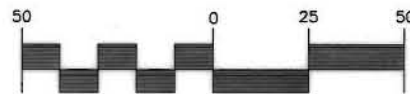

(IN FEET)
1 inch = 50 ft.

GPS M065
N 529247.4126
E 1459413.9050
NAD 83
GRID FACTOR
0.99984570

PREPARED BY:
CITY OF CHARLOTTE
ENGINEERING DEPARTMENT
600 EAST FOURTH STREET
CHARLOTTE, NC 28202
704-336-2291

CHARLOTTE ENGINEERING DEPARTMENT		
REVISIONS	GRIER HEIGHTS BOUNDARY SURVEY	JOB NO. 94001
		FILE NO. CHAR22
DRAWN BY DB	PROPERTY OF CITY OF CHARLOTTE CITY OF CHARLOTTE, MECKLENBURG COUNTY, NC	SHEET 1
CHECKED BY DHS		OF 1
SURVEY SUPVR. <i>[Signature]</i>		DATE 8-19-93

157-022-31/32/20