

NOTES:  
 1. THIS MAP WAS DRAWN FROM DEED OR RECORD INFORMATION. NO FIELD SURVEY WAS CONDUCTED.  
 2. DIMENSIONS IN PARENTHESES ARE FROM DEED OR RECORD INFORMATION.  
 3. TOTAL AREA BY DEED (SEE NOTE 1) 19,190 SQ.FT.  
 AREA ACQUIRED 199 SQ. FT.  
 TOTAL AREA IN TEMP. CONST. EASEMENT 240 SQ. FT.  
 TOTAL AREA WATER TEMP. CONSTRUCTION EASEMENT 1,250 SQ. FT.  
 4. ALL TREES AND SHRUBS LOCATED IN EASEMENT ARE SUBJECT TO REMOVAL EXCEPT AS NEEDED.

WARREN J. JENNINGS, NC P.L.S. L-4096 DATE 10/1/04

1. WARREN J. JENNINGS P.L.S. CERTIFY THAT THIS PLAT WAS PREPARED UNDER MY SUPERVISION AND THAT THE PLAT WAS PREPARED FOR THE PURPOSES OF THE INTENDED TO BE A BOUNDARY SURVEY OF PROPERTY SHOWN.

Starlec Consulting Inc.  
 5255 Parkway Plaza Bwd  
 Suite 130  
 Charlotte, NC U.S.A. 28217  
 Tel. 704.329.0900  
 Fax. 704.329.0905  
 www.starlec.com

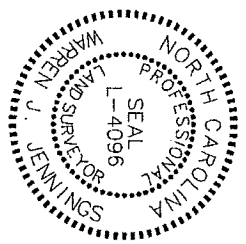

NOW OR FORMERLY:  
 LUSS KIMBERLY A.  
 L 4 & 5 B1  
 MB. 3 PG. 128  
 DB. 10,769 PG. 704  
 #157-091-03  
 618 McALWAY ROAD

NOW OR FORMERLY:  
 HELEN H. OVERCASH  
 L 2,3 PART 1 B1  
 MB. 3 PG. 128  
 DB. 6863 PG. 564  
 #157-091-02  
 626 McALWAY ROAD

THIS MAP IS NOT A CERTIFIED SURVEY AND HAS NOT BEEN REVIEWED BY A LOCAL GOVERNMENT AGENCY FOR COMPLIANCE WITH ANY APPLICABLE LAND DEVELOPMENT REGULATIONS.

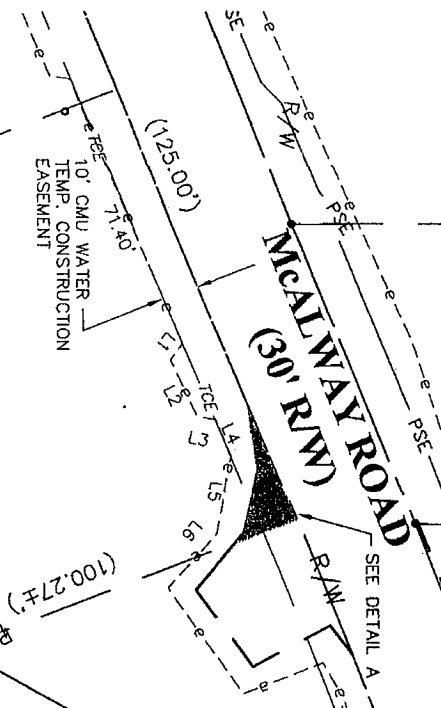

- L1 = N 75°21'58" E 5.70'
- L2 = N 13°58'35" E 17.26'
- L3 = S 41°39'37" E 5.10'
- L4 = N 15°55'18" E 10.95'
- L5 = N 49°51'06" E 21.86'
- L6 = N 81°42'32" E 8.65'

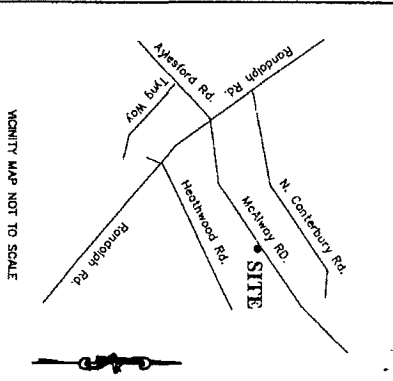

THIS MAP WAS PREPARED FOR THE PURPOSE OF ACQUIRING PERMANENT R/W AND TEMPORARY CONSTRUCTION EASEMENT ONLY AND IS NOT INTENDED TO BE A BOUNDARY SURVEY OF THE PROPERTY SHOWN.

<p>CHARLOTTE ENGINEERING DEPARTMENT</p>		<p>PROPERTY OF HELEN H. OVERCASH</p> <p>PROPERTY ACQUISITION</p> <p>McALWAY ROADWAY IMPROVEMENT PROJECT 512-00-446</p> <p>CHARLOTTE MECKLENBURG CO., NC</p>	<p>JOB NO. 512-00-046</p> <p>FILE NO.</p> <p>MAP 67</p> <p>SHEET 1 OF 1</p>
<p>DRAWN BY BHK</p> <p>CHECKED BY WJU</p> <p>DATE 10-1-04</p>	<p>SCALE 1"=40'</p>	<p>DATE 10-1-04</p>	<p>DATE 10-1-04</p>