

(N81°-30'-08" W 75.0')

IP

69

DOUGLAS & JULIE HICKS
TAX CODE 165-021-41
DEED 4763-764

TOTAL AREA (BY DEED) 11,250 SF
UTILITY EASEMENT 113 SF
AREA REMAINING 11,250 SF



ILIOMA & ELIDA GUERRIER (68)
TAX CODE 165-021-40
DEED 4365-310

(N8°-29'-52" E 150.0' TOTAL)

(N8°-29'-52" E 150.0' TOTAL)

ROBERT & SARA MOORE (70)
TAX CODE 165-021-42
DEED 3762-520

* 80' Measured Easterly from the East Margin of Flintridge Dr. R/W Extended, along the Southerly Margin of the 60' Idlewild Rd. R/W

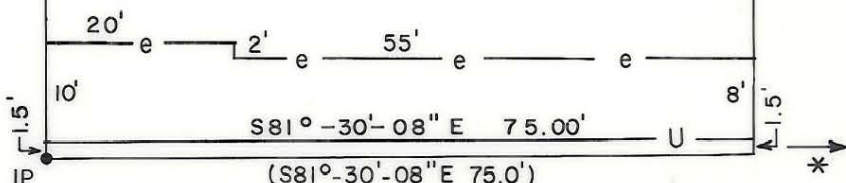

IDLEWILD RD.
60' R/W



This map was prepared for the purpose of fee simple, right of way or easement acquisition only, and is not intended to be a boundary survey of the property shown.

NOTE: Bearings and distances shown in parenthesis are based on deed information.

This plat was prepared under my supervision
Mary A. Fisher
NC Reg. Surveyor No. L-3015

I. CONSTR. EASEMENT

		CHARLOTTE ENGINEERING DEPARTMENT	
REVISIONS	IDLEWILD ROAD WIDENING	JOB NO.	512-85-127
1. 5/16/89		FILE NO.	
DRAWN BY FDW	PROPERTY OF DOUGLAS & JULIE HICKS	SHEET	69
CHECKED BY JAT		OF	
DATE FEB. 1989		SCALE 1" = 20'	