

IDLEWILD ROAD

← 366.4' TO PINEY GROVE RD

464.72' total

S 32° 25' 58" E 391.39'

EXISTING R/W

3

SUTTON

N 55° 34' 18" E 193.55' total

162.79'

PROP. PINEY GROVE RD. RELOC.

N 55° 34' 18" E

189.00'

PROPOSED R/W

R=22.50'
Arc=36.13'

SEE INSERT FOR CONSTR. EASEMENT

S 12° 09' 04" E 167.82'

239.04' total

2

HILL

Iron

S 11° 59' 23" E 266.61'

WAYNE F. HARRIS and wf. ETHEL J. HARRIS

DEED 3236-453

Total Area
Area Taken
Area Remaining

128,330 Sq. Ft. = 2.946 Ac.
10,508 Sq. Ft. = 0.241 Ac.
117,822 Sq. Ft. = 2.704 Ac.

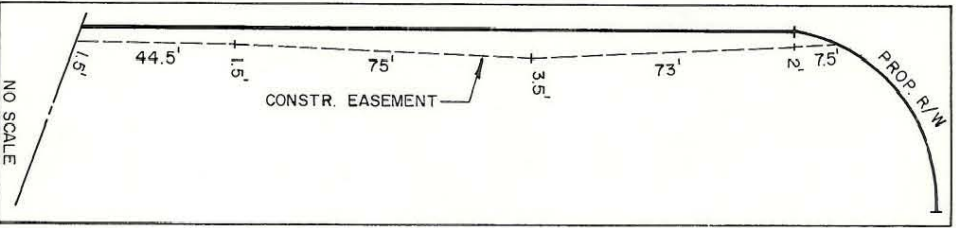

N 57° 34' 37" E
363.46'

This map was prepared for the purpose of right of way or easement acquisition only, and is not intended to be a boundary survey of the property shown.

NOTE: Property corners shown circled were located by actual survey. Bearings are based on MAP BOOK 8-PAGE 243

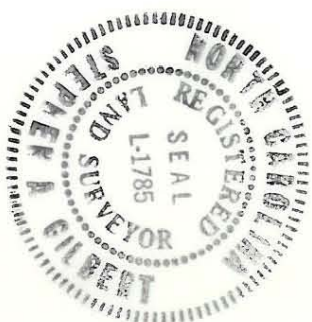

This plat was prepared under my supervision
Stephen Gilbert
N. C. Reg. Surveyor No. L-1785

CITY OF CHARLOTTE NORTH CAROLINA DEPARTMENT OF PUBLIC WORKS ENGINEERING DIVISION		JOB NO. 512-76-01A FILE NO.
REVISIONS	PROPOSED R/W IDLEWILD ROAD NORTH WIDENING	SHEET 1 OF 16
DRAWN BY RAW	PROPERTY OF WAYNE F. HARRIS and wf. ETHEL J. HARRIS	
CHECKED BY RW CITY ENGINEER	DATE 6/22/79 SCALE 1" = 60'	