

LEGEND

- REBAR OR IRON PIPE FOUND
- CALCULATED POINT
- CONCRETE MONUMENT FOUND
- LINES SURVEYED
- LINES NOT SURVEYED
- TEMPORARY CONSTRUCTION EASEMENT
- SIDEWALK/UTILITY EASEMENT (SUE)

NOTES:

- 1) BEARINGS AND DISTANCES SHOWN IN PARENTHESES ARE BASED ON RECORDED INFORMATION, MB 8-133
- 2) TOTAL AREA 61,215 SQ.FT.
- 3) TEMPORARY CONSTRUCTION EASEMENT 730 SQ.FT.
- 4) SIDEWALK UTILITY EASEMENT 956 SQ.FT.
- 5) AREA REMAINING 61,215 SQ.FT.

NC GRID MAD 83 (2007)

S. TRYON ST.
VARIABLE PUBLIC R/W



VICINITY MAP
Not to Scale

N58°39'40"E
99.17'
SIDEWALK
& UTILITY

N58°39'40"E 260.00' TOTAL

167-021-28
WILLIAM E. JOHNSON III
(UNMARRIED)
DB 23994-974
5300 SOUTHAMPTON RD.

167-021-27
CHARLES BRADFORD SMITH
TAMMY NICHOLS SMITH
DB 27795-417
5312 SOUTHAMPTON RD.

167-021-26
SFRH CHARLOTTE
RENTAL, LP
DB 27950-409
5320 SOUTHAMPTON RD.

167-021-58
WILLIE MAE H. NOBELS
DB 2153-5
5328 SOUTHAMPTON RD.

167-021-24
DEREK CLIFTON SANDERSON
DB 24526-557
5336 SOUTHAMPTON RD.

167-021-38
MICHAEL D. HARVEY
(UNMARRIED)
DB 25282-892
5344 SOUTHAMPTON RD.

SIDEWALK & UTILITY EASEMENT
TEMPORARY CONSTRUCTION EASEMENT
SEE DETAIL SHEET, P.2 of 2

N36°03'57"W
10.00'

CONC. MON.

CONC. MON.

L=61.61', R=2267.22'
CH=61.61'
N58°35'30"E

183.13' TIE
S57°37'38"W

1" PIPE

7

167-021-30
ERNEST R. HAYEK, RUDY CRIBB,
H.B. STEELE, TRUSTEES FOR
CHURCH OF CHRIST (YORK ROAD)
DB 2679-230
5327 S. TRYON ST.

8

167-021-29
MEMORIAL UNITED
PRESBYTERIAN CHURCH
(NO DEED REFERENCE FOUND)
5315 S. TRYON ST.
* LESS R/W DB 2613-206

State of North Carolina
County of Mecklenburg

I, _____, Review Officer of
Mecklenburg County, certify that the
map or plat to which this certification
is affixed meets all statutory
requirements for recording.

Review Officer _____ Date _____

I, DAVID H. SNIDER, CERTIFY THAT THIS PLAT WAS
PREPARED UNDER MY SUPERVISION AND THAT THE
PLAT WAS PREPARED FOR THE PURPOSE OF
EASEMENTS ONLY, AND IS NOT INTENDED TO BE A
BOUNDARY SURVEY OF PROPERTY SHOWN.

David H. Snider 3/24/15
DAVID H. SNIDER, NC P.L.S. L-2942 DATE

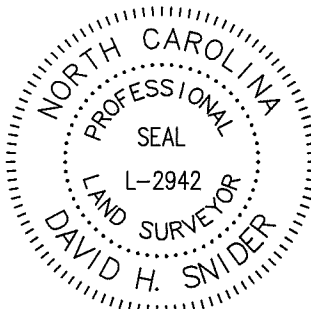
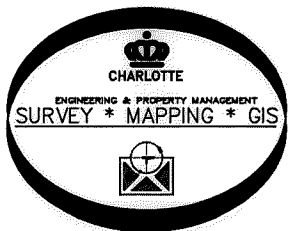

PREPARED BY:
CITY OF CHARLOTTE
ENGINEERING & PROPERTY MANAGEMENT
600 EAST FOURTH STREET
CHARLOTTE, NC 28208
704-336-2291

CHARLOTTE ENGINEERING & PROPERTY MANAGEMENT DEPARTMENT		
REVISIONS TCE - 3/24/15 TCE - 3/20/15 HATCHING - 2/9/15 EASEMENTS AREA - 12/15/14 TCE / SUE - 02/27/14		JOB NO. 512-09-012 FILE NO.
SCALE 0 1" = 60' 60' DRAWN BY JPG		SHEET 1 OF 2
PROPERTY ACQUISITION OWNERS: MEMORIAL UNITED PRESBYTERIAN CHURCH CHARLOTTE, MECKLENBURG CO., NC		CHECKED BY GAI SURVEY SUPR. <i>[Signature]</i>
P:\acadproj\Surproj\SIDEWALK\209012 South Tryon\plats\PARCEL 8 rev5.dwg		

DB 30419-340

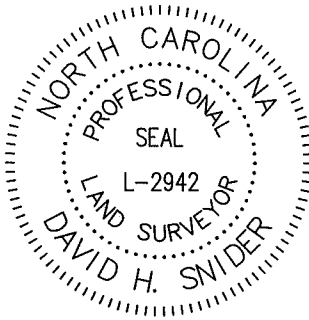

I, DAVID H. SNIDER, CERTIFY THAT THIS PLAT WAS PREPARED UNDER MY SUPERVISION AND THAT THE PLAT WAS PREPARED FOR THE PURPOSE OF EASEMENTS ONLY, AND IS NOT INTENDED TO BE A BOUNDARY SURVEY OF PROPERTY SHOWN.

David H. Snider 3/24/15
 DAVID H. SNIDER, NC P.L.S. L-2942 DATE

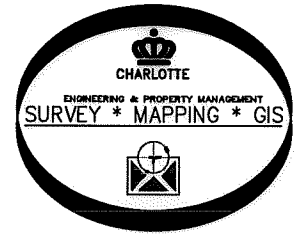

State of North Carolina
 County of Mecklenburg

I, _____, Review Officer of Mecklenburg County, certify that the map or plat to which this certification is affixed meets all statutory requirements for recording.

Review Officer _____ Date _____

PREPARED BY:
 CITY OF CHARLOTTE
 ENGINEERING & PROPERTY MANAGEMENT
 600 EAST FOURTH STREET
 CHARLOTTE, NC 28208
 704-336-2291

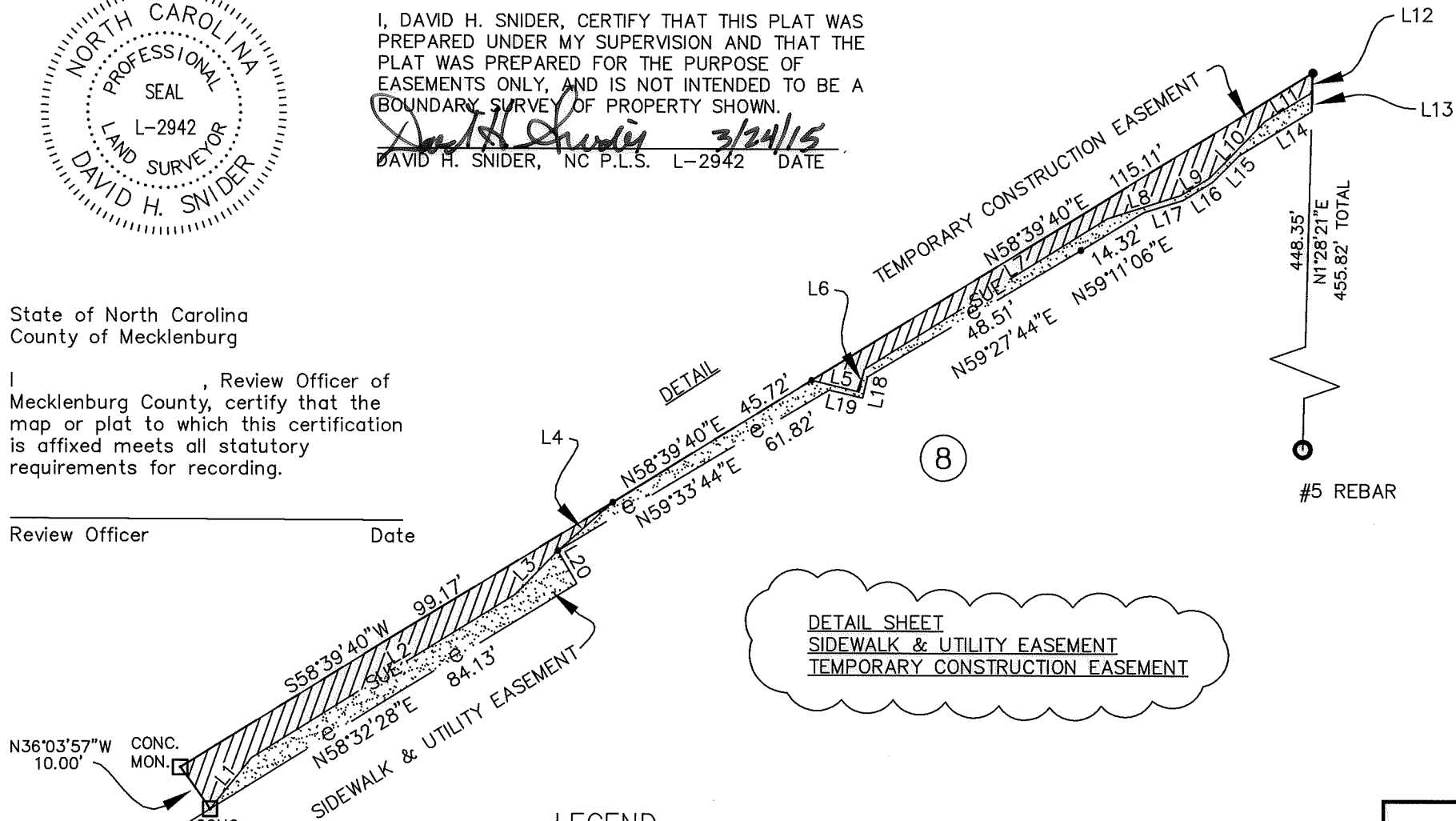

DETAIL SHEET
 SIDEWALK & UTILITY EASEMENT
 TEMPORARY CONSTRUCTION EASEMENT

LINE TABLE		
LINE	BEARING	DIST.
1	N39°16'37"E	12.83'
2	N58°19'42"E	60.49'
3	N44°31'14"E	12.03'
4	N48°54'35"E	14.30'
5	S76°31'12"E	9.55'
6	N13°28'48"E	4.51'
7	N58°19'54"E	55.86'
8	N72°39'07"E	15.20'
9	N58°36'57"E	6.68'
10	N44°34'47"E	15.42'
11	N58°36'47"E	10.91'
12	S01°28'21"W	3.70'
13	S01°28'21"W	3.77'
14	N59°11'06"E	16.74'
15	N44°34'47"E	7.18'
16	N58°36'57"E	6.93'
17	N72°39'07"E	8.07'
18	N13°28'48"E	6.35'
19	N76°31'12"E	6.74'
20	N30°21'58"W	7.37'

LEGEND	
REBAR OR IRON PIPE FOUND	○
CALCULATED POINT	•
CONCRETE MONUMENT FOUND	□
LINE SURVEYED	—————
LINE NOT SURVEYED	—————
TEMPORARY CONSTRUCTION EASEMENT	[Stippled Pattern]
SIDEWALK/UTILITY EASEMENT (SUE)	[Hatched Pattern]

- NOTES:
- 1) BEARINGS AND DISTANCES SHOWN IN PARENTHESES ARE BASED ON RECORDED INFORMATION, MB 8-133
 - 2) TOTAL AREA 61,215 SQ.FT.
 - 3) TEMPORARY CONSTRUCTION EASEMENT 730 SQ.FT.
 - 4) SIDEWALK UTILITY EASEMENT 956 SQ.FT.
 - 5) AREA REMAINING 61,215 SQ.FT.

CHARLOTTE
 ENGINEERING & PROPERTY MANAGEMENT DEPARTMENT

REVISIONS TCE - 3/24/15 TCE - 3/20/15 HATCHING - 2/9/15 EASEMENTS AREA - 12/15/14 TCE / SUE - 02/27/14	SOUTH TRYON STREET SIDEWALK IMPROVEMENTS (TYVOLA RD. TO NATIONS FORD RD.)	JOB NO. 512-09-012 FILE NO.
SCALE 1" = 30' 	PROPERTY ACQUISITION OWNERS: MEMORIAL UNITED PRESBYTERIAN CHURCH CHARLOTTE, MECKLENBURG CO., NC	SHEET 2 OF 2
DRAWN BY JPG	CHECKED BY GAI SURVEY SUPR. <i>GAI</i>	

P:\acadproj\Surproj\SIDEWALK\209012 South Tryon\plats\PARCEL 8 rev5.dwg

DB 30419-340

NC GRID NAD 83 (2007)