

This plat was prepared under my supervision
C.D. Peckham
 N.C. Reg. Engineer No. 3659

Approved by _____
 R/W Agent

NOTE: Property corners shown circled were located by actual survey. Bearings are based on Boundary Survey Pine Oil Co. Spratt Seaver April 22, 1964

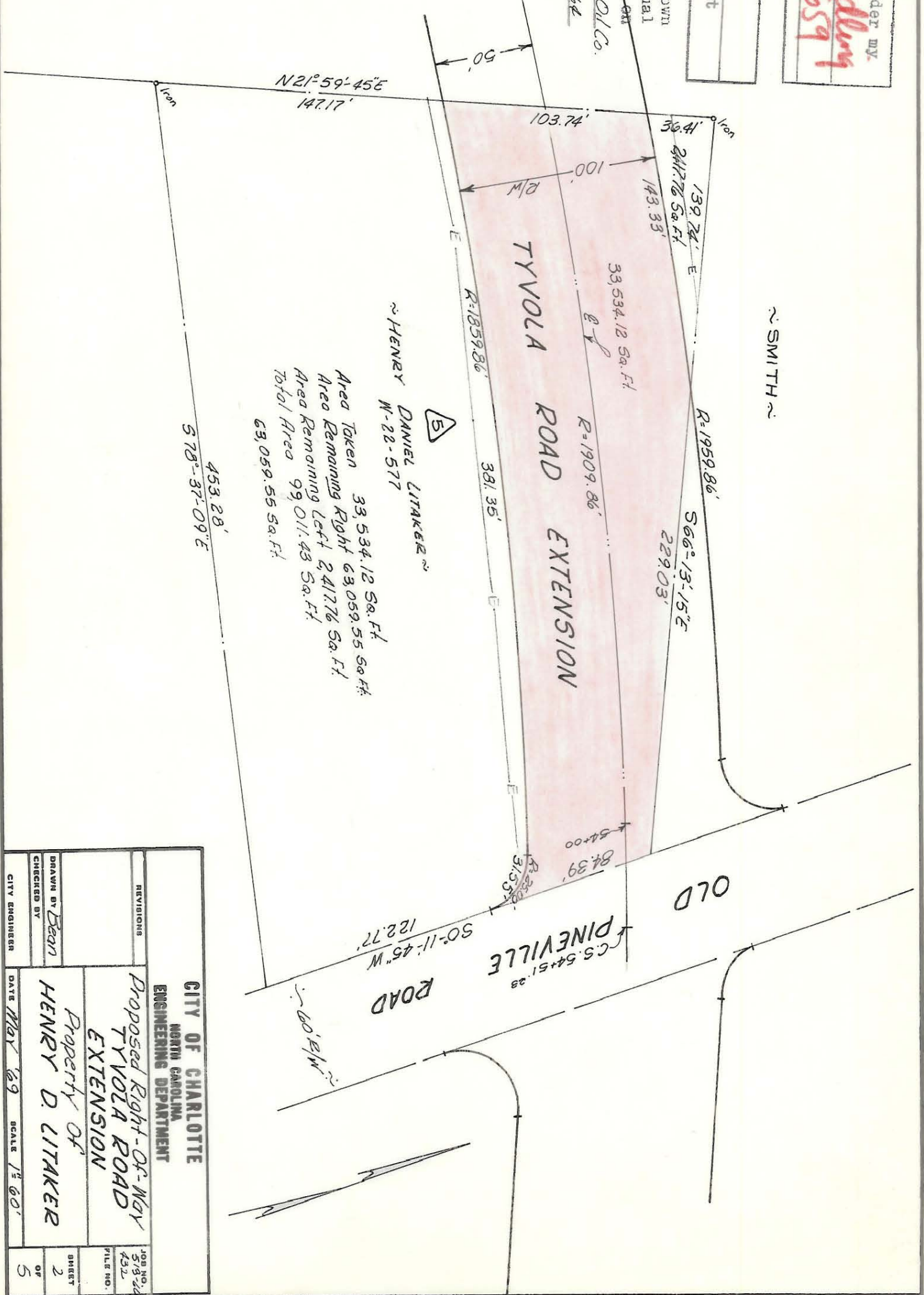

~ SMITH ~

5
 DANIEL LITAKER
 W-22-577

Area Taken 33,534.12 Sq. Ft.
 Area Remaining Right 63,059.55 Sq. Ft.
 Area Remaining Left 2,417.76 Sq. Ft.
 Total Area 99,011.43 Sq. Ft.

CITY OF CHARLOTTE NORTH CAROLINA ENGINEERING DEPARTMENT		JOB NO. 5782d
Proposed Right-Of-Way TYVOLA ROAD EXTENSION		FILE NO. 432
Property of HENRY D. LITAKER		SHEET 2
REVISIONS	DRAWN BY Bevan	OF 5
CHECKED BY	CITY ENGINEER	
DATE May '89	SCALE 1" = 60'	

A-7-1-29

169-084-01 AND 169-082-09/20