

I, DAVID H. SNIDER, CERTIFY THAT THIS PLAT WAS PREPARED UNDER MY SUPERVISION AND THAT THE PLAT WAS PREPARED FOR THE PURPOSE OF EASEMENTS ONLY, AND IS NOT INTENDED TO BE A BOUNDARY SURVEY OF PROPERTY SHOWN.

*David H. Snider* 8/17/2010  
 DAVID H. SNIDER, NC P.L.S. L-2942 DATE



175-134-05  
 DAVID G. LUTES  
 CATHY W. LUTES  
 DB 3879-636  
 3124 PINEHURST PL.

81°42'26"W 200.02' TOTAL  
 (N81°13'00"W 200.00' TOTAL)

175-134-06  
 J. MARTIN SONDEY  
 HELEN A. PORTER  
 DB 8834-322  
 3130 PINEHURST PL.

81°37'15"E 200.18' TOTAL  
 (S81°13'00"E 200.00' TOTAL)

N08°29'42"E 74.65'  
 (N08°47'00"E 75.00')

175-134-07  
 SANFORD J. WINGATE  
 JACQUELINE K. WINGATE  
 DB 4317-296  
 3136 PINEHURST PL.

PREPARED BY:  
 CITY OF CHARLOTTE  
 ENGINEERING DEPARTMENT  
 600 EAST FOURTH STREET  
 CHARLOTTE, NC 28202  
 704-336-2291

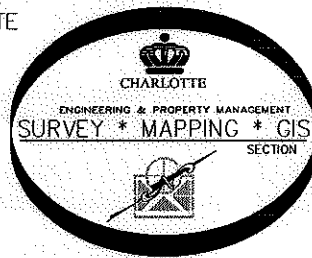

- 1) BEARINGS AND DISTANCES SHOWN IN PARENTHESSES ARE BASED ON RECORDED MAP INFORMATION.
- 2) TOTAL AREA 14,968 SQ. FT.
- 3) TEMP CONSTRUCTION EASEMENT 571 SQ. FT.
- 4) SIDEWALK UTILITY EASEMENT 323 SQ. FT.
- 5) AREA REMAINING 14,968 SQ. FT.

PINEHURST PL.  
 (40' PUBLIC RIGHT-OF-WAY)

LEGEND

IRON PIN FOUND

CALCULATED POINT

LINES SURVEYED

LINES NOT SURVEYED

TEMP. CONSTRUCTION EASEMENT

SIDEWALK UTILITY EASEMENT

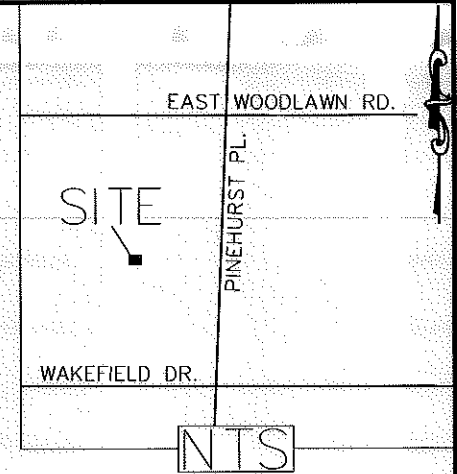

STATE OF NORTH CAROLINA  
 COUNTY OF MECKLENBURG

I, \_\_\_\_\_, REVIEW OFFICER OF MECKLENBURG COUNTY, CERTIFY THAT THE MAP OR PLAT TO WHICH THIS CERTIFICATION IS AFFIXED MEETS ALL STATUTORY REQUIREMENTS FOR RECORDING.

REVIEW OFFICER \_\_\_\_\_ DATE \_\_\_\_\_

		CHARLOTTE ENGINEERING DEPARTMENT	
REVISIONS		PINEHURST PLACE SIDEWALK	JOB NO. 512-10-048
 DRAWN BY P.S. DATE			210048
		PROPERTY OF J. MARTIN SONDEY HELEN A. PORTER CHARLOTTE, MECKLENBURG CO., NC	SHEET 1 OF 1
		CHECKED BY DS	SURVEY SUPVR <i>MS</i>
K: \AutoCad\En_su-LD4\210048 PINEHURST PLACE SW\dwg\PLATS\#8 175-134-06			