

I, DAVID H. SNIDER, CERTIFY THAT THIS PLAT WAS PREPARED UNDER MY SUPERVISION AND THAT THE PLAT WAS PREPARED FOR THE PURPOSE OF ACQUISITION AND EASEMENTS ONLY, AND IS NOT INTENDED TO BE A BOUNDARY SURVEY OF PROPERTY SHOWN.

*David H. Snider* 6/11/09  
 DAVID H. SNIDER, NC P.L.S. L-2942 DATE

STATE OF NORTH CAROLINA  
 COUNTY OF MECKLENBURG

I, REVIEW OFFICER OF MECKLENBURG COUNTY, CERTIFY THAT THE MAP OR PLAT TO WHICH THIS CERTIFICATION IS AFFIXED MEETS ALL STATUTORY REQUIREMENTS FOR RECORDING.

REVIEW OFFICER DATE



25101-682

09-24-09

NC OWNER LLC  
 DB 19071/PG 216  
 4601 PARK ROAD

NOTE:

- 1) BEARINGS AND DISTANCE SHOWN IN PARENTHESIS ARE BASED ON RECORDED INFORMATION.
- 2) TOTAL AREA 204,200 SQ.FT.
- 3) TEMPORARY CONSTRUCTION EASEMENT 416 SQ.FT.
- 4) SIDEWALK/UTILITY EASEMENT 1,811 SQ.FT.
- 5) TOTAL AREA REMAINING 204,200 SQ.FT.

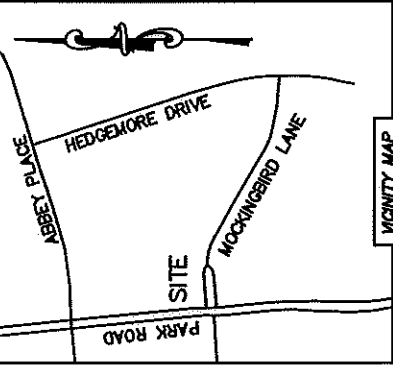

VICINITY MAP  
 Not to scale



HEDGEMORE DRIVE  
 (60' PUBLIC R/W)  
 (S 17°30'00" E 248.41')  
 (S 17°30'20" E)

17514402  
 FSP PARK SENECA  
 LIMITED PARTNERSHIP  
 DB 9184/PG 836  
 1515 MOCKINGBIRD LANE

(N 84°34'00" E 734.32')  
 (N 84°33'40" E)

#5 REBAR FOUND  
 TEMP. CONSTRUCTION EASEMENT  
 SEE DETAIL  
 SIDEWALK/UTILITY EASEMENT

MOCKINGBIRD LANE  
 (VARIABLE PUBLIC R/W)  
 (N 59°12'20" W 306.74')  
 (N 59°12'00" W 306.74')

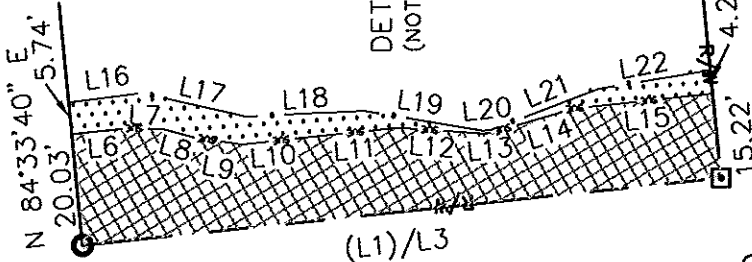

LINE	LENGTH	BEARING	LINE	LENGTH	BEARING
(L1)	(116.02')	(N 05°26'00" W)	L12	15.41'	S 04°31'20" W
(L2)	(106.16')	(S 84°34'00" W)	L13	1.50'	S 05°34'29" E
(L3)	116.02'	N 05°26'20" W	L14	15.42'	S 15°41'12" E
(L4)	106.16'	S 84°33'40" W	L15	25.37'	S 05°36'39" E
(L5)	82.22'	S 19°43'14" E	L16	13.30'	S 06°41'17" E
(L6)	9.97'	S 05°32'17" E	L17	19.39'	S 13°07'28" W
(L7)	6.53'	S 01°23'51" W	L18	21.33'	S 02°15'52" E
(L8)	6.53'	S 15°17'44" W	L19	21.83'	S 09°58'39" W
(L9)	8.15'	S 08°22'12" W	L20	1.41'	S 05°34'29" E
(L10)	11.08'	S 05°30'17" E	L21	20.77'	S 20°18'38" E
(L11)	17.24'	S 05°34'28" E	L22	20.55'	S 08°49'57" E

CURVE	RADIUS & ARC	CHORD
(C1)	(R=305.65 L=193.29')	(S 77°19'00" E 190.09')
(C2)	(R=530.52 L=251.42')	(N 72°45'57" W 249.07')
(C3)	(R=37.04 L=64.93')	(S 42°35'15" W 56.94')
(C4)	(R=924.93 L=172.78')	(S 12°08'55" E 172.53')
(C5)	(R=305.65 L=193.30')	(N 77°22'01" W 190.10')
(C6)	(R=530.52 L=251.48')	(N 72°45'13" W 249.11')
(C7)	(R=37.04 L=65.06')	(S 42°34'55" W 57.02')

LEGEND

- REBAR OR IRON PIN FOUND
- #5 REBAR SET OR PK NAIL
- COMPUTED POINT
- PROPERTY LINES
- EXIST RIGHT-OF-WAY
- TEMP. CONSTRUCTION EASEMENT
- SIDEWALK/UTILITY EASEMENT
- SIDEWALK/UTILITY EASEMENT
- TEMP. CONSTRUCTION EASEMENT

PREPARED BY:  
 CITY OF CHARLOTTE  
 ENGINEERING & PROPERTY MANAGEMENT  
 600 EAST FOURTH STREET  
 CHARLOTTE, NC 28202  
 704-336-2291



CHARLOTTE  
 ENGINEERING DEPARTMENT  
 FY08 SIDEWALK &  
 RAMP PROJECTS  
 PARK ROAD

PROPERTY ACQUISITION  
 OWNER: FSP PARK SENECA  
 LIMITED PARTNERSHIP  
 CHARLOTTE, MECKLENBURG CO., NC

CHECKED BY: DHS SURVEY SUPR. *DL*

JOB NO. 512-07-082  
 FILE NO. 175-144-02  
 SHEET 1 OF 1

K:\AUTOCAD\EN\_SU-LD4\207082-PARK ROAD\DWG\PARCEL 22.DWG