

N. SHARON AMITY RD. (60' R/W)

S 80°30'50" W 226.90'
TO INT. W/ COLWICK RD.

INSERT "A"



N 72°54'58" E 51.01'(total)
(N 72°02'29" E 51.65' (C))
N 72°54'30" E
50.84'

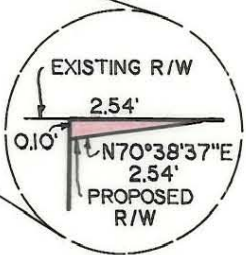

INSERT "A"
N.T.S.

N/F
MAGNUM PROPERTIES
TAX CODE 185-031-06
DEED 5584-471

N/F
UNITARIAN CHURCH
OF CHARLOTTE
DEED 4804-297

N/F
COSTAS N MELISSARIS
& WIFE NICOLETTE MELISSARIS
TAX CODE 185-031-07
DEED 4210-983

TOTAL AREA: 9845 SQ. FT.
BY DEED 0.226 ACRES
AREA TAKEN: 0.127 SQ. FT.
AREA REMAINING: 9844.87 SQ. FT.
0.226 ACRES
TEMP. CONST. ESMT. 508 SQ. FT.
0.0117 ACRES

N 17°05'02" W 199.93' (total)
(N 17°57'31" W 230' (C))

(S 16°56'00" E 230.04' (C))
199.96' (total)
← S 16°04'15" E

← S 72°54'58" W 47.48'
(S 72°02'29" W 47.53')

N/F
GAYNOR ARMS CONDOMINIUMS
TAX CODE 185-031-(8-27)
SEE DEED 4593-183
FOR FIRST CONDO

PROPERTY CORNERS SHOWN CIRCLED WERE LOCATED BY ACTUAL SURVEY. BEARINGS AND DISTANCES SHOWN IN PARENTHESIS ARE BASED ON DEED INFORMATION. BEARINGS ARE BASED ON THE N.C. STATE GRID SYSTEM.

THIS MAP WAS PREPARED FOR THE PURPOSE OF RIGHT-OF-WAY OR EASEMENT ACQUISITION ONLY, AND IS NOT INTENDED TO BE A BOUNDARY SURVEY OF THE PROPERTY SHOWN.

THIS PLAT WAS PREPARED UNDER MY SUPERVISION.

K.C. SIGLER, P.E. L-3068

DEED 5584-471
TAX CODE 185-031-06



CHARLOTTE
ENGINEERING DEPARTMENT

REVISIONS	PROP. R/W TO BE ACQUIRED BY THE CITY OF CHARLOTTE	JOB NO.	512-88-023
REV. PER CITY COMMENTS 12-1-88 4-27-89 ADD LEGAL DESC. TO TEMP. CONST. ESMT. HDR, INC.		FILE NO.	
DRAWN BY DER	PROPERTY OF MAGNUM PROPERTIES	SHEET	5
CHECKED BY K.C.S.		OF	20
SURVEY SUPERVISOR	DATE 11/21/88	SCALE 1" = 30'	

185-031-06