

I, R. DENNIS SMITH, CERTIFY THAT THIS PLAT WAS PREPARED UNDER MY SUPERVISION AND THAT THE PLAT WAS PREPARED FOR THE PURPOSE OF ACQUISITION AND EASEMENTS ONLY, AND IS NOT INTENDED TO BE A BOUNDARY SURVEY OF PROPERTY SHOWN.

R. Dennis Smith 5/14/98
 R. DENNIS SMITH, NC R.L.S. L-1482 DATE

- NOTE:
- 1) BEARINGS AND DISTANCES SHOWN IN PARENTHESES ARE BASED ON RECORDED MAP INFORMATION.
 - 2) TOTAL AREA BY DEED 27,062 SQ.FT.
 - 3) TEMP. CONSTRUCTION EASEMENT 942 SQ.FT.
 - 4) PERMANENT UTILITY EASEMENT 71 SQ.FT.
 - 5) AREA ACQUIRED 244 SQ.FT.
 - 6) AREA REMAINING 26,818 SQ.FT.

LEGEND:

- IRON PIN FOUND
- IRON PIN SET
- LINE SURVEYED
- LINE NOT SURVEYED
- NEW PROPERTY LINE
- AREA ACQUIRED
- PERMANENT UTILITY EASEMENT
- TEMPORARY CONSTR. EASEMENT

CURVE	LENGTH	RADIUS	CHORD	BEARING
C1	137.82	1628.95	137.78	N47°13'07"E
(C2)	30.28	20.00	27.47	S87°10'03"W
C3	10.04	1628.95	10.04	N44°37'06"E
C4	14.36	1628.95	14.36	N44°11'20"E
C5	23.16	35.50	22.75	S63°02'43"W
C6	6.05	35.50	6.04	S86°37'02"W
C7	12.65	35.50	12.59	N78°17'18"W
C8	162.23	1628.95	162.16	N46°47'22"E
(C9)	162.22	1481.56	162.14	N46°55'52"E
C10	41.86	35.50	39.48	S78°08'23"W

LINE	LENGTH	BEARING
L1	12.00	S51°58'33"E
L2	4.00	N38°17'13"E
L3	1.22	S45°38'36"E
L4	20.00	N51°56'35"W
L5	4.00	S38°03'25"W
L6	15.47	S51°56'35"E
L7	24.06	N49°27'35"W
L8	2.00	S40°32'25"W

20-12-50
 189-051-15
 5/14/98
 RECEIVED BY NOTARIAL CITY

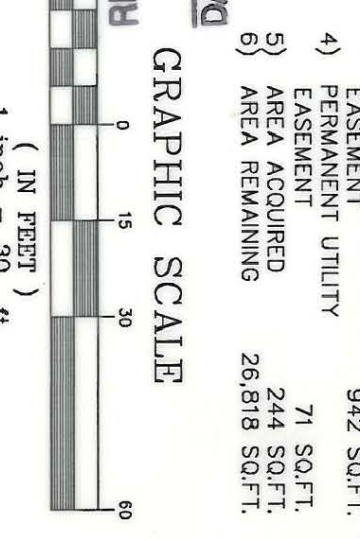

PREPARED BY:
 CITY OF CHARLOTTE
 ENGINEERING DEPARTMENT
 600 EAST FOURTH STREET
 CHARLOTTE, NC 28208
 704-336-2291

JACK D FLETCHER
 TAX CODE: 189-051-16
 DB: 2134 0492

ALTA ENTERPRISES INC.
 TAX CODE: 189-051-15
 DB: 2664 0606

		JOB NO. 512-89-003 LAM/06093
REVISIONS 1-CHANGE PERM. UTILTY ESMNT. 5/14/98 DBS DRAWN BY DBS CHECKED BY SURVEY SUPER.	CHARLOTTE ENGINEERING DEPARTMENT RADIUS IMPROVEMENTS GATE POST RD. AT RAMA RD. PROPERTY ACQUISITION OWNER: ALTA ENTERPRISES INC. CHARLOTTE, MECKLENBURG CO., NC	FILE NO. PLATT SHEET 1 OF 1
DATE 4/28/98 SCALE 1"=30'		

189-051-15