

I, _____, REVIEW OFFICER OF MECKLENBURG COUNTY, CERTIFY THAT THE MAP OR PLAT TO WHICH THIS CERTIFICATION IS AFFIXED MEETS ALL STATUTORY REQUIREMENTS FOR RECORDING.

REVIEW OFFICER

DATE

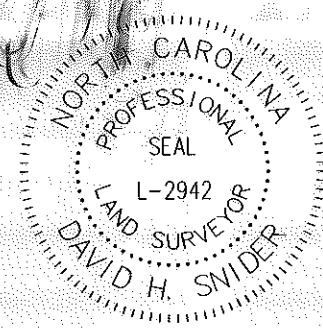

I, DAVID H. SNIDER, CERTIFY THAT THIS PLAT WAS PREPARED UNDER MY SUPERVISION AND THAT THE PLAT WAS PREPARED FOR THE PURPOSE OF EASEMENTS ONLY, AND IS NOT INTENDED TO BE A BOUNDARY SURVEY OF PROPERTY SHOWN.

David H. Snider 11/6/09
 DAVID H. SNIDER, NC P.L.S. L-2942 DATE

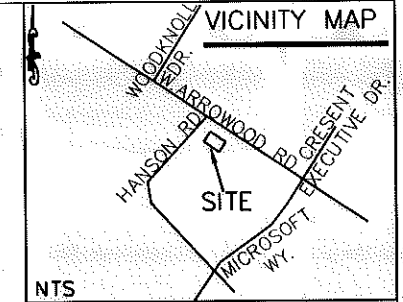

- LEGEND:
- MONUMENT
 - BREAK POINT
 - IRON PIN FOUND
 - LINE SURVEYED
 - LINE NOT SURVEYED
 - TEMP. CONSTR. EASEMENT
 - STORM DRAINAGE EASEMENT

DETAIL "A"

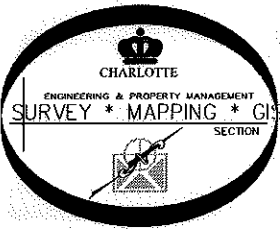
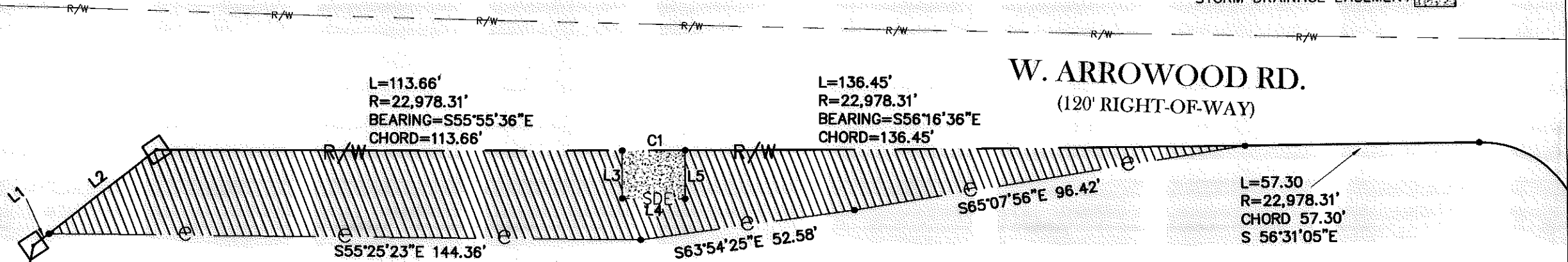

PREPARED BY:
 CITY OF CHARLOTTE
 ENGINEERING & PROPERTY MANAGEMENT
 600 EAST FOURTH STREET
 CHARLOTTE, NC 28208
 704-336-2291

18

LINE TABLE		
LINE	LENGTH	BEARING
L1	4.65'	S85°52'22"W
L2	33.28'	S85°52'22"W
L3	11.68'	S33°55'54"W
L4	15.35'	S55°33'18"E
L5	11.82'	N33°53'36"E

CURVE TABLE				
CURVE	LENGTH	RADIUS	BEARING	CHORD
C1	15.35	22978.31	S56°05'15"E	15.35'

		CHARLOTTE ENGINEERING & PROPERTY MANAGEMENT		JOB NO.	512-090-73
				FILE NO.	209073
REVISIONS 11/6/09 6/23/09 5/6/09 3/13/09		ARROWOOD SIDEWALKS EASEMENT AQUISITION		SHEET	2
SCALE 1"=30' 				PROPERTY OF	ARROWPOINT HOLDINGS, INC. & TM(NC), INC.
DRAWN BY PS		CHARLOTTE, MECKLENBURG CO., NC			
DATE		CHECKED BY SURVEY SUPVR. <i>DSR</i>			