

MCDEVITT AND STREET
COMPANY
DEED: 4468-350 & 356

71+00

73+00

(51)

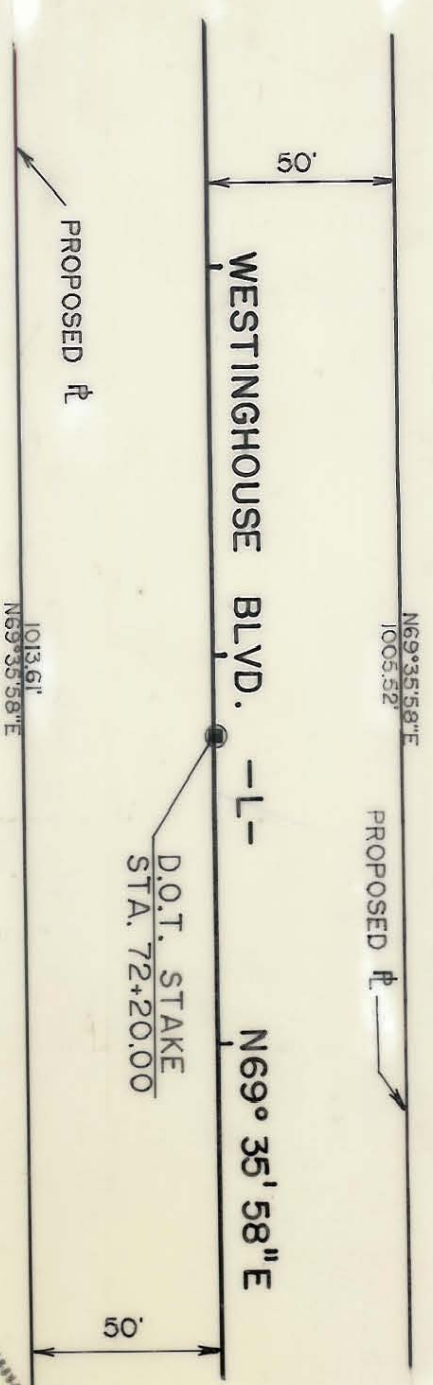

MCDEVITT AND STREET
COMPANY
DEED: 4468-350 & 356

(51)

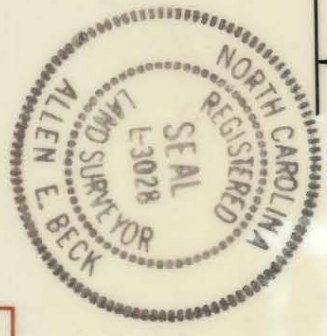

NOTE: Property corners shown circled were located by actual survey. Bearings and distances shown in parenthesis are based on deed information. Bearings are based on

N.C. COORDINATE SYSTEM

This map was prepared for the purpose of fee simple, right-of-way or easement acquisition only, and is not intended to be a boundary survey of the property shown.

This plat was prepared under my supervision Allen E. Beck
10-27-87
N.C. Reg. Surveyor No. L-3028

PARCEL ID # 205-131-04

| | | | | | |
|--|--|---|--|-------------------------------|--|
| <p>CHARLOTTE ENGINEERING DEPARTMENT</p> | | <p>REVISIONS</p> <p>JAN 15, 1998 E AND ROW BAKER.</p> | | <p>JOB NO.</p> | |
| <p>WESTINGHOUSE BLVD.</p> | | <p>PROPERTY OF: MCDEVITT AND STREET COMPANY</p> | | <p>FILE NO.</p> | |
| <p>DRAWN BY TRH CHECKED BY AEB SUPERVISOR <i>Allen E. Beck</i></p> | | <p>DATE OCT 27, '87</p> | | <p>SHEET SIC/4 OF</p> | |
| <p>SCALE 1 = 50</p> | | | | | |

205-134-01