

SEE DETAIL "A"
PAGE 2 OF 2

SEE DETAIL "C"
PAGE 2 OF 2

NTS SITE

-Y1-
8+33.23'
31.83 RT

I, DAVID H. SNIDER, CERTIFY THAT THIS PLAT WAS PREPARED UNDER MY SUPERVISION AND THAT THE PLAT WAS PREPARED FOR THE PURPOSE OF EASEMENTS ONLY, AND IS NOT INTENDED TO BE A BOUNDARY SURVEY OF PROPERTY SHOWN.

David H. Snider 6/11/14
DAVID H. SNIDER, NC P.L.S. L-2942 DATE

⑤

205-171-17
OSEI ENTERPRISES LLC
DB 10988 PG 47
9001 NATIONS FORD RD.

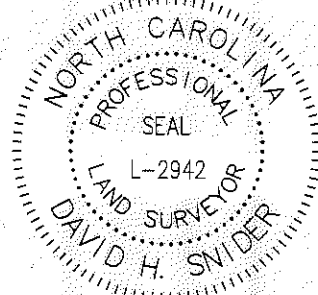

STATE OF NORTH CAROLINA
COUNTY OF MECKLENBURG

REVIEW OFFICER OF MECKLENBURG COUNTY, CERTIFY THAT THE MAP OR PLAT TO WHICH THIS CERTIFICATION IS AFFIXED MEETS ALL STATUTORY REQUIREMENTS FOR RECORDING.

REVIEW OFFICER _____ DATE _____

- 1) BEARINGS AND DISTANCES SHOWN IN PARENTHESES ARE BASED ON RECORDED MAP INFORMATION.
- 2) TOTAL AREA 72,284 SQ. FT.
- 3) TEMP CONSTRUCTION EASEMENT 8,890 SQ. FT.
- 4) SIDEWALK UTILITY EASEMENT 3,166 SQ. FT.
- 5) UTILITY EASEMENT 10 SQ. FT.
- 6) STORM DRAINAGE EASEMENT 189 SQ. FT.
- 7) AREA REMAINING 72,284 SQ. FT.

LEGEND

- IRON PIN FOUND
- CALCULATED POINT
- LINES SURVEYED
- LINES NOT SURVEYED
- TEMP. CONSTRUCTION EASEMENT
- UTILITY EASEMENT
- SIDEWALK UTILITY EASEMENT
- STORM DRAINAGE EASEMENT

COMBINED GRID
FACTOR= 0.999846205
N: 509272.42
E: 1434658.03

SEE DETAIL "B"
PAGE 2 OF 2

#3 REBAR #3 REBAR

S89°29'16"W 194.81' TOTAL
(S88°50'22"W 194.80') TOTAL

S0°29'50"E 294.94' TOTAL
(S1°11'21"W 294.95') TOTAL
S0°31'54"E 99.91'
(S1°15'38"W 99.86')

(TIE)
N3°04'01"W
130.01'
205-171-20
ARROWOOD NATIONS
FORD PROPERTY, LLC.
DB 22151 PG 10
9101 NATIONS FORD RD

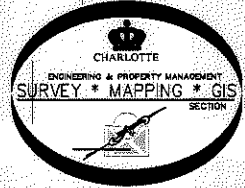

PREPARED BY:
CITY OF CHARLOTTE
ENGINEERING DEPARTMENT
600 EAST FOURTH STREET
CHARLOTTE, NC 28202
704-336-2291

		CHARLOTTE ENGINEERING DEPARTMENT
REVISIONS 8/10/14 NEW e & SDE 3/24/14 NEW e & SDE 1/15/14 NEW UTE & e 8/30/13 OVERLAP AREA		JOB NO: 512-11-041 211041
SCALE 1"=40" 		ARROWOOD/NATIONS FORD RD. INTERSECTION PROPERTY OF OSEI ENTERPRISES LLC. CHARLOTTE, MECKLENBURG CO., NC
DRAWN BY P.S. DATE	CHECKED BY DS SURVEY SUPVR. <i>DS</i>	SHEET 1 OF 2
K:\AutoCad\En_su-LD4\211041 Arrowood & Nations Ford\Plats\#5 205-171-17		

ACQUISITION BY DB 29679 PG 773

I, DAVID H. SNIDER, CERTIFY THAT THIS PLAT WAS PREPARED UNDER MY SUPERVISION AND THAT THE PLAT WAS PREPARED FOR THE PURPOSE OF EASEMENTS ONLY, AND IS NOT INTENDED TO BE A BOUNDARY SURVEY OF PROPERTY SHOWN.

David H. Snider 6/11/14
 DAVID H. SNIDER, NC P.L.S. L-2942 DATE



Curve Table				
Curve #	Length	Radius	CHORD BEARING	CHORD
C1	19.38	1648.52	N75°32'30"E	19.38
C2	15.00	1648.52	N76°08'21"E	15.00
C3	67.24	1648.52	N77°34'06"E	67.23
C4	13.44	10.00	N38°02'54"E	12.45

STATE OF NORTH CAROLINA
 COUNTY OF MECKLENBURG

I, _____, REVIEW OFFICER OF MECKLENBURG COUNTY, CERTIFY THAT THE MAP OR PLAT TO WHICH THIS CERTIFICATION IS AFFIXED MEETS ALL STATUTORY REQUIREMENTS FOR RECORDING.

REVIEW OFFICER _____ DATE _____

PREPARED BY:
 CITY OF CHARLOTTE
 ENGINEERING DEPARTMENT
 600 EAST FOURTH STREET
 CHARLOTTE, NC 28202
 704-336-2291

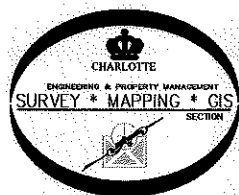

Line Table		
Line #	Length	Direction
L1	3.09	N75°11'52"E
L2	1.70	S00°29'50"E
L3	3.14	N73°11'31"W
L4	0.73	S00°29'50"E
L5	1.36	S00°29'50"E
L6	3.90	S73°11'31"E
L7	2.01	S83°36'08"E
L8	1.79	N75°16'52"E
L9	3.11	S73°11'31"E
L10	3.79	N75°11'52"E
L11	3.74	S00°29'50"E
L12	90.94	N75°16'52"E
L13	1.61	N14°43'08"W
L14	1.67	S14°43'08"E
L15	8.07	N75°16'52"E
L16	15.00	N75°16'52"E
L17	11.07	S14°43'08"E
L18	10.90	N14°43'08"W
L20	30.30	N75°25'38"E
L21	63.85	S89°47'56"E
L22	2.19	N00°12'04"E
L23	92.54	N78°05'47"E
L24	64.73	N00°10'00"W
L25	50.72	N25°40'55"W
L26	152.55	N00°26'34"W
L27	19.63	N32°08'45"E

L28	57.21	N00°20'51"W
L29	15.08	S89°29'16"W
L30	2.50	S89°29'16"W
L31	3.52	S89°29'16"W
L32	54.30	N00°19'22"W
L33	54.30	N00°19'22"W
L34	18.96	N18°11'38"E
L35	49.85	N00°13'59"W
L36	17.44	N20°20'20"W
L37	42.97	N00°12'57"W
L38	20.82	N16°32'04"E
L39	46.62	N00°20'37"W
L40	19.76	N10°38'37"W
L41	69.36	N00°27'00"W
L42	68.94	N75°11'52"E
L43	27.07	N76°34'56"E
L44	8.22	N55°16'49"E
L45	41.30	N76°40'48"E
L46	350.01	N0°30'30"W

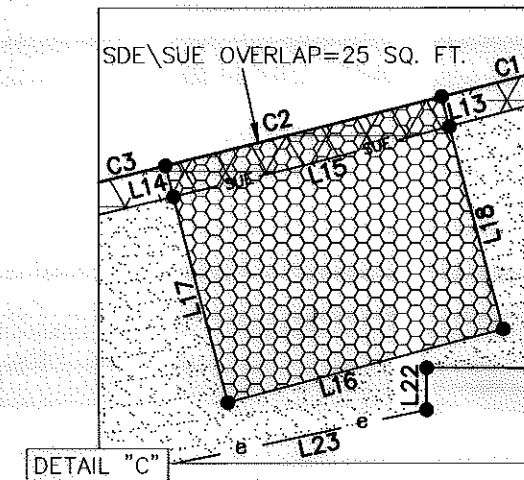
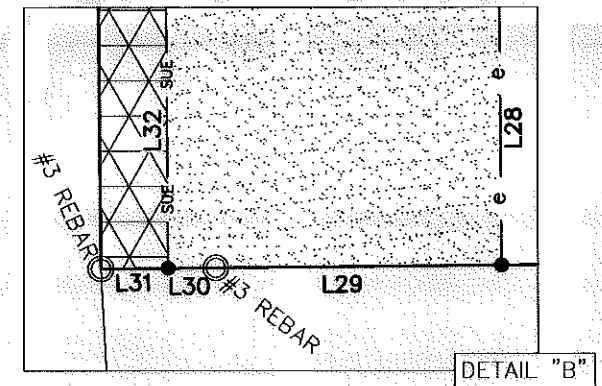
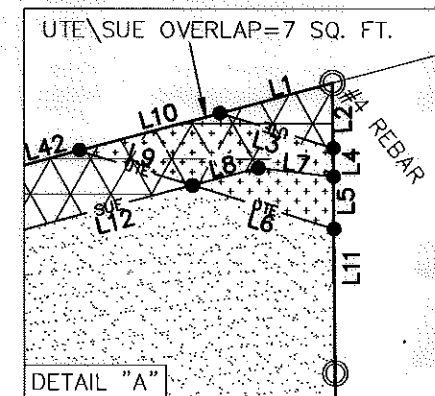

CHARLOTTE ENGINEERING DEPARTMENT		JOB NO. 512-11-041
ARROWOOD/NATIONS FORD RD. INTERSECTION		211041
PROPERTY OF OSEI ENTERPRISES LLC. CHARLOTTE, MECKLENBURG CO., NC		SHEET 2 OF 2
REVISIONS 6/10/14 NEW e & SDE 3/24/14 NEW e & SDE 1/15/14 NEW UTE & e 8/30/13 OVERLAP AREA	SCALE NTS 	DRAWN BY P.S. DATE _____
CHECKED BY DS SURVEY SUPVR. <i>DS</i>	K:\AutoCad\En_su-LD4\211041 Arrowood & Nations Ford\Plats\#5 205-171-17	