

TOTAL AREA 65999.29 S.F. 1.5151 Ac (BY DEED)
 AREA FEE SIMPLE 5939.09 S.F. 0.1363 Ac
 AREA TEMP. CONST. EASEMENT 6029.86 S.F. 0.1385 Ac
 AREA DOWN GUY EASEMENT 77.99 S.F. 0.0018 Ac
 RESIDUAL AREA 60060.20 S.F. 1.3788 Ac (BY DEED)

62

64

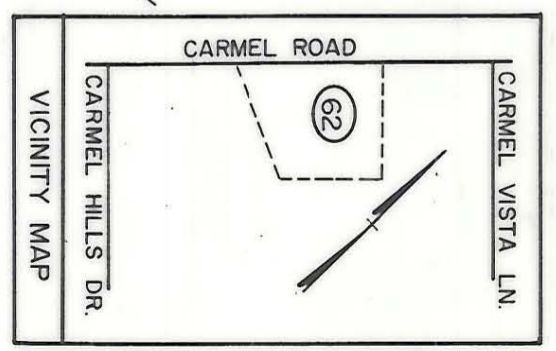

NAD 83

- L1 S 61° 52' 51" E 10.11'
- L2 S 61° 52' 51" E 9.81'
- L3 N 28° 07' 09" E 2.00'
- L4 S 61° 52' 51" E 10.11'
- L5 S 61° 52' 51" E 10.11'
- L6 S 82° 42' 28" E 18.36'
- L7 N 07° 17' 32" E 2.00'
- L8 S 82° 42' 28" E 19.48'

(1) This plot was prepared under my supervision.
Leonard G. Fletcher Date: 5-8-95

(2) This map was prepared for the purpose of acquiring fee simple, right-of-way and/or an easement only and is not intended to be a boundary survey of property shown.
 N.C. Registered Land Surveyor No. L-2974

PREPARED BY:
 TGS Engineers
 Suite 203, North Building
 Raleigh, North Carolina
 Phone (919)851-7144

		CHARLOTTE ENGINEERING DEPARTMENT	
REVISIONS AUGUST 26, 1993	PROPERTY OF MARY DIANNE THOMAS	JOB NO. 512-88-123	SHEET 62 OF 137
DRAWN BY ELW CHECKED BY WFW	CARMEL ROAD WIDENING PROJECT	DATE MAY 27, 1993	SCALE 1" = 50'