

I, JACKIE W. BRIM, CERTIFY THAT THIS PLAT WAS PREPARED UNDER MY SUPERVISION AND THAT THE PLAT WAS PREPARED FOR THE PURPOSE OF ACQUISITION AND EASEMENTS ONLY, AND IS NOT INTENDED TO BE A BOUNDARY SURVEY OF PROPERTY SHOWN.

*Jackie W. Brim* 7-6-2017

JACKIE W. BRIM, NC P.L.S. L-4348 DATE  
STATE OF NORTH CAROLINA  
COUNTY OF MECKLENBURG

I, \_\_\_\_\_ REVIEW OFFICER OF MECKLENBURG COUNTY,  
CERTIFY THAT THE MAP OR PLAT TO WHICH THIS CERTIFICATION IS AFFIXED  
MEETS ALL STATUTORY REQUIREMENTS FOR RECORDING.

REVIEW OFFICER \_\_\_\_\_ DATE \_\_\_\_\_

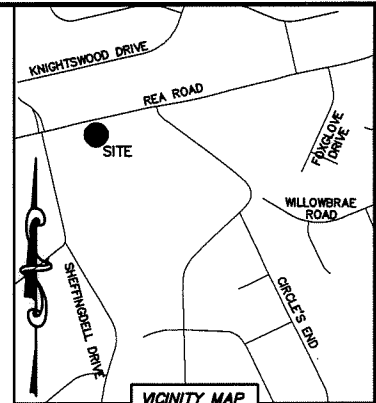
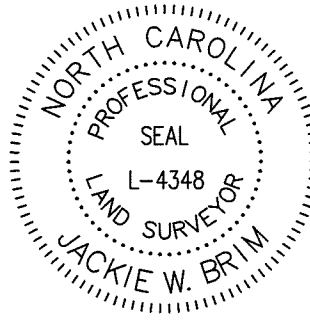

REA ROAD  
(60' PUBLIC R/W)

S 85°52'38" W  
386.27' (GROUND)  
386.21' (GRID)  
MAG. NAIL  
NC GRID NAD 83 (2011)  
N: 499,957.11 FEET  
E: 1,462,901.29 FEET  
CGF: 0.999850719

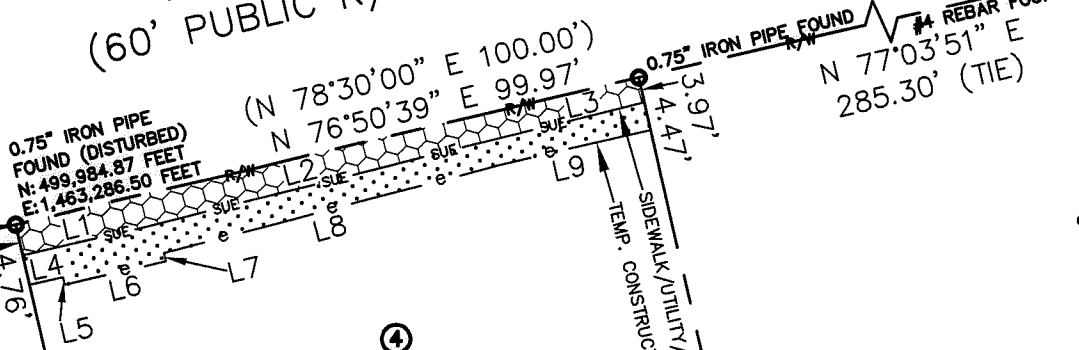

21129102  
NOW OR FORMERLY  
RICHARD D. DETWILER AND  
WIFE FAYE E. DETWILER  
DB 4337/PG 297  
3501 REA ROAD

| LINE | LENGTH | BEARING       |
|------|--------|---------------|
| L1   | 18.15' | N 76°55'46" E |
| L2   | 57.14' | N 76°04'23" E |
| L3   | 24.69' | N 76°13'19" E |
| L4   | 5.31'  | N 77°22'23" E |
| L5   | 1.21'  | S 15°25'17" E |
| L6   | 16.20' | N 76°54'39" E |
| L7   | 1.32'  | N 16°12'00" W |
| L8   | 53.97' | N 75°21'46" E |
| L9   | 24.54' | N 77°10'55" E |

21129103  
NOW OR FORMERLY  
TERRY W. SEAGRAVES AND  
WIFE DONNA J. SEAGRAVES  
DB 5899/PG 809  
3509 REA ROAD

21129101  
NOW OR FORMERLY  
TERESA J. MOORE AND  
HUSBAND MICHAEL EFIRD  
DB 14486/PG 139  
3421 REA ROAD

- NOTE:
- 1) BEARINGS AND DISTANCE SHOWN IN PARENTHESIS ARE BASED ON RECORDED INFORMATION.
  - 2) COMPUTED PROJECT DISTANCE - \*
  - 3) TOTAL AREA 22,400 SQ.FT.
  - 4) TEMP. CONSTRUCTION EASEMENT 464 SQ.FT.
  - 5) SIDEWALK/UTILITY EASEMENT 456 SQ.FT.
  - 6) TOTAL AREA REMAINING 22,400 SQ.FT.

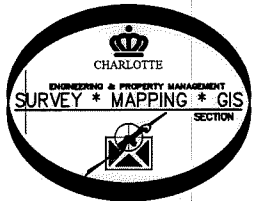

- LEGEND**
- REBAR OR IRON PIN FOUND
  - COMPUTED POINT
  - PROPERTY LINES
  - EXISTING RIGHT-OF-WAY
  - TEMP. CONSTRUCTION EASEMENT
  - SIDEWALK/UTILITY EASEMENT

PREPARED BY:  
CITY OF CHARLOTTE  
ENGINEERING & PROPERTY MANAGEMENT DEPARTMENT  
600 EAST FOURTH STREET  
CHARLOTTE, NC 28202  
704-336-2291

|   |  |  |
|---|--|--|
|   |  | <b>CHARLOTTE</b><br>ENGINEERING & PROPERTY MANAGEMENT DEPARTMENT |
| REVISIONS   | <b>REA ROAD SIDEWALK &amp; PEDESTRIAN SAFETY</b>   | JOB NO.<br>PM51215033  |
| SCALE<br>1"=30'   | <b>PROPERTY OF</b><br>NOW OR FORMERLY<br>RICHARD D. DETWILER AND WIFE FAYE E. DETWILER<br>CHARLOTTE, MECKLENBURG CO., NC | FILE NO.<br>211-291-02   |
| DRAWN BY LG   | CHECKED BY JWB SURVEY SUPVR.   | SHEET<br>1<br>OF<br>1  |
| K: \AutoCad\En_su-LD4\215033\dwg\ReaRoadSidewalkC3D2013.dwg |  |  |

DB 32097-304