

I, JACKIE W. BRIM, CERTIFY THAT THIS PLAT WAS PREPARED UNDER MY SUPERVISION AND THAT THE PLAT WAS PREPARED FOR THE PURPOSE OF ACQUISITION AND EASEMENTS ONLY, AND IS NOT INTENDED TO BE A BOUNDARY SURVEY OF PROPERTY SHOWN.

Jackie W. Brim 7-6-2017

JACKIE W. BRIM, NC P.L.S. L-4348 DATE

NOTE:

- 1) BEARINGS AND DISTANCE SHOWN IN PARENTHESIS ARE BASED ON RECORDED INFORMATION.
- 2) COMPUTED PROJECT DISTANCE - *
- 3) TOTAL AREA 23,379 SQ.FT.
- 4) TEMP. CONSTRUCTION EASEMENT 448 SQ.FT.
- 5) SIDEWALK/UTILITY EASEMENT 637 SQ.FT.
- 6) TOTAL AREA REMAINING 23,379 SQ.FT.

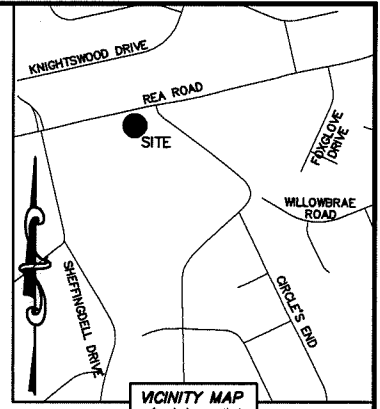
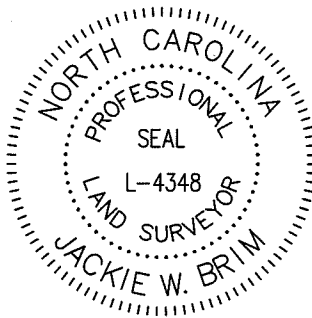

S 81°59'38" W
684.21' (GROUND)
684.10' (GRID)

MAG. NAIL
NC GRID NAD 83 (2011)
N: 499,957.11 FEET
E: 1,462,901.29 FEET
CGF: 0.999850719

COMPUTED POINT
N: 500,052.39 FEET
E: 1,463,578.73 FEET

REA ROAD (60' PUBLIC R/W)

(N 79°39'00" E 85.00')
(N 77°03'51" E 85.30')

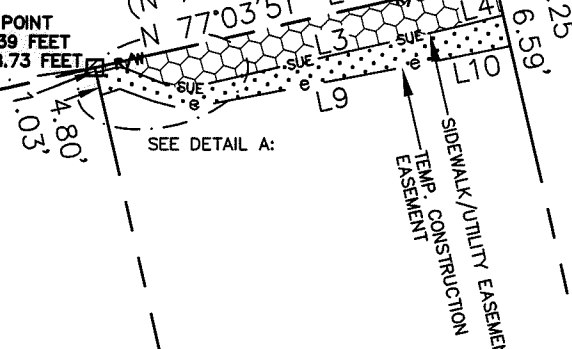

SEE DETAIL A:

SIDEWALK/UTILITY EASEMENT
TEMP. CONSTRUCTION EASEMENT

21129124
NOW OR FORMERLY
NATHAN H. McLAMB AND
WIFE LEONE U. McLAMB
DB 7114/PG 51
7000 SWANS RUN ROAD

21129101
NOW OR FORMERLY
TERESA J. MOORE AND
HUSBAND MICHAEL EFIRD
DB 14486/PG 139
3421 REA ROAD

DETAIL A:
(NOT TO SCALE)

N 12°51'54" W 312.30' (TOTAL)
(N 10°03'02" W 311.42')

S 13°00'14" E 238.05' (TOTAL)
223.21'

21129123
NOW OR FORMERLY
WHIT W. HOLT AND
WIFE DIAN HOLT
DB 13576/PG 324
3411 REA ROAD

N 36°15'11" E
204.07' (TIE)

21129125
NOW OR FORMERLY
ANNIE LEVY
DB 18778/PG 648
7010 SWANS RUN ROAD

STATE OF NORTH CAROLINA
COUNTY OF MECKLENBURG

I, _____ REVIEW OFFICER
OF MECKLENBURG COUNTY, CERTIFY THAT THE
MAP OR PLAT TO WHICH THIS CERTIFICATION IS
AFFIXED MEETS ALL STATUTORY REQUIREMENTS
FOR RECORDING.

REVIEW OFFICER _____ DATE _____

LINE TABLE		
LINE	LENGTH	BEARING
L1	4.18'	N 76°13'19" E
L2	7.37'	S 67°54'44" E
L3	56.95'	N 77°01'47" E
L4	7.83'	N 75°47'52" E
L5	4.13'	N 71°52'50" E
L6	7.52'	S 69°41'42" E
L7	5.15'	S 75°12'04" E
L8	5.43'	N 84°27'42" E
L9	48.40'	N 79°10'46" E
L10	16.61'	N 78°23'13" E

CURVE TABLE		
CURVE	RADIUS & ARC	CHORD
C1	R=4.00 L=2.43'	S 85°21'00" E 2.40'
C2	R=14.00 L=8.57'	S 85°26'30" E 8.43'

LEGEND

- REBAR OR IRON PIN FOUND
- COMPUTED POINT
- PROPERTY LINES
- EXISTING RIGHT-OF-WAY
- SIDEWALK/UTILITY EASEMENT
- TEMP. CONSTRUCTION EASEMENT

PREPARED BY:
CITY OF CHARLOTTE
ENGINEERING & PROPERTY MANAGEMENT DEPARTMENT
600 EAST FOURTH STREET
CHARLOTTE, NC 28202
704-336-2291

CHARLOTTE
ENGINEERING & PROPERTY MANAGEMENT DEPARTMENT

<p>REVISIONS</p>	<p>REA ROAD SIDEWALK & PEDESTRIAN SAFETY</p>	<p>JOB NO. PM51215033</p>
<p>SCALE 1" = 40'</p>	<p>PROPERTY OF NOW OR FORMERLY WHIT W. HOLT AND WIFE DIAN HOLT CHARLOTTE, MECKLENBURG CO., NC</p>	<p>FILE NO. 211-291-23</p>
<p>DRAWN BY LG</p>	<p>CHECKED BY JWB SURVEY SUPVR.</p>	<p>SHEET 1 OF 1</p>
<p>DATE</p>	<p>DATE</p>	<p>DATE</p>

K: \AutoCad\En_su-LD4\215033\dwg\ReaRoadSidewalkC3D2013.dwg

DB 32276-115