

38

RUTH HANNUM
DB 4792 PG 148
TM 211-331-23

37

STEPHEN GLENN STRICKER et ux
DB 4727 PG 900
TM 211-331-13
LOT 27, BLOCK B, SHADOWLAKE
MB 18 PG 232
TOTAL AREA 25747.33 S.F. 0.5911 Ac.(BY DEED)
AREA FEE SIMPLE 4.90 S.F. 0.0001 Ac.
TEMP. CONST. EASMT. 77.02 S.F. 0.0018 Ac.
RESIDUAL AREA 25742.43 S.F. 0.5910 Ac.(BY DEED)

35

SHERRY LYNN CLARK
DB7226 PG 630
TM 211-331-12

CHD BEAR S 76° 07' 24" E
CHD 53.94'
ARC 55.94'
RAD 60.00'

BEREA COURT

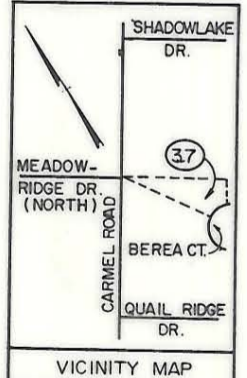

PREPARED BY:
TGS Engineers
Suite 203, North Building
Raleigh, North Carolina 27606
Phone (919)831-7144

(1) This plat was prepared under my supervision.
Leonard G. Fletcher Date: 5-8-95

N.C. Registered Land Surveyor No. L-2974

(2) This map was prepared for the purpose of acquiring fee simple, right-of-way and/or an easement only and is not intended to be a boundary survey of property shown.

		CHARLOTTE ENGINEERING DEPARTMENT	
		REVISIONS AUGUST 24, 1993	JOB NO. 512-88-123 FILE NO.
DRAWN BY <u>ELW</u> CHECKED BY <u>WEW</u>		CARMEL ROAD WIDENING PROJECT	
CITY ENGINEER		PROPERTY OF STEPHEN GLENN STRICKER et ux	
DATE JULY 8, 1993 SCALE 1" = 50'		SHEET 37 OF 137	