

PREPARED BY:
TGS Engineers
1215 Jones Franklin Road
Suite 203, North Building
Raleigh, North Carolina 27606
Phone (919)851-7144

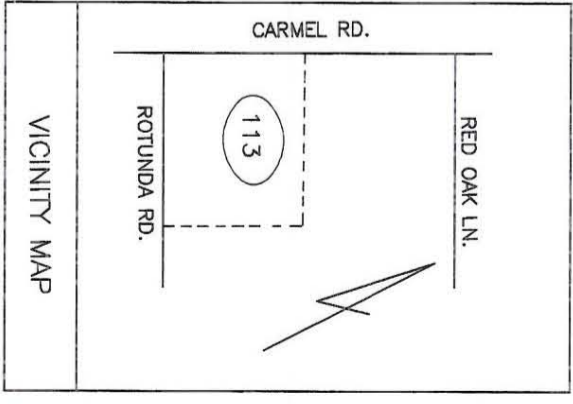

NAD 83

(1) This plat was prepared under my supervision.
Leonard G. Fletcher
N.C. Registered Survey No. L-2974 Date: 5-8-95

(2) This map was prepared for the purpose of acquiring fee simple right-of-way and/or an easement only and is not intended to be a boundary survey of property shown.

CHARLOTTE ENGINEERING DEPARTMENT		JOB NO. 512-88-	
REVISIONS		FILE NO.	
FEB. 25, 1994		123	
CARMEL ROAD WIDENING PROJECT		PROPERTY OF	
DRAWN BY ELW		ROBERT N. GRIER et ux	
CHECKED BY WEW		SHEET	
DATE APRIL 15, 1993		113	
SCALE 1"=50'		OF	
		137	

211-2972-01