

I, JACKIE W. BRIM, CERTIFY THAT THIS PLAT WAS PREPARED UNDER MY SUPERVISION AND THAT THE PLAT WAS PREPARED FOR THE PURPOSE OF EASEMENTS ONLY, AND IS NOT INTENDED TO BE A BOUNDARY SURVEY OF PROPERTY SHOWN.

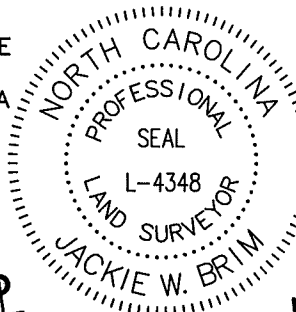

STATE OF NORTH CAROLINA  
COUNTY OF MECKLENBURG

\_\_\_\_\_, REVIEW OFFICER OF MECKLENBURG COUNTY, CERTIFY THAT THE MAP OR PLAT TO WHICH THIS CERTIFICATION IS AFFIXED MEETS ALL STATUTORY REQUIREMENTS FOR RECORDING.

*Jackie W. Brim* 10-17-2017  
 JACKIE W. BRIM, NC P.L.S. L-4348 DATE

REVIEW OFFICER \_\_\_\_\_ DATE \_\_\_\_\_

213-221-08  
MYRLE R HARKEY  
DB 12010 PG 681  
1300 Sardis Rd North

213-221-71  
SARDIS TRACE LLC  
MB 56 PG 975  
DB 28888 PG 193  
8848 Nolley Ct.

213-221-12  
NOW OR FORMERLY  
SARDIS FOREST SWIM CLUB INC.  
DB 4521 PG 254  
1415 Berry Ridge Rd.

COMBINED GRID  
FACTOR=0.9998449  
N: 508947.19  
E: 1479593.86

NOLLEY COURT  
(60' PUBLIC-RIGHT-OF-WAY)  
MB 49 PG 37

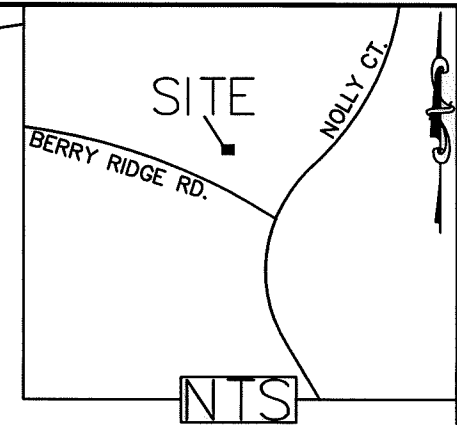

**LEGEND**

- IRON PIN FOUND ○
- CALCULATED POINT ●
- LINES SURVEYED ———
- LINES NOT SURVEYED - - - - -
- RIGHT-OF-WAY ——— R/W ———
- TEMP. CONSTRUCTION EASEMENT [Pattern]
- SIDEWALK UTILITY EASEMENT [Pattern]

Line Table		
Line #	Length	Direction
L1	19.71	S08°48'34"E
L2	4.20	S07°03'51"E
L3	21.82	N59°21'48"E
L4	22.74	N06°16'42"W
L5	47.27	N46°02'40"E
L6	48.84	N27°03'40"E
L7	24.83	N36°46'49"E
L8	123.56	S71°10'39"E
L9	21.88	S56°34'54"E
L10	8.72	S13°54'10"W

Line Table		
Line #	Length	Direction
L11	22.72	S07°03'51"E
L12	14.47	N37°03'16"E
L13	20.46	N15°22'32"E
L14	99.35	N33°44'19"E
L15	25.85	S38°18'24"W
L16	116.96	S38°18'24"W

Curve Table				
Curve #	Length	Radius	CHORD BEARING	CHORD
C1	20.15	18.62	N58°07'53"E	19.18
C2	26.39	20.00	N77°03'44"E	24.51
C3	146.64	286.56	N79°54'42"W	145.04

213-221-11  
SARDIS FOREST SWIM CLUB INC.  
DB 5671 PG 192  
Berry Ridge Rd.  
N71°2'27"W  
(N5°20'35"W 150.31')

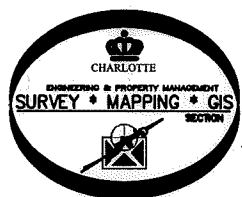

BERRY RIDGE RD. (PUBLIC-RIGHT-OF-WAY VARIES)  
 N65°12'27"W 29.72'  
 N63°20'35"W  
 N67°45'17"W 45.37'  
 N69°37'09"W  
 N72°41'36"W  
 N70°49'44"W 65.32'

- NOTE:
- BEARINGS AND DISTANCES SHOWN IN PARENTHESES ARE BASED ON RECORDED MAP INFORMATION.
  - TOTAL AREA 78,345 SQ. FT.
  - TEMP CONSTRUCTION EASEMENT 2,305 SQ. FT.
  - SIDEWALK UTILITY EASEMENT 720 SQ. FT.
  - AREA REMAINING 78,345 SQ. FT.

PREPARED BY:  
CITY OF CHARLOTTE  
ENGINEERING & PROPERTY  
MANAGEMENT DEPARTMENT  
600 EAST FOURTH STREET  
CHARLOTTE, NC 28202  
704-336-2291

**CHARLOTTE**  
ENGINEERING & PROPERTY MANAGEMENT DEPARTMENT

REVISIONS	Nolley Ct. Sidewalk Gap Project	JOB NO. 512-15-040
SCALE 1"=50'	PROPERTY OF NOW OR FORMERLY SARDIS FOREST SWIM CLUB INC. CHARLOTTE, MECKLENBURG CO., NC	215040
DRAWN BY P.S.		SHEET 1
DATE	SURVEY SUPVR.	OF 1