

I, DAVID H. SNIDER, CERTIFY THAT THIS PLAT WAS PREPARED UNDER MY SUPERVISION AND THAT THE PLAT WAS PREPARED FOR THE PURPOSE OF EASEMENTS ONLY, AND IS NOT INTENDED TO BE A BOUNDARY SURVEY OF PROPERTY SHOWN.

David H. Snider 12/22/14
 DAVID H. SNIDER, NC P.L.S. L-2942 DATE

State of North Carolina
 County of Mecklenburg

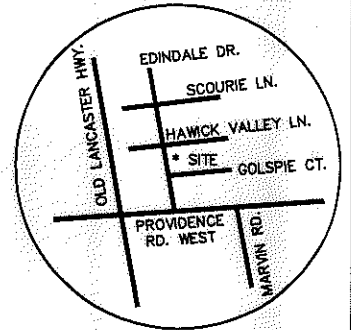
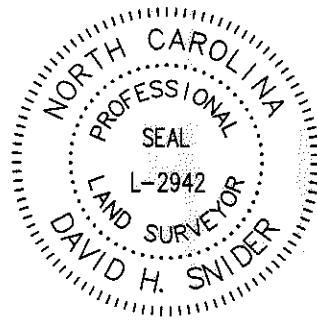

VICINITY MAP
 not to scale

I, _____, Review Officer of Mecklenburg County, certify that the map or plat to which this certification is affixed meets all statutory requirements for recording.

Review Officer _____ Date _____

NOTES:

- 1) BEARINGS AND DISTANCES SHOWN IN PARENTHESES ARE BASED ON RECORDED MAP INFORMATION.
- 2) TOTAL AREA 6,451 SQ.FT.
- 3) STORM DRAINAGE EASEMENT 589 SQ.FT.
- 4) TEMPORARY CONSTRUCTION EASEMENT 526 SQ.FT.
- 5) PUBLIC DRAINAGE EASEMENT TO BE ACCEPTED AS SDE 238 SQ.FT.
- 6) AREA REMAINING 6,451 SQ.FT.

223-136-64
 ABBIE BURHANS
 DB 28315-134
 15111 EDINDALE DR.

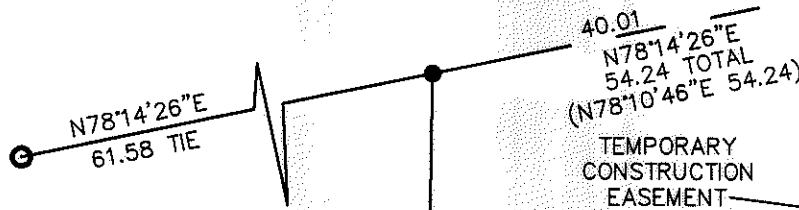

223-136-65
 JAY T. DY
 DB 24109-670
 11842 GOLSPIE CT.

(N0°30'54"E 106.40)
 N0°34'34"E
 106.40

223-136-66
 CAROL A. WISE
 DB 10248-909
 11836 GOLSPIE CT.

223-136-67
 BETTY BELMONTE
 DB 22521-593
 11830 GOLSPIE CT.

(R= 830.00, L= 68.31)
 (CH= N79°07'48"E 68.29)
 C1 TOTAL
 C4

GOLSPIE CT.
 40' PUBLIC R/W

STORM DRAINAGE EASEMENT

#5 REBAR
 N 475158.57
 E 1443476.61

CITY CONTROL POINT
 PK NAIL
 N 475130.85
 E 1443483.34
 CGF 0.999853345

NC GRID NAD 83
 (2011)

LEGEND

- PROPERTY CORNER FOUND
- CONTROL POINT PK NAIL
- CALCULATED POINT
- LINE SURVEYED
- LINE NOT SURVEYED
- STORM DRAINAGE EASEMENT
- TEMPORARY CONSTRUCTION EASEMENT

PREPARED BY:
 CITY OF CHARLOTTE
 ENGINEERING & PROPERTY MANAGEMENT
 600 EAST FOURTH STREET
 CHARLOTTE, NC 28208
 704-336-2291

CHARLOTTE		ENGINEERING & PROPERTY MANAGEMENT DEPARTMENT	
REVISIONS		11836 GOLSPIE COURT	
		STORM WATER MAINTENANCE IMPROVEMENT PROJECT	
		OWNER: CAROL A. WISE 223-136-66	
		DRAWN BY JBB CHARLOTTE, MECKLENBURG CO., NC	
DATE:		CHECKED BY GAI SURVEY SUPVR. <i>DH</i>	
P: SURPROJ\SWATER\MAINT\EDINDALE\15111\PARCEL 6.DWG			

ACQUISITION BY DB 29731 37