

Certificate of Survey and Accuracy
State of North Carolina, Mecklenburg County

I, E. Donald Lawrence, certify that this map was drawn under my supervision from a survey made under my supervision; (Dead Description recorded in references as shown hereon); that the boundaries not surveyed are clearly indicated as drawn from information as shown hereon; that the positional accuracy does not exceed 0.10' at the 95% confidence level; this map was prepared in accordance with G.S. 47-30(m) as amended; and that the survey is of another category, such as the recombination of existing parcels, a court-ordered survey, or other exemption or exception to the definition of subdivision. Witness my hand and seal this day of FALL, 2018

Witness my hand and seal this 17 day of Aug, 2018

E. Donald Lawrence
F. Donald Lawrence, NORLS L-1290

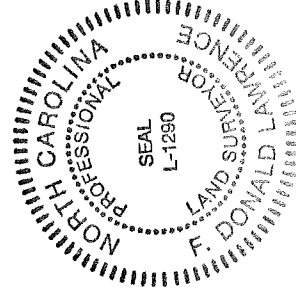

State of North Carolina County of Mecklenburg
I, F. Donald Lawrence, Review Officer of Mecklenburg County,
certify that the map or plat to which this certification is affixed
meets all statutory requirements for recording.

Review Officer _____ Date _____

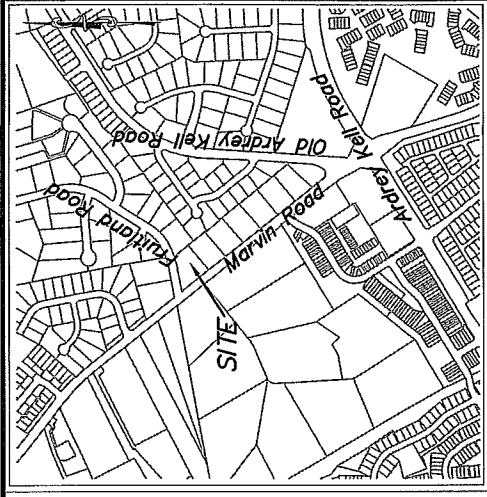

Vicinity Map (NTS)

N/F
223-271-41
ERIK GARRETT AND WIFE KAREN
DB.29972/PG.952
MB.16/PG.311
10921 FRUITLAND RD.

N38°22'45"W 127.80'
(N40°03'59"W 127.76')

NC GRID
NORTHING 471059.97
EASTING 1449003.51

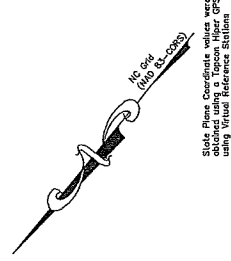

S78°08'51"W 259.31'
(S77°24'15"W 259.14')

N/F
223-271-45
ROBERT GORMICAN
AND CATHLEEN LEONARD
DB.17688/PG.75
MB.16/PG.311
16425 MARVIN ROAD

N/F
223-271-46
JOHN AND TAMARA BRANDT
DB. 29080/PG. 910
MB.19/PG.179
16501 MARVIN ROAD

S51°48'58"W 233.01'
(S50°16'15"W 233.01')

S38°08'34"E 242.82'
(S39°43'45"E 242.84')

60' R/W
MB.16/PG.311

SEE SHEET 2

Marvin Road
SR #3635 - Variable Width
Public Right-of-Way

LEGEND

- NW
- CITY TP PK NAIL
- REBAR OR IRON PIPE FOUND
- CALCULATED POINT
- LINES SURVEYED
- LINES NOT SURVEYED
- TEMPORARY CONSTRUCTION EASEMENT
- SIDEWALK AND UTILITY EASEMENT

LAWRENCE ASSOCIATES
106 W. Jefferson St.
Monroe, North Carolina 28112
P 704-283-9035
www.lawrencesurveying.com
Firm License Number: C-2856



CHARLOTTE

ENGINEERING & PROPERTY MANAGEMENT DEPARTMENT

REVISIONS	MARVIN ROAD SIDEWALK PROJECT NO. PMES171509	JOB NO. 3825/4445
9-12-18 WML		FILE NO.
10-17-18 WML		18/117h
SCALE 1" = 50'	OWNER: ROBERT GORMICAN AND CATHLEEN LEONARD CHARLOTTE, MECKLENBURG CO., NC	SHEET 1 OF 2
DRAWN BY WML	CHECKED BY CDL	SURVEY SUPVR. FDL

DB 33378-043

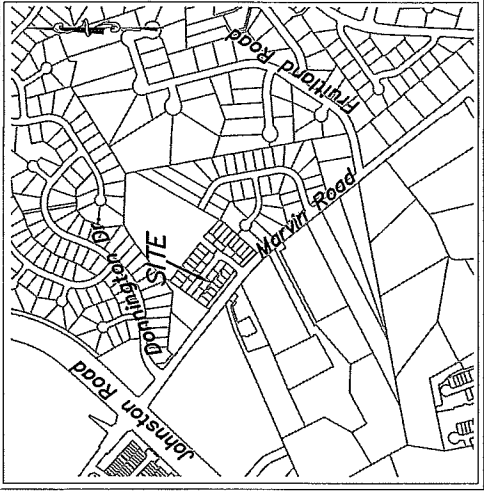

Vicinity Map (NTS)

Line Table		
Line #	Length	Direction
L1	21.19	N78°08'51"E
L2	204.40	S38°11'53"E
L3	19.00	N51°48'07"E
L4	28.96	S38°11'53"E
L5	28.04	S51°43'32"W
L6	10.18	S51°43'40"W
L7	225.39	N38°08'15"W
L8	193.30	N38°11'08"W
L9	17.42	N38°12'39"W

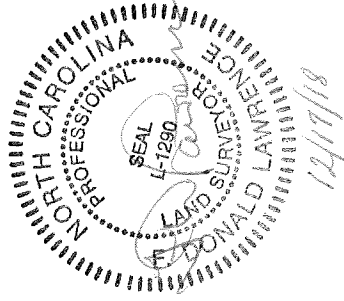

(B) N/F
 223-271-45
ROBERT GORMICAN
AND CATHLEEN LEONARD
 DB.17688/PG.75
 MB.16/PG.311
 16425 MARVIN ROAD

Fruitland Road
 60' R/W
 MB.16/PG.311

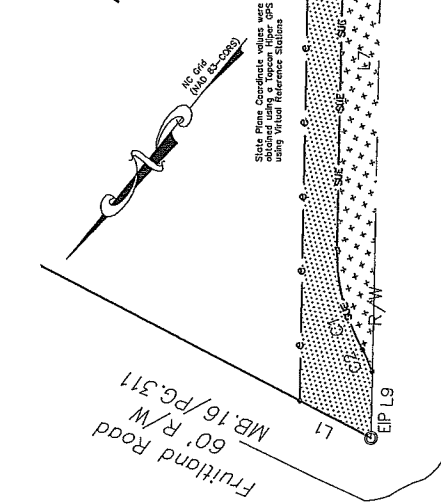

(9) N/F
 223-271-46
JOHN AND TAMARA BRANDT
 DB. 29080/PG. 910
 MB.19/PG.179
 16501 MARVIN ROAD

Marvin Road
 SR #3635 - Variable Width
 Public Right-of-Way

- NOTES:
 1. BEARINGS AND DISTANCES SHOWN IN PARENTHESES ARE BASED ON RECORDED INFORMATION, DEED BOOK 17688 PAGE 75
 2. TOTAL AREA 42078 SQ.FT.
 3. SIDEWALK AND UTILITY EASEMENT 2163 SQ.FT.
 4. TEMPORARY CONSTRUCTION EASEMENT 2934 SQ.FT.
 5. AREA REMAINING 42078 SQ.FT.

LEGEND

- NW OR FORMERLY
- CITY TP PK NAIL
- REBAR OR IRON PIPE FOUND
- CALCULATED POINT
- LINES SURVEYED
- LINES NOT SURVEYED
- TEMPORARY CONSTRUCTION EASEMENT
- SIDEWALK AND UTILITY EASEMENT

- NF
- ⊗
- ⊙EIP
- ⊙CP

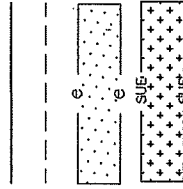

Curve Table				
Curve #	Length	Radius	CHORD BEARING	CHORD
C1	27.67	52.00	N53°26'38"W	27.35
C2	6.35	42.00	S64°21'28"E	6.35



CHARLOTTE

ENGINEERING & PROPERTY MANAGEMENT DEPARTMENT

REVISIONS
 9-12-18 WML
 10-17-18 WML

JOB NO.
 3825/4445
 FILE NO.
 18/117h

SCALE
 1"=50'
 DRAWN BY
 WML

OWNER:
ROBERT GORMICAN
AND CATHLEEN LEONARD
 CHARLOTTE, MECKLENBURG CO., NC

CHECKED BY
 CDL SURVEY SUPERV. FDL
 SHEET
 2 OF
 2

LAWRENCE ASSOCIATES

106 W. Jefferson St.
 Monroe, North Carolina, 28112
 P. 704-285-1013
 F. 704-285-9035
 www.lawrencesurveying.com
 Firm License Number: C-2856